



ADJUDICATION RECORD
PURSUANT TO SECTION 8A (1) (e) and 8A (1) (g) OF THE
REGISTRATION OF TITLES CADASTRAL MAPPING AND TENURE CLARIFICATION (SPECIAL PROVISIONS) ACT

SYSTEMATIC ADJUDICATION AREA : PARTS OF QUEENSBURY, ST. ELIZABETH

APPLICATION NO.	LAND INFORMATION									PERSONAL DETAILS			OCCUPANCY DETAILS							
	CADASTRAL MAP NUMBER	CADASTRAL MAP PARCEL NUMBER	LAND VALUATION NUMBER	AREA	PLACE	PARISH	VOLUME/FOLIO	PROPERTY ADDRESS	NATURE OF PARCEL	OWNER(S) DETAILS	NATURE BY WHICH LAND WAS ACQUIRED	NATURE OF OWNER DISBAILITY	NAME, ADDRESS AND OCCUPATION OF GUARDIAN	NATURE OF TITLE	DETAILS OF ENCUMBRANCES	RESTRICTIONS ON POWER TO DEAL WITH LAND	DETAILS OF PERSON ENTITLED TO BENEFIT OF RESTRICTION	DOCUMENTS PRESENTED	DATE OF COMPLETION OF APPLICATION FORM	
ASD003319	CM1152080-502	115208001		3492.0 Square Meter	QUEENSBURY	St. Elizabeth		Queensbury District, St. Elizabeth	Private	- Wavel Stivle Myers Retired Mechanic of 2 Darrach Close, Coventry West Midlands United Kingdom	Possession			Absolute					2021-06-22	
ASD003318	CM1152080-502	115208002		3808.0 Square Meter	QUEENSBURY	St. Elizabeth		Queensbury District, St. Elizabeth	Private	- Wavel Stivle Myers Retired Mechanic of 2 Darrach Close, Coventry West Midlands United Kingdom	Possession			Absolute						2021-06-22
ASD003321	CM1152081-503	115208003		2592.0 Square Meter	QUEENSBURY	St. Elizabeth		Queensbury District, St. Elizabeth	Private	- Cheryl Maria O'Connor-Myers Customer Service Representative of Lot 5 Fern Grove, Ocho Rios P.O. St. Ann Jamaica - Breyontae Rosakay Myers Student born on February 4, 2012 of Lot 5 Fern Grove, Ocho Rios P.O. St. Ann Jamaica - Aaron James Myers Student born on August 1, 2017 of Lot 5 Fern Grove, Ocho Rios P.O. St. Ann Jamaica	Inheritance			Absolute				- Grant of Administration : Grant of Administration - Death Certificate - Marriage Certificate		2021-06-09
ASD003311	CM1152080-502	115208004		2437.0 Square Meter	QUEENSBURY	St. Elizabeth		Queensbury District, St. Elizabeth	Private	- Christneive Oniel Myers Alias Chris Farmer and Construction Worker of Queensbury District, Southfield P.O. St. Elizabeth Jamaica	Possession			Absolute						2021-06-09
ASD003314	CM1152080-502	115208005		4611.0 Square Meter	QUEENSBURY	St. Elizabeth		Queensbury District, St. Elizabeth	Private	- Denham Roye Myers Retired Farmer of Queensbury District, Southfield P.O. St. Elizabeth Jamaica	Inheritance			Absolute						2021-06-09
ASD003313	CM1152080-502	115208006		6443.0 Square Meter	QUEENSBURY	St. Elizabeth		Queensbury District, St. Elizabeth	Private	- Franz Secou Myers System Administrator of 38 Greenvale Road Mandeville P.O. Manchester Jamaica - Sarah Ann Myers Sales Representative of 38 Greenvale Road Mandeville P.O. Manchester Jamaica	Inheritance			Absolute						2021-06-09
ASD003315	CM1152080-502	115208007		3913.0 Square Meter	QUEENSBURY	St. Elizabeth		Queensbury District, St. Elizabeth	Private	- Denham Roye Myers Retired Farmer of Queensbury District Southfield P.O. St. Elizabeth Jamaica	Inheritance			Absolute				- Affidavits/ Statutory Declaration(s)		2021-06-09
ASD003310	CM1152080-502	115208008		3695.0 Square Meter	QUEENSBURY	St. Elizabeth		Queensbury District, St. Elizabeth	Private	- Edward Vanambury Myers Alias Corporal Farmer of Queensbury District, Southfield P.O. St. Elizabeth Jamaica	Inheritance			Absolute				- Certificate of Title Registered- Volume: 988 Folio: 533 - Property Tax Receipts		2021-06-09
ASD003317	CM1152080-502	115208009		693.0 Square Meter	QUEENSBURY	St. Elizabeth		Queensbury District, St. Elizabeth	Private	- Eric George Farquharson Alias Ricky Police Officer of Dean Pen District Highgate P.O. St. Mary Jamaica	Possession			Absolute						2021-06-09
ASD003316	CM1152080-502	115208010		527.0 Square Meter	QUEENSBURY	St. Elizabeth		Queensbury District, St. Elizabeth	Private	- Delores Merinda Foster Gordon Farmer of Queensbury District Southfield P.O. St. Elizabeth Jamaica	Purchase			Absolute						2021-06-09
ASD003312	CM1152080-502	115208011		3465.0 Square Meter	QUEENSBURY	St. Elizabeth		Queensbury District, St. Elizabeth	Private	- Hyacinth Masie Lowe Alias Ms. Hya Farmer of Queensbury District, Southfield P.O. St. Elizabeth Jamaica	Possession			Absolute						2021-06-09
ASD003332	CM1152081-503	115208104		1452.0 Square Meter	QUEENSBURY	St. Elizabeth		Queensbury District, St. Elizabeth	Private	- Tanice Stacy-ann Maitland-King Alias Tanice Retired farm worker of Lot 154 Llandilo Housing Scheme Savanna-la-Mar P.O. Westmoreland Jamaica - Kaymaureen Tiffany Maitland Alias Kay Retired farm worker of Sheffield District Sheffield P.O. St. Elizabeth Jamaica	Possession			Absolute				- Survey Plan Examination No. : agreement for sale		2021-06-18



ADJUDICATION RECORD
PURSUANT TO SECTION 8A (1) (e) and 8A (1) (g) OF THE
REGISTRATION OF TITLES CADASTRAL MAPPING AND TENURE CLARIFICATION (SPECIAL PROVISIONS) ACT

SYSTEMATIC ADJUDICATION AREA : PARTS OF QUEENSBURY, ST. ELIZABETH

APPLICATION NO.	LAND INFORMATION									PERSONAL DETAILS			OCCUPANCY DETAILS						
	CADASTRAL MAP NUMBER	CADASTRAL MAP PARCEL NUMBER	LAND VALUATION NUMBER	AREA	PLACE	PARISH	VOLUME/FOLIO	PROPERTY ADDRESS	NATURE OF PARCEL	OWNER(S) DETAILS	NATURE BY WHICH LAND WAS ACQUIRED	NATURE OF OWNER DISBAILITY	NAME, ADDRESS AND OCCUPATION OF GUARDIAN	NATURE OF TITLE	DETAILS OF ENCUMBRANCES	RESTRICTIONS ON POWER TO DEAL WITH LAND	DETAILS OF PERSON ENTITLED TO BENEFIT OF RESTRICTION	DOCUMENTS PRESENTED	DATE OF COMPLETION OF APPLICATION FORM
ASD003380	CM1152081-503	115208105		1708.0 Square Meter	QUEENSBURY	St. Elizabeth		Queensbury District, St. Elizabeth	Private	Jason Adrian Harrison retired farmworker of 600 Kent Lane, Apt 15C, Myrtle Beach, South Carolina 29579, United States of America	Possession			Qualified					2021-06-20
ASD003328	CM1152081-503	115208108		1758.0 Square Meter	QUEENSBURY	St. Elizabeth		Queensbury District, St. Elizabeth	Private	- Stephen Andrew Bent Farmer of Queensbury District Southfield P.O. St. Elizabeth Jamaica	Inheritance			Absolute					2021-06-09
ASD003326	CM1152081-503	115208109		1227.0 Square Meter	QUEENSBURY	St. Elizabeth		Queensbury District, St. Elizabeth	Private	- Sharett Alana Harrison Alias Bengay Domestic Worker of Queensbury District Southfield P.O. St. Elizabeth Jamaica	Possession			Absolute					2021-06-09
ASD003336	CM1152081-503	115208110		1333.0 Square Meter	QUEENSBURY	St. Elizabeth		Queensbury District, St. Elizabeth	Private	- Jillian Rose Bent Farmer of Queensbury District Southfield P.O. St. Elizabeth Jamaica	Possession			Absolute					2021-06-19
ASD003379	CM1152081-503	115208111		1130.0 Square Meter	QUEENSBURY	St. Elizabeth		Queensbury District, St. Elizabeth	Private	- Lennox Harrison Alias Lasco Farmer of Queensbury District, Southfield P.O. St. Elizabeth Jamaica				Absolute					2021-06-20
ASD003331	CM1152081-503	115208112		1360.0 Square Meter	QUEENSBURY	St. Elizabeth		Queensbury District, St. Elizabeth	Crown	- Commissioner of Lands A Corporation Sole established and existing under and by virtue of the provisions of the Crown Property (Vesting) Act of 20 North Street Kingston Jamaica	Special Provisions Act			Absolute					2021-06-18
ASD003337	CM1152081-503	115208114		3639.0 Square Meter	QUEENSBURY	St. Elizabeth		Queensbury District, St. Elizabeth	Private	- Cheryl Maria O'Connor-Myers Customer Service Representative of Lot 5 Fern Grove, Ocho Rios P.O. St. Ann Jamaica - Breyontae Rosakay Myers Student born on February 4, 2012 of Lot 5 Fern Grove, Ocho Rios P.O. St. Ann Jamaica - Aaron James Myers Student born on August 1, 2017 of Lot 5 Fern Grove, Ocho Rios P.O. St. Ann Jamaica	Inheritance			Absolute			- Property Tax Receipts - Grant of Administration : Ernesto Myers - Death Certificate - Marriage Certificate		2021-06-19
ASD003327	CM1152081-503	115208115		4350.0 Square Meter	QUEENSBURY	St. Elizabeth		Queensbury District, St. Elizabeth	Private	- Henry Boothe Buchanan Farmer of Queensbury District Southfield P.O. St. Elizabeth Jamaica	Possession			Absolute					2021-06-09
ASD003330	CM1152081-503	115208116		1214.0 Square Meter	QUEENSBURY	St. Elizabeth		Queensbury District, St. Elizabeth	Private	- Oral Dave Palmer Alias Nutsy Farmer of Queensbury District Southfield P.O. St. Elizabeth Jamaica	Purchase			Absolute			- Survey Plan Examination No. : indenture, birth certificate		2021-06-10
ASD003334	CM1152081-503	115208117		1474.0 Square Meter	QUEENSBURY	St. Elizabeth		Queensbury District, St. Elizabeth	Private	- Ellen Gordon Farmer of Queensbury District, Southfield P.O. St. Elizabeth Jamaica	Inheritance			Absolute			- Property Tax Receipts - Last Will and Testament of : Sydney Reid		2021-06-19
ASD003335	CM1152081-503	115208118		12227.0 Square Meter	QUEENSBURY	St. Elizabeth		Queensbury District, St. Elizabeth	Private	- Nancy Shereena Reid Farmer of Queensbury District Southfield P.O. St. Elizabeth Jamaica	Inheritance			Absolute			- Property Tax Receipts - Last Will and Testament of : Sydney Reid		2021-06-19
ASD003320	CM1152081-503	115208119		15996.0 Square Meter	QUEENSBURY	St. Elizabeth		Queensbury District, St. Elizabeth	Private	- Sharalee Karen Bent Farmer of Queensbury District Southfield P.O. St. Elizabeth Jamaica	Inheritance			Absolute			- Survey Plan Examination No. : birth certificate, property tax receipts, other		2021-06-09
ASD003333	CM1152081-503	115208120		2977.0 Square Meter	QUEENSBURY	St. Elizabeth		Queensbury District, St. Elizabeth	Private	- TriciaAnn Nicole McLean Rowe Senior Director of 3 Brumalia Gardens Mandeville P.O. St. Elizabeth Jamaica	Possession			Absolute			- Death Certificate		2021-06-19



ADJUDICATION RECORD
PURSUANT TO SECTION 8A (1) (e) and 8A (1) (g) OF THE
REGISTRATION OF TITLES CADASTRAL MAPPING AND TENURE CLARIFICATION (SPECIAL PROVISIONS) ACT

SYSTEMATIC ADJUDICATION AREA : PARTS OF QUEENSBURY, ST. ELIZABETH

APPLICATION NO.	LAND INFORMATION									PERSONAL DETAILS			OCCUPANCY DETAILS						
	CADASTRAL MAP NUMBER	CADASTRAL MAP PARCEL NUMBER	LAND VALUATION NUMBER	AREA	PLACE	PARISH	VOLUME/FOLIO	PROPERTY ADDRESS	NATURE OF PARCEL	OWNER(S) DETAILS	NATURE BY WHICH LAND WAS ACQUIRED	NATURE OF OWNER DISBAILITY	NAME, ADDRESS AND OCCUPATION OF GUARDIAN	NATURE OF TITLE	DETAILS OF ENCUMBRANCES	RESTRICTIONS ON POWER TO DEAL WITH LAND	DETAILS OF PERSON ENTITLED TO BENEFIT OF RESTRICTION	DOCUMENTS PRESENTED	DATE OF COMPLETION OF APPLICATION FORM
ASD003325	CM1152081-503	115208121		1037.0 Square Meter	QUEENSBURY	St. Elizabeth		Queensbury District, St. Elizabeth	Private	- Urian Glenford Robinson Alias ToePaul Farmer of Queensbury District Southfield P.O. St. Elizabeth Jamaica	Possession			Absolute					2021-06-09
ASD003324	CM1152081-503	115208122		935.0 Square Meter	QUEENSBURY	St. Elizabeth		Queensbury District, St. Elizabeth	Private	- ANDREW JUAN ABRAMS ELECTRICIAN of Queensbury District Southfield P.O. St. Elizabeth Jamaica	Possession			Absolute					2021-06-09
ASD003329	CM1152081-503	115208123		2904.0 Square Meter	QUEENSBURY	St. Elizabeth		Queensbury District, St. Elizabeth	Private	- Nathan Millings Alias Specey Farmer of Queensbury District Southfield P.O. St. Elizabeth Jamaica - Boswell Millings Alias Boswell Farmer of Queensbury District Southfield P.O St. Elizabeth Jamaica	Inheritance			Absolute					2021-06-10
ASD003339	CM1152081-503	115208124		2558.0 Square Meter	QUEENSBURY	St. Elizabeth		Queensbury District, St. Elizabeth	Crown	- Commissioner of Lands A Corporation Sole established and existing under and by virtue of the provisions of the Crown Property (Vesting) Act of 20 North Street Kingston Jamaica	Special Provisions Act			Absolute					2021-06-21
ASD003340	CM1152081-503	115208125		357.0 Square Meter	QUEENSBURY	St. Elizabeth		Queensbury District, St. Elizabeth	Private	- SILBERT WAYNE MORGAN Alias Wayne Morgan Airport Manager of 42607 Smokey Embers Terrace Sterling Virginia United States	Possession			Absolute			- Survey Plan Examination No. : PE 302050		2021-06-09
ASD003352	CM1152082-508	115208201		13616.0 Square Meter	QUEENSBURY	St. Elizabeth		Queensbury District, St. Elizabeth	Private	- Paulette Miller Alias Pee Farmer of Queensbury District, Southfield P.O. St. Elizabeth Jamaica	Inheritance			Qualified			- Death Certificate		2021-06-09
ASD003357	CM1152082-508	115208202		2609.0 Square Meter	QUEENSBURY	St. Elizabeth		Queensbury District, St. Elizabeth	Private	- Charles Miller Farmer of Queensbury District, Southfield P.O. St. Elizabeth Jamaica	Purchase			Absolute			- Property Tax Receipts		2021-06-09
ASD003806	CM1152082-508	115208204	FALSE	4281.0 Square Meter	QUEENSBURY	St. Elizabeth		Queensbury District, St. Elizabeth	Crown	- Commissioner of Lands A Corporation Sole established and existing under and by virtue of the provisions of the Crown Property (Vesting) Act of 20 North Street Kingston Jamaica	Special Provisions Act			Absolute					2021-07-22
ASD003343	CM1152082-508	115208205		1537.0 Square Meter	QUEENSBURY	St. Elizabeth		Queensbury District, St. Elizabeth	Private	- Juliet Erica Powell Housewife of Queensbury District, Southfield P.O. St. Elizabeth Jamaica - David Nathaniel Powell Farmer of Queensbury District Southfield P.O. St. Elizabeth Jamaica	Possession			Absolute			- Marriage Certificate		2021-06-09
ASD003345	CM1152082-508	115208206		15444.0 Square Meter	QUEENSBURY	St. Elizabeth		Queensbury District, St. Elizabeth	Private	- Hyacinth Masie Lowe Alias Ms. Hya Farmer of Queensbury District, Southfield P.O. St. Elizabeth Jamaica	Possession			Absolute					2021-06-09
ASD003808	CM1152082-508	115208207	FALSE	3202.0 Square Meter	QUEENSBURY	St. Elizabeth		Queensbury District, St. Elizabeth	Crown	- Commissioner of Lands A Corporation Sole established and existing under and by virtue of the provisions of the Crown Property (Vesting) Act of 20 North Street Kingston Jamaica	Special Provisions Act			Absolute					2021-07-23
ASD003341	CM1152082-508	115208208		2322.0 Square Meter	QUEENSBURY	St. Elizabeth		Queensbury District, St. Elizabeth	Private	- Silbert Wayne Morgan Manager of 42607 Smokey Embers Terrace Sterling Virginia United States	Possession			Absolute					2021-06-09
ASD003322	CM1152081-503	115208209		1990.0 Square Meter	QUEENSBURY	St. Elizabeth		Queensbury District, St. Elizabeth	Private	- Silbert Wayne Morgan Manager of 42607 Smokey Embers Terrace Sterling Virginia United States	Purchase			Absolute			- Survey Plan Examination No. : indenture		2021-06-09
ASD003355	CM1152082-508	115208210		1228.0 Square Meter	QUEENSBURY	St. Elizabeth		Queensbury District, St. Elizabeth	Private	- Barrington Lowe Farmer of Queensbury District, Southfield P.O. St. Elizabeth Jamaica	Possession			Absolute			- Utility Bills		2021-06-09



ADJUDICATION RECORD
PURSUANT TO SECTION 8A (1) (e) and 8A (1) (g) OF THE
REGISTRATION OF TITLES CADASTRAL MAPPING AND TENURE CLARIFICATION (SPECIAL PROVISIONS) ACT

SYSTEMATIC ADJUDICATION AREA : PARTS OF QUEENSBURY, ST. ELIZABETH

APPLICATION NO.	LAND INFORMATION									PERSONAL DETAILS			OCCUPANCY DETAILS						
	CADASTRAL MAP NUMBER	CADASTRAL MAP PARCEL NUMBER	LAND VALUATION NUMBER	AREA	PLACE	PARISH	VOLUME/FOLIO	PROPERTY ADDRESS	NATURE OF PARCEL	OWNER(S) DETAILS	NATURE BY WHICH LAND WAS ACQUIRED	NATURE OF OWNER DISABILITY	NAME, ADDRESS AND OCCUPATION OF GUARDIAN	NATURE OF TITLE	DETAILS OF ENCUMBRANCES	RESTRICTIONS ON POWER TO DEAL WITH LAND	DETAILS OF PERSON ENTITLED TO BENEFIT OF RESTRICTION	DOCUMENTS PRESENTED	DATE OF COMPLETION OF APPLICATION FORM
ASD003356	CM1152082-508	115208211		2083.0 Square Meter	QUEENSBURY	St. Elizabeth		Queensbury District, St. Elizabeth	Private	- Barrington Lowe Farmer of Queensbury District, Southfield P.O. St. Elizabeth Jamaica	Possession			Absolute			- Survey Plan Examination No. : utility bills		2021-06-09
ASD003378	CM1152082-508	115208212		2174.0 Square Meter	QUEENSBURY	St. Elizabeth		Queensbury District, St. Elizabeth	Private	- Eurina Deweger Thompson Alias Pam Domestic helper of 16 Dee Cee Avenue, Kingston 14 St. Andrew Jamaica	Inheritance			Qualified					2021-06-19
ASD003370	CM1152082-508	115208213		540.0 Square Meter	QUEENSBURY	St. Elizabeth		Queensbury District, St. Elizabeth	Private	- Tanice Maitland Settlement Officer of Queensbury District, Southfield P.O. St. Elizabeth Jamaica - Kaymaureen Maitland Data Clerk of Sheffield District, Sheffield P.O. Westmoreland Jamaica	Possession			Absolute					2021-06-10
ASD003366	CM1152082-508	115208214		1177.0 Square Meter	QUEENSBURY	St. Elizabeth		Queensbury District, St. Elizabeth	Private	- Devon Lowe Production worker of Bethel Street Greenvale, Mandeville P.O. St. Elizabeth Jamaica	Possession			Absolute					2021-06-10
ASD003351	CM1152082-508	115208215		1572.0 Square Meter	QUEENSBURY	St. Elizabeth		Queensbury District, St. Elizabeth	Private	- Oneil Harrison Driver of Queensbury District Southfield P.O. St. Elizabeth Jamaica	Possession			Absolute					2021-06-09
ASD003344	CM1152082-508	115208217		26636.0 Square Meter	QUEENSBURY	St. Elizabeth		Queensbury District, St. Elizabeth	Private	- Dahlia Nathalie Falconer Alias Brownin Farmer of Queensbury District Southfield P.O. St. Elizabeth Jamaica	Inheritance			Absolute			- Birth Certificate		2021-06-09
ASD003374	CM1152082-508	115208219		2379.0 Square Meter	QUEENSBURY	St. Elizabeth		Queensbury District, St. Elizabeth	Private	- Simeon Falconer Alias Bummer Farmer of Queensbury District, Southfield P.O. St. Elizabeth Jamaica	Possession			Absolute					2021-06-15
ASD003375	CM1152082-508	115208221		1392.0 Square Meter	QUEENSBURY	St. Elizabeth		Queensbury District, St. Elizabeth	Private	- Tricia Anne Nicole McLean Rowe Senior Director- ICT of 3 Brumalia Gardens, Mandeville P.O. St. Elizabeth Jamaica	Gift			Absolute					2021-06-15
ASD003373	CM1152082-508	115208222		771.0 Square Meter	QUEENSBURY	St. Elizabeth		Queensbury District, St. Elizabeth	Private	- Colin Livingstone Swaby Retired Police Officer of Queensbury District, Southfield P.O. St. Elizabeth Jamaica	Possession			Absolute			- Receipt		2021-06-15
ASD003372	CM1152082-508	115208223		887.0 Square Meter	QUEENSBURY	St. Elizabeth		Queensbury District, St. Elizabeth	Private	- Velma Pearl Falconer Alias Pearl Farmer of Queensbury District, Southfield P.O. St. Elizabeth Jamaica - Dale Evangeline Falconer Farmer of Queensbury District, Southfield P.O. St. Elizabeth Jamaica - Mary Falconer Farmer of Queensbury District, Southfield P.O. St. Elizabeth Jamaica	Inheritance			Absolute					2021-06-15
ASD003367	CM1152082-508	115208225		575.0 Square Meter	QUEENSBURY	St. Elizabeth		Queensbury District, St. Elizabeth	Private	- Ainsworth Simmons Falconer Alias John Bull Farmer of Queensbury District, Southfield P.O. St. Elizabeth Jamaica	Possession			Absolute					2021-06-10
ASD003363	CM1152082-508	115208226		2354.0 Square Meter	QUEENSBURY	St. Elizabeth		Queensbury District, St. Elizabeth	Private	- Veron Reid Alias Cabbie Farmer of Queensbury District, Southfield P.O. St. Elizabeth Jamaica	Possession			Absolute					2021-06-09
ASD003364	CM1152082-508	115208228		215.0 Square Meter	QUEENSBURY	St. Elizabeth		Queensbury District, St. Elizabeth	Private	- Lorna Varanicka Bent Retiree of Southfield District, Southfield P.O. St. Elizabeth Jamaica	Inheritance			Absolute					2021-06-09



ADJUDICATION RECORD
PURSUANT TO SECTION 8A (1) (e) and 8A (1) (g) OF THE
REGISTRATION OF TITLES CADASTRAL MAPPING AND TENURE CLARIFICATION (SPECIAL PROVISIONS) ACT

SYSTEMATIC ADJUDICATION AREA : PARTS OF QUEENSBURY, ST. ELIZABETH

APPLICATION NO.	LAND INFORMATION									PERSONAL DETAILS			OCCUPANCY DETAILS						
	CADASTRAL MAP NUMBER	CADASTRAL MAP PARCEL NUMBER	LAND VALUATION NUMBER	AREA	PLACE	PARISH	VOLUME/FOLIO	PROPERTY ADDRESS	NATURE OF PARCEL	OWNER(S) DETAILS	NATURE BY WHICH LAND WAS ACQUIRED	NATURE OF OWNER DISBAILITY	NAME, ADDRESS AND OCCUPATION OF GUARDIAN	NATURE OF TITLE	DETAILS OF ENCUMBRANCES	RESTRICTIONS ON POWER TO DEAL WITH LAND	DETAILS OF PERSON ENTITLED TO BENEFIT OF RESTRICTION	DOCUMENTS PRESENTED	DATE OF COMPLETION OF APPLICATION FORM
ASD003381	CM1152082-508	115208229		631.0 Square Meter	QUEENSBURY	St. Elizabeth		Queensbury District, St. Elizabeth	Private	- Coral Ismay Clarke-Trenchfield Retired Farmer of Crossroads District, Treasure Beach P.O. Treasure Beach P.O. St. Elizabeth Jamaica	Possession			Absolute					2021-06-21
ASD003342	CM1152082-508	115208230		746.0 Square Meter	QUEENSBURY	St. Elizabeth		Queensbury District, St. Elizabeth	Private	- Althea Edmay Clarke Dressmaker of Queensbury District, Southfield P.O. St. Elizabeth Jamaica	Possession			Absolute			- Birth Certificate		2021-06-09
ASD003382	CM1152082-508	115208231		844.0 Square Meter	QUEENSBURY	St. Elizabeth		Queensbury District, St. Elizabeth	Private	- Jason Clarke Farmer of Queensbury District, Southfield P.O. St. Elizabeth Jamaica	Inheritance			Qualified					2021-07-08
ASD003346	CM1152082-508	115208232		299.0 Square Meter	QUEENSBURY	St. Elizabeth		Queensbury District, St. Elizabeth	Private	- Ilene Lovender Clarke Alias Cislyn/Cis Retired Dressmaker of Queensbury District Southfield P.O. St. Elizabeth Jamaica	Inheritance			Absolute					2021-06-09
ASD003347	CM1152082-508	115208233		386.0 Square Meter	QUEENSBURY	St. Elizabeth		Queensbury District, St. Elizabeth	Private	- Mallora Verdeni Clarke Alias Molly Farmer of Queensbury District Southfield P.O. St. Elizabeth Jamaica	Possession			Absolute					2021-06-09
ASD003377	CM1152082-508	115208235		617.0 Square Meter	QUEENSBURY	St. Elizabeth		Queensbury District, St. Elizabeth	Private	- Kathleen Angelene Clarke Farmer of Queensbury District, Southfield P.O. St. Elizabeth Jamaica - Nicola Ionie Clarke Nurse's Assistant of Queensbury District, Southfield P.O. St. Elizabeth Jamaica	Possession			Absolute					2021-06-19
ASD003376	CM1152082-508	115208236		667.0 Square Meter	QUEENSBURY	St. Elizabeth		Queensbury District, St. Elizabeth	Private	- Dennis Christopher Clarke Taxi Operator of Queensbury District, Southfield P.O. St. Elizabeth Jamaica	Possession			Absolute					2021-06-15
ASD003365	CM1152082-508	115208237		476.0 Square Meter	QUEENSBURY	St. Elizabeth		Queensbury District, St. Elizabeth	Private	- Altamont Sherman Clarke Retired of 609 44th Street West Palm Beach Florida United States	Possession			Absolute					2021-06-09
ASD003349	CM1152082-508	115208238		1354.0 Square Meter	QUEENSBURY	St. Elizabeth		Queensbury District, St. Elizabeth	Private	- CLAUDIA MAY REID FARMER of Queensbury District Southfield P.O. St. Elizabeth Jamaica	Possession			Absolute					2021-06-09
ASD003354	CM1152082-508	115208239		2228.0 Square Meter	QUEENSBURY	St. Elizabeth		Queensbury District, St. Elizabeth	Private	- Evon Williams Farmer of Queensbury District, Southfield P.O. St. Elizabeth Jamaica	Possession			Absolute			- Utility Bills		2021-06-09
ASD003384	CM1152082-508	115208240		1255.0 Square Meter	QUEENSBURY	St. Elizabeth		Queensbury District, St. Elizabeth	Private	- Camille Vassell Waitress of Queensbury District, Southfield P.O. St. Elizabeth Jamaica	Possession			Absolute					2021-07-08
ASD003353	CM1152082-508	115208241		1036.0 Square Meter	QUEENSBURY	St. Elizabeth		Queensbury District, St. Elizabeth	Private	- Daphnie Bent-Harrison Farmer of Queensbury District, Southfield P.O. St. Elizabeth Jamaica	Possession			Absolute			- Survey Plan Examination No. : utility bills		2021-06-09
ASD003350	CM1152082-508	115208242		533.0 Square Meter	QUEENSBURY	St. Elizabeth		Queensbury District, St. Elizabeth	Private	- Marva Alana Parchment Alias Marva Farmer of Queensbury District, Southfield P.O. St. Elizabeth Jamaica	Purchase			Absolute			- Property Tax Receipts Agreement for Sale		2021-06-09
ASD003358	CM1152082-508	115208245		950.0 Square Meter	QUEENSBURY	St. Elizabeth		Queensbury District, St. Elizabeth	Private	- Nola Dimple James Alias Nola Housekeeper of Queensbury District, Southfield P.O. St. Elizabeth Jamaica - Errol Anthony James Alias James Retired Teacher of Queensbury District, Southfield P.O. St. Elizabeth Jamaica	Possession			Absolute			- Survey Plan Examination No. : 351560		2021-06-09



ADJUDICATION RECORD
 PURSUANT TO SECTION 8A (1) (e) and 8A (1) (g) OF THE
 REGISTRATION OF TITLES CADASTRAL MAPPING AND TENURE CLARIFICATION (SPECIAL PROVISIONS) ACT

SYSTEMATIC ADJUDICATION AREA : PARTS OF QUEENSBURY, ST. ELIZABETH

APPLICATION NO.	LAND INFORMATION									PERSONAL DETAILS			OCCUPANCY DETAILS						
	CADASTRAL MAP NUMBER	CADASTRAL MAP PARCEL NUMBER	LAND VALUATION NUMBER	AREA	PLACE	PARISH	VOLUME/FOLIO	PROPERTY ADDRESS	NATURE OF PARCEL	OWNER(S) DETAILS	NATURE BY WHICH LAND WAS ACQUIRED	NATURE OF OWNER DISBAILITY	NAME, ADDRESS AND OCCUPATION OF GUARDIAN	NATURE OF TITLE	DETAILS OF ENCUMBRANCES	RESTRICTIONS ON POWER TO DEAL WITH LAND	DETAILS OF PERSON ENTITLED TO BENEFIT OF RESTRICTION	DOCUMENTS PRESENTED	DATE OF COMPLETION OF APPLICATION FORM
ASD003359	CM1152082-508	115208246		935.0 Square Meter	QUEENSBURY	St. Elizabeth		Queensbury District, St. Elizabeth	Private	- Mark Andrade Harrison Alias Mark Caregiver of 2 Via de Casas Sur Apartment 102 Boynton Beach Florida United States	Possession			Absolute			- Survey Plan Examination No. : 398273		2021-06-09
ASD003362	CM1152082-508	115208247		2450.0 Square Meter	QUEENSBURY	St. Elizabeth		Queensbury District, St. Elizabeth	Private	- Reberta Palmer Alias Berta Retiree of Queensbury District, Southfield P.O. St. Elizabeth Jamaica	Possession	- Mental Disorder	- Sophia Farmer of Queensbury District St. Elizabeth	Absolute			- Property Tax Receipts		2021-06-09
ASD003360	CM1152082-508	115208248		852.0 Square Meter	QUEENSBURY	St. Elizabeth		Queensbury District, St. Elizabeth	Private	- Sophia Hyacinth Harrison Alias Boom Farmer of Queensbury District Southfield P.O. St. Elizabeth Jamaica	Purchase			Absolute			- Property Tax Receipts		2021-06-09
ASD003361	CM1152082-508	115208249		396.0 Square Meter	QUEENSBURY	St. Elizabeth		Queensbury District, St. Elizabeth	Private	- Reberta Palmer Alias Berta Retiree of Queensbury District, Southfield P.O. St. Elizabeth Jamaica	Possession			Absolute					2021-06-09
ASD003368	CM1152082-508	115208250		1891.0 Square Meter	QUEENSBURY	St. Elizabeth		Queensbury District, St. Elizabeth	Crown	- Commissioner of Lands A Corporation Sole established and existing under and by virtue of the provisions of the Crown Property (Vesting) Act of 20 North Street Kingston Jamaica	Special Provisions Act			Absolute					2021-06-10
ASD003369	CM1152082-508	115308216		4089.0 Square Meter	QUEENSBURY	St. Elizabeth		Queensbury District, St. Elizabeth	Private	- Doreen Clarke Myers Farmer of Queensbury District, Southfield P.O. St. Elizabeth Jamaica	Gift			Absolute			- Property Tax Receipts		2021-06-10

This Adjudication Record is comprised of an Adjudication Register of claims to ownership rights and interests in parcels of land and a Cadastral Map. Some parcels have been excluded from the Adjudication Record as a result of requests for further subdivision of parcels, encroachments, parcels already registered etc.

The Adjudication Record was displayed in the Systematic Adjudication Area on **August 5, 2021** and shall remain on display for a period of THIRTY (30) days.

During this period, the Senior Director, Adjudication Services may amend any minor error or omission not materially affecting the interest of any person. Therefore, any Applicant who considers the Adjudication Record to be contain minor inaccuracies or omissions, may within THIRTY (30) days of the date of display of the Adjudication Record, submit the details of such inaccuracies or omissions in the prescribed Form and manner.

Any person who objects to an Applicant's claim to ownership rights and interests in a parcel of land on the Adjudication Record, may within THIRTY (30) days of the date of display of the said Record submit the grounds for objection in the prescribed Form and manner.

The prescribed Forms (Amendment of the Adjudication Record or Objection to the Adjudication Record) are available at any National Land Agency office or via the Agency's website at: www.nla.gov.jm

All Requests for Amendment of the Adjudication Record or Objection to the Adjudication Record must be submitted using the prescribed Form to the Senior Director, Adjudication Services at:

National Land Agency
 8 Ardenne Road
 Kingston 10
 Saint Andrew

August 5, 2021

Display Date: _____

Senior Director, Adjudication Services:

CA 1152080-502

502

Scale 1:1,000 Cadastral Map

JAMAICA

LAMP BLOCK 52 - SHEET 080

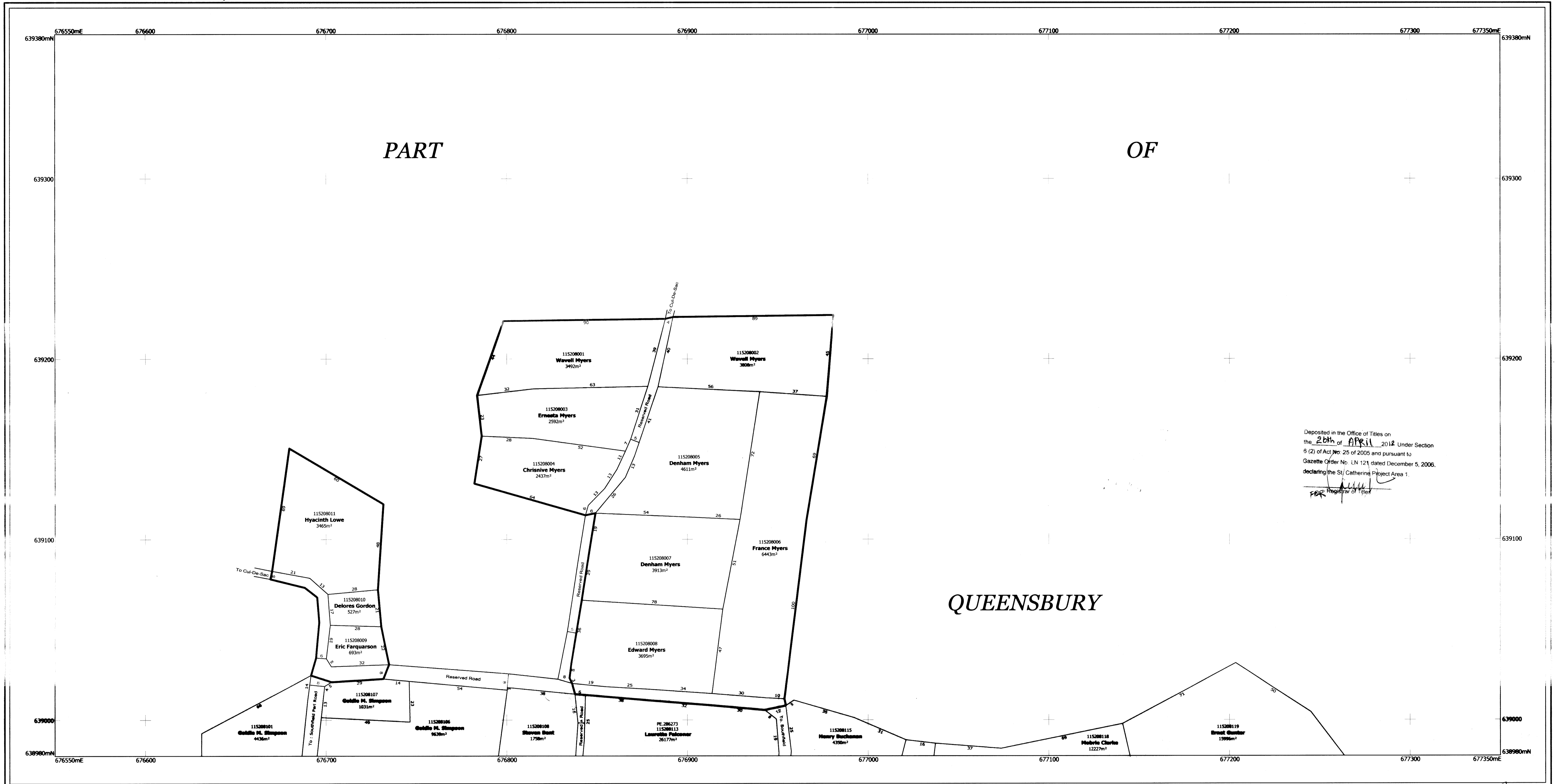

Deposited in the Office of Titles on the 20th of April 2012 Under Section 6 (2) of Act No. 25 of 2005 and pursuant to Gazette Order No. LN 121 dated December 5, 2006, declaring the St. Catherine Project Area 1.

[Signature]
 for Registrar of Titles

QUEENSBURY

CA 1152080-502

NLA CADMAP CHECKED

C. R. Edwards
 For Director of Surveys
 Date 2012/02/15

SURVEYORS: *[Signature]*
 PATRICK HENDRICKS
 COMMISSIONED LAND SURVEYOR
 GEOLAND TITLE LIMITED
 DATE 13/02/2012

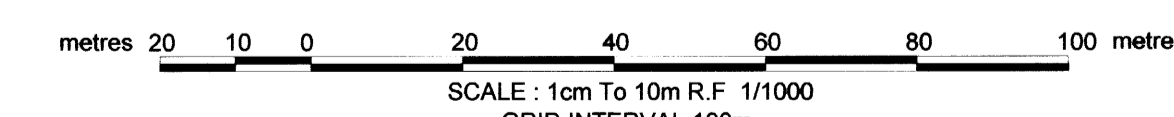

SCALE: 1cm To 10m R.F. 1/1000
 GRID INTERVAL 100m
 CADASTRAL MAP
 PART OF
 QUEENSBURY
 St. Elizabeth



Compiled by GEOLAND Ltd. from Plans annexed to Registered Titles, Plans by the Survey Department, Cadastral Records certified of the Survey Department and Field observation of Property boundaries.
 Compilation Date: June 30, 2011
 Users noting errors or omissions are asked to Return map to the Surveys and Mapping Division and it will be replaced.

Parcel Count Table

No. of Clarification Parcels	0
No. of Regularisation Parcels	11
Total no. of Parcels	11

Example of Parcel Numbering

Parish	11		
Block	52		
Sheet		080	
Parcel			03
Parcel #	115208003		

PREPARED BY
 GEOLAND TITLE LIMITED
 52-60 GRENADA CRESCENT,
 KINGSTON 5
 St. Andrew, Jamaica, W.I.
 TEL 876 908-0192



LEGEND

Volume and Folio	1234/567
Property Boundary	-----
Deposited Plan Boundary	-----
Gully/Drain/River	-----
Registered Boundary	-----

SURVEY DATUM: JAD2001

Projection: Lambert Conical Orthomorphic with one Standard Parallel (18°E)
 Spheroid: WGS84 (JAD2001 National Grid System)
 Unit of Measurement: Metre
 Origin: 77°E 00' 00" W of Greenwich
 18°E 00' 00" N of the Equator
 False Co-ordinates of Origin: 750,000m Easting
 650,000m Northing
 Scale Factor at Origin: 1.000

Certified that the area delineated on this map form part of LAMP St. Elizabeth Project Area 1
 Gazetted at Order No. dated July 20, 2009
 Dated the 15th of February 2012
C. R. Edwards
 For Director of Survey

C11152081-503 503

Scale 1:1,000 Cadastral Map

LAMP BLOCK 52 - SHEET 081

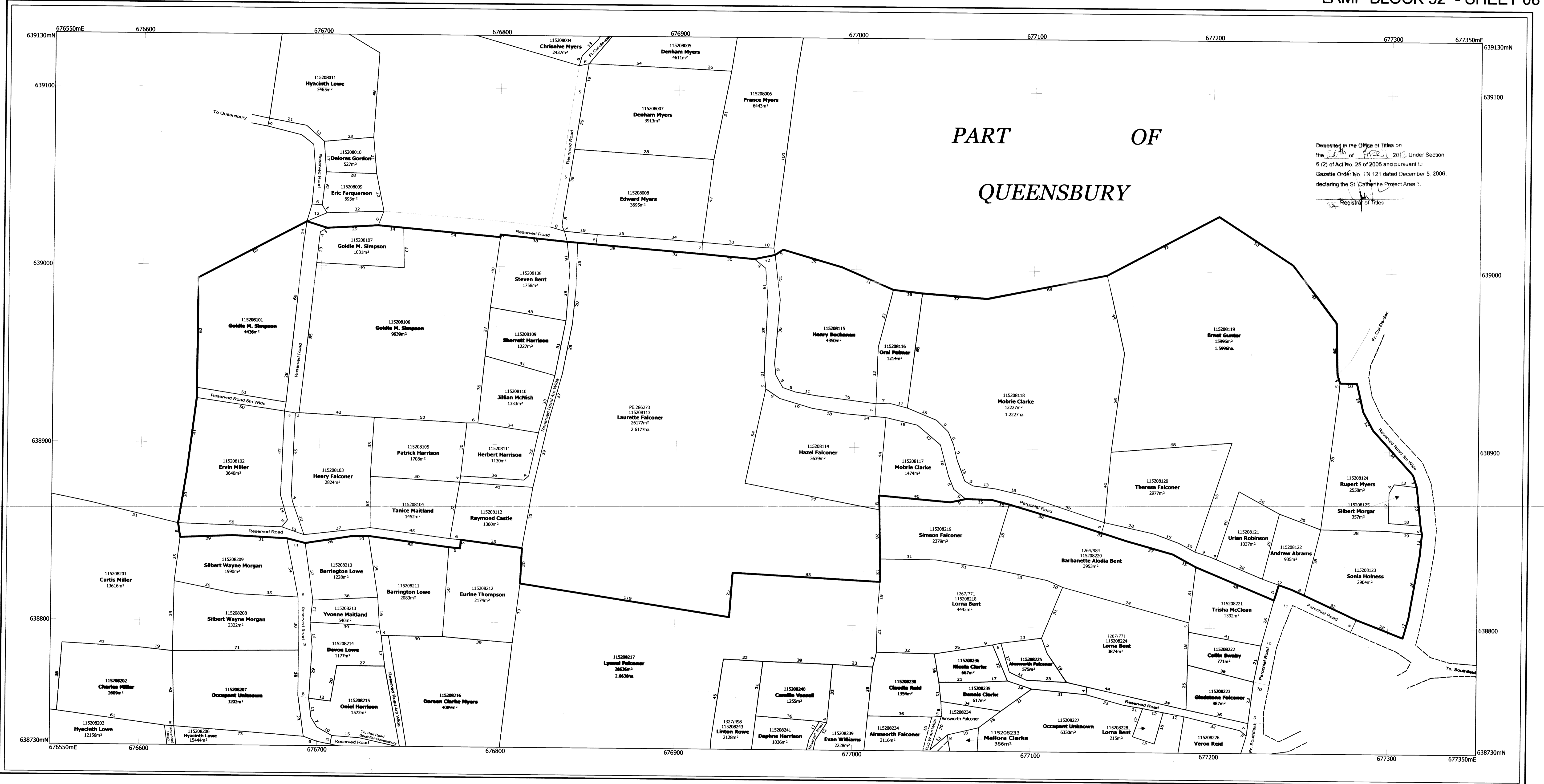

Deposited in the Office of Titles on the 24th of April 2012 Under Section 6 (2) of Act No. 25 of 2005 and pursuant to Gazette Order No. LN 121 dated December 5, 2006, declaring the St. Catherine Project Area 1.

Registrar of Titles

L1152081

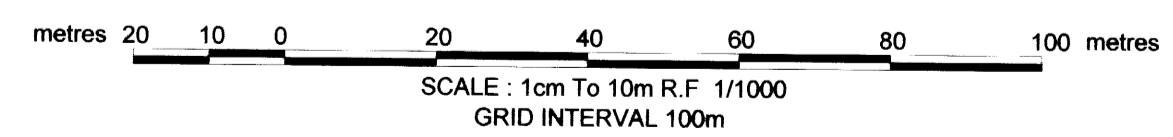

NLA CADMAP CHECKED

C. R. Edwards
For Director of Surveys
Date 2012/02/15

Parcel Count Table	
No. of Clarification Parcels	0
No. of Regularisation Parcels	25
Total no. of Parcels	25

Example of Parcel Numbering	
Parish	11
Block	52
Sheet	081
Parcel	03
Parcel #	115208103

SURVEYORS: *Patrick Hendricks*
PATRICK HENDRICKS
COMMISSIONED LAND SURVEYOR
GEOLAND TITLE LIMITED
DATE 13/12/12

PREPARED BY
GEOLAND TITLE LIMITED
52-60 GRENADA CRESCENT,
KINGSTON 5
St. Andrew, Jamaica, W.I.
TEL. 876 908-0192



LEGEND

Volume and Folio	1234/567
Property Boundary	-----
Deposited Plan Boundary	-----
Gully/Drain/River	-----
Registered Boundary	-----

SURVEY DATUM : JAD2001

Projection: Lambert Conical Orthomorphic with one Standard Parallel (18.4E)
Spheroid: WGS84 (JAD2001 National Grid System)
Unit of Measurement: Metre
Origin: 77°E 00' 00" W of Greenwich
False Co-ordinates of Origin: 750,000m Easting
Scale Factor at Origin: 1.000

Certified that the area delineated on this map form part of LAMP St. Elizabeth Project Area 1 Gazetted at Order No. dated July 20, 2009 Dated the 15th of February 2012
C. R. Edwards
Director of Surveys

CADASTRAL MAP
PART OF
QUEENSBURY
St. Elizabeth

Compiled by GEOLAND Ltd. from Plans annexed to Registered Titles. Plans by the Survey Department, Cadastral Records certified of the Survey Department and Field observation of Property boundaries.
Compilation Date: June 30, 2011
Users noting errors or omissions are asked to Return map to the Surveys and Mapping Division and it will be replaced.

