





<div><div><div>ADJUDICATION RECORD</div><div>PURSUANT TO SECTION 8A (1) (a) and 8A (1) (g) OF THE REGISTRATION OF TITLES CADASTRAL MAPPING AND TENURE CLARIFICATION (SPECIAL PROVISIONS) ACT</div></div></div>																			
SYSTEMATIC ADJUDICATION AREA : PARTS OF HAUGHTON, ST. ELIZABETH																			
APPLICATION NO.	LAND INFORMATION									PERSONAL DETAILS		OCCUPANCY DETAILS							
	CADASTRAL MAP NUMBER	CADASTRAL MAP PARCEL NUMBER	LAND VALUATION NUMBER	AREA	PLACE	PARISH	VOLUME/FOLIO	PROPERTY ADDRESS	NATURE OF PARCEL	OWNER(S) DETAILS	NATURE BY WHICH LAND WAS ACQUIRED	NATURE OF OWNER DISABILITY	NAME, ADDRESS AND OCCUPATION OF GUARDIAN	NATURE OF TITLE	DETAILS OF ENCUMBRANCES	RESTRICTIONS ON POWER TO DEAL WITH LAND	DETAILS OF PERSON ENTITLED TO BENEFIT OF RESTRICTION	DOCUMENTS PRESENTED	DATE OF COMPLETION OF APPLICATION FORM
ASD005655	CM1127060-477	112706002		939.0 Square Meter	HAUGHTON	St. Elizabeth		Haughton District, St. Elizabeth	Private	- Patsy Yvette Dunkley-Drew Sales Associate of Herberts Estates Saint John Antigua and Barbuda - Lorna Leonie Dunkley-Robinson Farmer of Haughton District, Lacovia P.O. St. Elizabeth Jamaica	Inheritance			Qualified	Right of Way				2021-09-22
ASD004666	CM1127060-477	112706003		1029.0 Square Meter	HAUGHTON	St. Elizabeth	1228/170	Haughton District, St. Elizabeth	Private	- Kelroy Andrew Rashford Cleaner of 91 Hazelwood Close, Arbury Cambridge United Kingdom	Possession			Absolute					2021-06-13
ASD004667	CM1127060-477	112706004		372.0 Square Meter	HAUGHTON	St. Elizabeth	1228/170	Haughton District, St. Elizabeth	Private	- Stasha-Gay Keilliah Campbell-Drummond Nurse of Haughton District, P.O. Box 27 Lacovia St. Elizabeth Jamaica	Possession			Absolute	Right of Way				2021-06-09
ASD004669	CM1127060-477	112706006		517.0 Square Meter	HAUGHTON	St. Elizabeth		Haughton District, St. Elizabeth	Private	- Grantley Geoffrey Frank Truck Driver of Haughton District Lacovia P.O. St. Elizabeth Jamaica	Possession			Qualified					2021-03-20
ASD004671	CM1127060-477	112706007		582.0 Square Meter	HAUGHTON	St. Elizabeth		Haughton District, St. Elizabeth	Private	- Beryl Carnegie Retired Farmer of Haughton District, Lacovia P.O. St. Elizabeth Jamaica	Possession			Absolute					2021-06-02
ASD004672	CM1127060-477	112706008		652.0 Square Meter	HAUGHTON	St. Elizabeth		Haughton District, St. Elizabeth	Private	- Ivy Iuda Dennis Retiree of Old Porus Road, Porus P.O. Manchester Jamaica	Possession			Absolute					2021-07-06
ASD004673	CM1127060-477	112706009		535.0 Square Meter	HAUGHTON	St. Elizabeth		Haughton District, St. Elizabeth.	Private	- Colin Anthony Brown Farmer of Haughton District, Lacovia P.O. St. Elizabeth Jamaica	Possession			Absolute					2021-06-02
ASD005672	CM1127060-477	112706010		1359.0 Square Meter	HAUGHTON	St. Elizabeth		Haughton District, St. Elizabeth	Crown	- Commissioner of Lands of 20 North Street Kingston Jamaica	Special Provisions Act			Absolute					2021-09-22
ASD004675	CM1127060-477	112706011		834.0 Square Meter	HAUGHTON	St. Elizabeth		Haughton District, St. Elizabeth	Private	- Joan Murcielyn Mills Farmer and Businesswoman of Haughton District, Lacovia P.O. St. Elizabeth Jamaica	Possession			Absolute					2021-06-09
ASD004677	CM1127060-477	112706013		410.0 Square Meter	HAUGHTON	St. Elizabeth	Partially registered at Volume 1228 Folio 170 (248 square metres) and partially unregistered (410 square metres)	Haughton District, St. Elizabeth	Private	- Jennilyn Virginia Brown Practical Nurse of Haughton District, Lacovia P.O. St. Elizabeth Jamaica	Possession			Absolute					2021-06-09
ASD004678	CM1127060-477	112706014		861.0 Square Meter	HAUGHTON	St. Elizabeth	1228/170	Haughton District, St. Elizabeth	Private	- Lorna Leonie Dunkley-Robinson Business Owner of Haughton District Lacovia P.O. St. Elizabeth Jamaica	Possession			Absolute	Right of Way				2021-06-09
ASD004852	CM1127060-477	112706015		437.0 Square Meter	HAUGHTON	St. Elizabeth		Haughton, St. Elizabeth	Private	- Hopeton Fitzroy Dixon Farmer of Haughton District, Lacovia P.O. St. Elizabeth Jamaica	Possession			Absolute				- Survey Plan Examination No. : 286480	2021-08-24
ASD004681	CM1127060-477	112706016		404.0 Square Meter	HAUGHTON	St. Elizabeth		Haughton District, St. Elizabeth	Private	- David Stephen Holness Alias Boysie Farmer of Haughton District, Lacovia P.O. St. Elizabeth Jamaica	Possession			Absolute					2021-06-09
ASD005501	CM1127060-477	112706017		440.0 Square Meter	HAUGHTON	St. Elizabeth	1228/170	Haughton District, St. Elizabeth	Private	- Winsome Margaret Frank Retired farmer of Haughton District Maggotty P.O. St. Elizabeth Jamaica	Possession			Absolute				- Property Tax Receipts	2021-09-20
ASD004683	CM1127060-477	112706018		386.0 Square Meter	HAUGHTON	St. Elizabeth	Partially registered at Volume 1228 Folio 170 (90 square metres) and partially unregistered (386 square metres)	Haughton District, St. Elizabeth	Private	- Joshua Dennis Alias Jethro Taxi Operator of Haughton District, Lacovia P.O. St. Elizabeth Jamaica	Possession			Absolute					2021-06-09
ASD004685	CM1127060-477	112706022		1013.0 Square Meter	HAUGHTON	St. Elizabeth		Haughton District, St. Elizabeth	Private	- Donald Brown Truck Driver of Haughton District, Lacovia P.O. St. Elizabeth Jamaica	Possession			Absolute					2021-06-09

<div><div><div>ADJUDICATION RECORD</div><div>PURSUANT TO SECTION 8A (1) (a) and 8A (1) (g) OF THE REGISTRATION OF TITLES CADASTRAL MAPPING AND TENURE CLARIFICATION (SPECIAL PROVISIONS) ACT</div></div></div>																			
SYSTEMATIC ADJUDICATION AREA : PARTS OF HAUGHTON, ST. ELIZABETH																			
APPLICATION NO.	CADASTRAL MAP NUMBER	CADASTRAL MAP PARCEL NUMBER	LAND VALUATION NUMBER	LAND INFORMATION					PERSONAL DETAILS		OCCUPANCY DETAILS								
				AREA	PLACE	PARISH	VOLUME/FOLIO	PROPERTY ADDRESS	NATURE OF PARCEL	OWNER(S) DETAILS	NATURE BY WHICH LAND WAS ACQUIRED	NATURE OF OWNER DISABILITY	NAME, ADDRESS AND OCCUPATION OF GUARDIAN	NATURE OF TITLE	DETAILS OF ENCUMBRANCES	RESTRICTIONS ON POWER TO DEAL WITH LAND	DETAILS OF PERSON ENTITLED TO BENEFIT OF RESTRICTION	DOCUMENTS PRESENTED	DATE OF COMPLETION OF APPLICATION FORM
ASD004689	CM1127060-477	112706028		1096.0 Square Meter	HAUGHTON	St. Elizabeth		Haughton District, St. Elizabeth	Private	- Garrie Willesley Rowe Maintenance Technician of 1130 Magnolia Avenue, Camden New Jersey United States	Possession			Absolute	easement				2021-06-13
ASD005635	CM1127060-477	112706029		3699.0 Square Meter	HAUGHTON	St. Elizabeth		Haughton District, St. Elizabeth	Crown	- Commissioner of Lands of 20 North Street Kingston Jamaica	Special Provisions Act			Absolute					2021-09-22
ASD005636	CM1127060-477	112706030		3699.0 Square Meter	HAUGHTON	St. Elizabeth		Haughton District, St. Elizabeth	Crown	- Commissioner of Lands of 20 North Street Kingston Jamaica	Special Provisions Act			Absolute					2021-09-22
ASD004690	CM1127060-477	112706031		1472.0 Square Meter	HAUGHTON	St. Elizabeth		Haughton District, St. Elizabeth	Private	- Commissioner of Lands of 20 North Street Kingston Jamaica	Special Provisions Act			Absolute	Right of way				2021-08-23
ASD004692	CM1127060-477	112706032		2827.0 Square Meter	HAUGHTON	St. Elizabeth		Haughton District, St. Elizabeth	Private	- Wesley Seaton Retired Heavy Duty Operator of Haughton District, Lacovia P.O. St. Elizabeth Jamaica	Possession			Absolute	easement				2021-06-13
ASD005477	CM1127060-477	112706033		1875.0 Square Meter	HAUGHTON	St. Elizabeth		Haughton District, St. Elizabeth	Crown	- Commissioner of Lands of 20 North Street Kingston Jamaica	Special Provisions Act			Absolute	lease				2021-09-20
ASD004693	CM1127060-477	112706034		1609.0 Square Meter	HAUGHTON	St. Elizabeth		Haughton District, St. Elizabeth	Private	- Marva Marlene Seaton Supervisor of 1 Spaulding Lane, Kingston 5 St. Andrew Jamaica	Possession			Absolute					2021-07-06
ASD005451	CM1127060-477	112706036		977.0 Square Meter	HAUGHTON	St. Elizabeth		Haughton District, St. Elizabeth	Private	- Kenneth Calvin Samuels Retired School Principal of 83 Garyscholl Road Woodbridge Ontario Canada	Possession			Absolute			- Property Tax Receipts		2021-09-19
ASD005657	CM1127060-477	112706037		1003.0 Square Meter	HAUGHTON	St. Elizabeth		Haughton District, St. Elizabeth	Crown	- Commissioner of Lands of 20 North Street Kingston Jamaica	Special Provisions Act			Absolute					2021-09-22
ASD004695	CM1127060-477	112706038		693.0 Square Meter	HAUGHTON	St. Elizabeth		Haughton District, St. Elizabeth	Private	- Michael Hanson Farmer of Haughton District, Lacovia P.O. St. Elizabeth Jamaica	Possession			Absolute			- Property Tax Receipts		2021-02-10
ASD004696	CM1127060-477	112706039		919.0 Square Meter	HAUGHTON	St. Elizabeth		Haughton District, St. Elizabeth	Private	- Pamela McRae Retired farmer of Haughton District, Lacovia P.O. St. Elizabeth Jamaica	Possession			Absolute					2021-03-04
ASD005468	CM1127060-477	112706040		416.0 Square Meter	HAUGHTON	St. Elizabeth		Haughton District, Lacovia P.O. St. Elizabeth	Private	- Steve Michael Dixon Farmer of Haughton District Lacovia P.O. St. Elizabeth Jamaica	Possession			Absolute			- Survey Plan Examination No. : 284320		2021-09-19
ASD005538	CM1127060-477	112706041		582.0 Square Meter	HAUGHTON	St. Elizabeth		Haughton District, St. Elizabeth	Private	- Lisa Seaton- Thompson Chef of Retirement Road, Santa Cruz P.O. St. Elizabeth Jamaica	Possession			Qualified					2021-09-20
ASD005665	CM1127060-477	112706042		962.0 Square Meter	HAUGHTON	St. Elizabeth		Haughton District, St. Elizabeth	Private	- Winsome Veronica Brown of 21 Halart Drive, Kingston 6 St. Andrew Jamaica	Possession			Absolute					2021-09-22
ASD005658	CM1127060-477	112706043		2131.0 Square Meter	HAUGHTON	St. Elizabeth		Haughton District, St. Elizabeth	Crown	- Commissioner of Lands of 20 North Street Kingston Jamaica	Special Provisions Act			Absolute					2021-09-22
ASD004699	CM1127060-477	112706044		4906.0 Square Meter	HAUGHTON	St. Elizabeth	Partially registered at 1150/114 (4866 Sq. m) and partially unregistered (40 sq. m.))	Haughton District, St. Elizabeth	Private	- Jacqueline Mitchell Daley Chef of Haughton District, Lacovia P.O. St. Elizabeth Jamaica	Gift			Absolute			- Property Tax Receipts		2021-06-09
ASD004701	CM1127060-477	112706046		964.0 Square Meter	HAUGHTON	St. Elizabeth		Haughton District, St. Elizabeth	Private	- Leroy FitzGerald Seaton Farmer of 29 Delancey House, Lupus Street, Pimlico London United Kingdom	Possession			Absolute	Right of Way				2021-06-13
ASD005410	CM1127060-477	112706047		1789.0 Square Meter	HAUGHTON	St. Elizabeth		Haughton District, St. Elizabeth	Private	- Jean Lena Seaton Unemployed of Bartons Wharf, Lacovia P.O. St. Elizabeth Jamaica	Possession			Absolute					2021-09-17
ASD005089	CM1127060-477	112706048		1108.0 Square Meter	HAUGHTON	St. Elizabeth		Haughton, St. Elizabeth	Crown	- Commissioner of Lands of 20 North Street Kingston Jamaica	Special Provisions Act			Absolute	easement				2021-08-26
ASD005473	CM1127060-477	112706050		1165.0 Square Meter	HAUGHTON	St. Elizabeth		Haughton District, Lacovia, St. Elizabeth	Private	- Junior Anthony Rankine Farmer of Haughton District, Lacovia P.O. St. Elizabeth Jamaica	Possession			Absolute					2021-09-19
ASD004702	CM1127060-477	112706051		623.0 Square Meter	HAUGHTON	St. Elizabeth		Haughton District, St. Elizabeth	Private	- Girline Carnegie Farmer of Haughton District Lacovia P.O. St. Elizabeth Jamaica	Possession			Absolute					2021-02-09

<div><div><div><div><div><div></div></div><div>NLA</div></div><div>NATIONAL LAND AGENCY</div></div></div><div><div>ADJUDICATION RECORD</div><div>PURSUANT TO SECTION 8A (1) (a) and 8A (1) (g) OF THE REGISTRATION OF TITLES CADASTRAL MAPPING AND TENURE CLARIFICATION (SPECIAL PROVISIONS) ACT</div></div></div>																				
SYSTEMATIC ADJUDICATION AREA : PARTS OF HAUGHTON, ST. ELIZABETH																				
	LAND INFORMATION								PERSONAL DETAILS		OCCUPANCY DETAILS									
APPLICATION NO.	CADASTRAL MAP NUMBER	CADASTRAL MAP PARCEL NUMBER	LAND VALUATION NUMBER	AREA	PLACE	PARISH	VOLUME/FOLIO	PROPERTY ADDRESS	NATURE OF PARCEL	OWNER(S) DETAILS	NATURE BY WHICH LAND WAS ACQUIRED	NATURE OF OWNER DISABILITY	NAME, ADDRESS AND OCCUPATION OF GUARDIAN	NATURE OF TITLE	DETAILS OF ENCUMBRANCES	RESTRICTIONS ON POWER TO DEAL WITH LAND	DETAILS OF PERSON ENTITLED TO BENEFIT OF RESTRICTION	DOCUMENTS PRESENTED	DATE OF COMPLETION OF APPLICATION FORM	
ASD005483	CM1127060-477	112706052		328.0 Square Meter	HAUGHTON	St. Elizabeth		Haughton District, Lacovia, St. Elizabeth	Private	- Babsilyn Patricia Barrett Farmer of Haughton District, Lacovia P.O. St. Elizabeth Jamaica	Possession			Absolute					2021-09-20	
ASD004704	CM1127060-477	112706054		664.0 Square Meter	HAUGHTON	St. Elizabeth		Haughton District, St. Elizabeth	Private	- Kazel Williams Farmer of Haughton District, Lacovia P.O. Lacovia P.O. St. Elizabeth Jamaica	Possession			Absolute				- Survey Plan Examination No. : 127764	2021-02-10	
ASD004705	CM1127060-477	112706055		1906.0 Square Meter	HAUGHTON	St. Elizabeth		Haughton District, St. Elizabeth	Private	- Ralston Roy Seaton Alias Noni Construction Worker of Burton District, Lacovia P.O. St. Elizabeth Jamaica	Possession			Absolute					2021-03-24	
ASD004707	CM1127060-477	112706056		804.0 Square Meter	HAUGHTON	St. Elizabeth		Haughton District, St. Elizabeth	Private	- William Steadbert McLeod Farmer of Haughton District, Lacovia P.O. St. Elizabeth Jamaica - Eugenny McLeod Farmer of Haughton District, Lacovia P.O. St. Elizabeth Jamaica	Possession			Absolute					2021-06-09	
ASD002642	CM1127060-477	112706058		266.0 Square Meter	HAUGHTON	St. Elizabeth		Haughton District, St. Elizabeth	Private	- Angela Elvamay Thingling-Samuels Farmer of Haughton District, Lacovia P.O. St. Elizabeth Jamaica	Possession			Qualified	easement			- Last Will and Testament of : Gilbert Samuels - Death Certificate	2021-06-28	
ASD004806	CM1127070-476	112707001		1091.0 Square Meter	HAUGHTON	St. Elizabeth		Haughton District, Lacovia, St. Elizabeth	Private	- The West Indies Union Conference (Jamaica) Corporation of Seventh-Day Adventists A company incorporated under The West Indies Union Conference (Jamaica) Corporation of Seventh-Day Adventists (Incorporation and Vesting) Act, 1993 of 125 Manchester Road, Mandeville P.O. Manchester Jamaica	Possession			Absolute				- Survey Plan Examination No. : 266042 - Agreement for Sale	2021-06-09	
ASD004712	CM1127070-476	112707006		1073.0 Square Meter	HAUGHTON	St. Elizabeth		Haughton District, St. Elizabeth	Private	- Auvril Maureen Dennis Teacher of Haughton District, Maggoty P.O. St. Elizabeth Jamaica - Cadien Lee Dennis Farmer of Haughton District, Maggoty P.O. St. Elizabeth Jamaica	Purchase	- Other	Auvril Dennis Teacher of Haughton District St. Elizabeth	Absolute				- Receipt	2021-06-09	
ASD004713	CM1127070-476	112707007		3861.0 Square Meter	HAUGHTON	St. Elizabeth		Haughton District, St. Elizabeth	Private	- Astley Everton Williams Alias Brocko Farmer of Haughton District, Lacovia P.O. St. Elizabeth Jamaica	Possession			Absolute				- Survey Plan Examination No. : 262799	2021-06-09	
ASD004714	CM1127070-476	112707009		1013.0 Square Meter	HAUGHTON	St. Elizabeth		Haughton District, St. Elizabeth	Private	- Zonie Donnaree Smith Vendor of Haughton District, Lacovia P.O. St. Elizabeth Jamaica - George Anthony Robinson Vendor of Haughton District, Lacovia P.O. St. Elizabeth Jamaica	Possession			Absolute					2021-03-11	
ASD004715	CM1127070-476	112707011		613.0 Square Meter	HAUGHTON	St. Elizabeth		Haughton District, St. Elizabeth	Private	- Dave Courtney Robinson Alias Mento Carpenter/Mason of Haughton District, Lacovia P.O. St. Elizabeth Jamaica	Possession			Absolute				- Receipt	2021-06-09	
ASD004716	CM1127070-476	112707012		882.0 Square Meter	HAUGHTON	St. Elizabeth		Haughton District, St. Elizabeth	Private	- Cutie Euphema Allen Alias Miss Cutie Retired Cook of 46 Western Avenue 1A, Yonkers New York United States - Tracey-Ann Denise Bailey Probate Officer of 295 NW 190 Street, Miami Gardens Florida United States - Gillian Nicole Bernard Registered Nurse of 53 Lennon Ave, Yonkers New York United States - Marie Jacqueline Brown Home Health Aid of 855 Ashley Lane, Stone Mountain Georgia United States	Possession			Absolute						2021-03-04
ASD005207	CM1127070-476	112707013		1136.0 Square Meter	HAUGHTON	St. Elizabeth		Haughton District, St. Elizabeth	Crown	- Commissioner of Lands of 20 North Street Kingston Jamaica	Special Provisions Act			Absolute					2021-09-08	
ASD004717	CM1127070-476	112707014		707.0 Square Meter	HAUGHTON	St. Elizabeth		Haughton District, St. Elizabeth	Private	- Delroy Danavan Smith Alias Dodo Farmer of Haughton District, Lacovia P.O. St. Elizabeth Jamaica	Possession			Absolute					2021-06-09	
ASD004718	CM1127070-476	112707015		749.0 Square Meter	HAUGHTON	St. Elizabeth		Haughton District, St. Elizabeth	Private	- Tackie Smith Farmer of Haughton District, Lacovia P.O. St. Elizabeth Jamaica	Possession			Absolute					2021-06-09	
ASD005200	CM1127070-476	112707016		471.0 Square Meter	HAUGHTON	St. Elizabeth		Haughton District, St. Elizabeth	Crown	- Commissioner of Lands of 20 North Street Kingston Jamaica	Special Provisions Act			Absolute					2021-09-08	

<div><div>ADJUDICATION RECORD</div><div>PURSUANT TO SECTION 8A (1) (a) and 8A (1) (g) OF THE</div><div>REGISTRATION OF TITLES CADASTRAL MAPPING AND TENURE CLARIFICATION (SPECIAL PROVISIONS) ACT</div></div>																			
SYSTEMATIC ADJUDICATION AREA : PARTS OF HAUGHTON, ST. ELIZABETH																			
	LAND INFORMATION								PERSONAL DETAILS			OCCUPANCY DETAILS							
APPLICATION NO.	CADASTRAL MAP NUMBER	CADASTRAL MAP PARCEL NUMBER	LAND VALUATION NUMBER	AREA	PLACE	PARISH	VOLUME/FOLIO	PROPERTY ADDRESS	NATURE OF PARCEL	OWNER(S) DETAILS	NATURE BY WHICH LAND WAS ACQUIRED	NATURE OF OWNER DISABILITY	NAME, ADDRESS AND OCCUPATION OF GUARDIAN	NATURE OF TITLE	DETAILS OF ENCUMBRANCES	RESTRICTIONS ON POWER TO DEAL WITH LAND	DETAILS OF PERSON ENTITLED TO BENEFIT OF RESTRICTION	DOCUMENTS PRESENTED	DATE OF COMPLETION OF APPLICATION FORM
ASD004734	CM1127070-476	112707036		687.0 Square Meter	HAUGHTON	St. Elizabeth		Haughton District, St. Elizabeth	Private	- Derrick Arthur Ledgister Alias Carro Farmer of Haughton District, Lacovia P.O. St. Elizabeth Jamaica	Possession			Absolute					2021-06-09
ASD004735	CM1127070-476	112707037		367.0 Square Meter	HAUGHTON	St. Elizabeth		Haughton District, St. Elizabeth	Private	- Richard Ledgister Labourer of Haughton District, Lacovia P.O. St. Elizabeth Jamaica	Possession	- Mental Disorder	Ralston Ledgister, Farmer of Haughton District, Lacovia P.O. St. Elizabeth	Absolute					2021-06-09
ASD004737	CM1127070-476	112707038		581.0 Square Meter	HAUGHTON	St. Elizabeth		Haughton District, St. Elizabeth	Private	- Ralston Ledgister Alias Teeth Farmer of Haughton District, Lacovia P.O. St. Elizabeth Jamaica	Possession			Absolute					2021-06-09
ASD004797	CM1127070-476	112707039		634.0 Square Meter	HAUGHTON	St. Elizabeth		Haughton District, St. Elizabeth	Private	- Millicent Ledgister Alias Minky Domestic Helper of Haughton District, Lacovia P.O. St. Elizabeth Jamaica	Possession			Absolute					2021-03-04
ASD004739	CM1127070-476	112707040		1667.0 Square Meter	HAUGHTON	St. Elizabeth		Haughton District, St. Elizabeth	Private	- Devon Anthony McLeod Alias Leroy Farmer of Greenfield District, Lacovia P.O. St. Elizabeth Jamaica	Gift			Absolute			- Property Tax Receipts		2021-06-09
ASD005647	CM1127160-553	112716003		1076.0 Square Meter	HAUGHTON	St. Elizabeth		Haughton District, St. Elizabeth	Crown	- Commissioner of Lands of 20 North Street Kingston Jamaica	Special Provisions Act			Absolute					2021-09-22
ASD005308	CM1127160-553	112716004		1082.0 Square Meter	HAUGHTON	St. Elizabeth		Haughton District, St. Elizabeth	Private	- Iva Condewtta Wallace Retired Cook of 29 Bequincey House, Lupus Street London United Kingdom	Possession			Absolute					2021-09-15
ASD005281	CM1127160-553	112716005		1059.0 Square Meter	HAUGHTON	St. Elizabeth		Haughton District, St. Elizabeth	Crown	- Commissioner of Lands of 20 North Street Kingston Jamaica	Special Provisions Act			Absolute					2021-09-14
ASD005626	CM1127160-553	112716006		1008.0 Square Meter	HAUGHTON	St. Elizabeth		Haughton District, St. Elizabeth	Private	- Sheea Elizabeth Parkinson Nurse of 107 Watling Street, Rochester Kent United Kingdom	Inheritance			Absolute				- Death Certificate	2021-09-21
ASD004740	CM1127160-553	112716007		1020.0 Square Meter	HAUGHTON	St. Elizabeth		Haughton District, St. Elizabeth	Private	- Wilburn David Barton Retired School Principal of Haughton District, Maggotty P.O. St. Elizabeth Jamaica	Possession			Qualified					2021-03-04
ASD004741	CM1127160-553	112716008		792.0 Square Meter	HAUGHTON	St. Elizabeth		Haughton District, St. Elizabeth	Private	- Carla Coleen Dunkley-Mckogg Cashier of Haughton District, Lacovia P.O. St. Elizabeth Jamaica - Andrew Martin Mckogg Driver of Haughton District, Lacovia P.O. St. Elizabeth Jamaica	Purchase			Absolute				- Receipt	2021-03-11
ASD004742	CM1127160-553	112716016		641.0 Square Meter	HAUGHTON	St. Elizabeth		Haughton District, St. Elizabeth	Private	- Andrea Smith Farmer of Haughton District, Lacovia P.O. Lacovia P.O. St. Elizabeth Jamaica	Possession			Absolute					2021-03-11
ASD005427	CM1127160-553	112716017		1992.0 Square Meter	HAUGHTON	St. Elizabeth			Crown	- Commissioner of Lands of 20 North Street Kingston Jamaica	Special Provisions Act			Absolute					2021-09-17
ASD004744	CM1127160-553	112716018		1353.0 Square Meter	HAUGHTON	St. Elizabeth		Haughton District, St. Elizabeth	Private	- Donovan Archibald Fearon Farmer of 5 Warburton Close, Hale Barns, Altrincham Cheshire United Kingdom	Purchase			Absolute					2021-03-25
ASD004745	CM1127160-553	112716019		1141.0 Square Meter	HAUGHTON	St. Elizabeth		Haughton District, St. Elizabeth	Private	- Donovan Archibald Fearon Farmer of 5 Warburton Close, Hale Barns, Altrincham Cheshire United Kingdom	Purchase			Absolute					2021-03-25
ASD005421	CM1127160-553	112716020		1825.0 Square Meter	HAUGHTON	St. Elizabeth		Haughton, St. Elizabeth	Crown	- Commissioner of Lands of 20 North Street Kingston Jamaica	Special Provisions Act			Absolute					2021-09-17
ASD005422	CM1127160-553	112716022		766.0 Square Meter	HAUGHTON	St. Elizabeth		Haughton District, St. Elizabeth	Private	- Lasmine Icylyn Bailey Housekeeper of 257 East 46th Street, Brooklyn, New York New York United States of America	Possession			Absolute					2021-09-17

<div><div>ADJUDICATION RECORD</div><div>PURSUANT TO SECTION 8A (1) (a) and 8A (1) (g) OF THE</div><div>REGISTRATION OF TITLES CADASTRAL MAPPING AND TENURE CLARIFICATION (SPECIAL PROVISIONS) ACT</div></div>																			
SYSTEMATIC ADJUDICATION AREA : PARTS OF HAUGHTON, ST. ELIZABETH																			
	LAND INFORMATION									PERSONAL DETAILS		OCCUPANCY DETAILS							
APPLICATION NO.	CADASTRAL MAP NUMBER	CADASTRAL MAP PARCEL NUMBER	LAND VALUATION NUMBER	AREA	PLACE	PARISH	VOLUME/FOLIO	PROPERTY ADDRESS	NATURE OF PARCEL	OWNER(S) DETAILS	NATURE BY WHICH LAND WAS ACQUIRED	NATURE OF OWNER DISABILITY	NAME, ADDRESS AND OCCUPATION OF GUARDIAN	NATURE OF TITLE	DETAILS OF ENCUMBRANCES	RESTRICTIONS ON POWER TO DEAL WITH LAND	DETAILS OF PERSON ENTITLED TO BENEFIT OF RESTRICTION	DOCUMENTS PRESENTED	DATE OF COMPLETION OF APPLICATION FORM
ASD004746	CM1127160-553	112716023		769.0 Square Meter	HAUGHTON	St. Elizabeth		Haughton District, St. Elizabeth	Private	- Claudette Jendolyn Bailey Housekeeper of 257 East 46th Street, Brooklyn New York United States	Possession			Absolute					2021-03-04
ASD004747	CM1127160-553	112716024		772.0 Square Meter	HAUGHTON	St. Elizabeth		Haughton District, St. Elizabeth	Private	- Graeme Pierre Brissett Unemployed of Haughton District, Lacovia P.O. St. Elizabeth Jamaica - Gregory Paul Brissett Cashier of Haughton District, Lacovia P.O. St. Elizabeth Jamaica	Possession			Absolute				- Last Will and Testament of : Kenrick Brissett	2021-03-04
ASD004748	CM1127160-553	112716025		1024.0 Square Meter	HAUGHTON	St. Elizabeth		Haughton District, St. Elizabeth	Private	- Donovan Archibald Fearon Farmer of 5 Warburton Close, Hale Barns, Altrincham Cheshire United Kingdom	Purchase			Qualified					2021-03-25
ASD004749	CM1127160-553	112716026		1067.0 Square Meter	HAUGHTON	St. Elizabeth		Haughton District, St. Elizabeth	Private	- Donovan Archibald Fearon Farmer of 5 Warburton Close, Hale Barns, Altrincham Cheshire United Kingdom	Purchase			Absolute					2021-03-25
ASD004750	CM1127160-553	112716027		814.0 Square Meter	HAUGHTON	St. Elizabeth		Haughton District, St. Elizabeth	Private	- Fabian Sean Lewis Truck Driver of 14 Balmoral Drive Brampton Ontario Canada	Possession			Absolute					2021-03-04
ASD005401	CM1127160-553	112716028		749.0 Square Meter	HAUGHTON	St. Elizabeth		Haughton, St. Elizabeth	Crown	- Commissioner of Lands of 20 North Street Kingston Jamaica	Special Provisions Act			Absolute					2021-09-17
ASD004751	CM1127160-553	112716030		975.0 Square Meter	HAUGHTON	St. Elizabeth		Haughton District, St. Elizabeth	Crown	- Commissioner of Lands of 20 North Street Kingston Jamaica	Special Provisions Act			Absolute					2021-03-04
ASD004752	CM1127160-553	112716031		1049.0 Square Meter	HAUGHTON	St. Elizabeth		Haughton District, St. Elizabeth	Private	- Ennever Duane Williams Farmer of Haughton District, Lacovia P.O. St. Elizabeth Jamaica	Possession			Absolute					2021-03-11
ASD004753	CM1127160-553	112716032		1049.0 Square Meter	HAUGHTON	St. Elizabeth		Haughton District, St. Elizabeth	Private	- Wilburn David Barton Retired School Principal of Haughton District, Maggotty P.O. St. Elizabeth Jamaica	Purchase			Absolute				- Receipt	2021-03-04
ASD004754	CM1127160-553	112716033		819.0 Square Meter	HAUGHTON	St. Elizabeth		Haughton District ,St. Elizabeth	Private	- Wilburn David Barton Retired School Principal of Haughton District, Maggotty P.O. St. Elizabeth Jamaica	Purchase			Absolute				- Receipt	2021-03-04
ASD005279	CM1127160-553	112716034		981.0 Square Meter	HAUGHTON	St. Elizabeth		Haughton District, St. Elizabeth	Crown	- Commissioner of Lands of 20 North Street Kingston Jamaica	Special Provisions Act			Absolute					2021-09-14
ASD004755	CM1127160-553	112716035		838.0 Square Meter	HAUGHTON	St. Elizabeth		Haughton District, St. Elizabeth	Private	- Velma Loleta Bent Retired Businesswoman of 19 Beadle Drive, Santa Cruz P.O. St. Elizabeth Jamaica	Possession			Absolute				- Property Tax Receipts	2021-03-04
ASD005233	CM1127160-553	112716036		1123.0 Square Meter	HAUGHTON	St. Elizabeth		Haughton District, St. Elizabeth	Crown	- Commissioner of Lands of 20 North Street Kingston Jamaica	Special Provisions Act			Absolute					2021-09-09
ASD004756	CM1127160-553	112716038		1211.0 Square Meter	HAUGHTON	St. Elizabeth		Haughton District, St. Elizabeth	Private	- Yvonne Olive Bennette Beckford Teacher of Lot 308 3 East 41Place 36 Way Greater Portmore St. Catherine Jamaica - Kamesha Lacarsh Anderson Practical Nurse of 518 Amanda Drive, Lithonia Georgia United States	Purchase			Absolute				- Agreement for Sale	2021-03-25
ASD004757	CM1127160-553	112716039		1054.0 Square Meter	HAUGHTON	St. Elizabeth		Haughton District, St. Elizabeth	Private	- Leonard Hopeton McLeod Farmer of Haughton District, Lacovia P.O. St. Elizabeth Jamaica	Purchase			Absolute				- Agreement for Sale - Receipt	2021-03-25
ASD004758	CM1127160-553	112716040		1023.0 Square Meter	HAUGHTON	St. Elizabeth		Haughton District, St. Elizabeth	Private	- Leonard Hopeton McLeod Farmer of Haughton District, Lacovia P.O. St. Elizabeth Jamaica	Purchase			Absolute				- Agreement for Sale - Receipt - Marriage Certificate	2021-03-25

<div><div><div><div>ADJUDICATION RECORD</div><div>PURSUANT TO SECTION 8A (1) (a) and 8A (1) (g) OF THE REGISTRATION OF TITLES CADASTRAL MAPPING AND TENURE CLARIFICATION (SPECIAL PROVISIONS) ACT</div></div></div></div>																			
SYSTEMATIC ADJUDICATION AREA : PARTS OF HAUGHTON, ST. ELIZABETH																			
APPLICATION NO.	LAND INFORMATION									PERSONAL DETAILS		OCCUPANCY DETAILS							
	CADASTRAL MAP NUMBER	CADASTRAL MAP PARCEL NUMBER	LAND VALUATION NUMBER	AREA	PLACE	PARISH	VOLUME/FOLIO	PROPERTY ADDRESS	NATURE OF PARCEL	OWNER(S) DETAILS	NATURE BY WHICH LAND WAS ACQUIRED	NATURE OF OWNER DISBAILITY	NAME, ADDRESS AND OCCUPATION OF GUARDIAN	NATURE OF TITLE	DETAILS OF ENCUMBRANCES	RESTRICTIONS ON POWER TO DEAL WITH LAND	DETAILS OF PERSON ENTITLED TO BENEFIT OF RESTRICTION	DOCUMENTS PRESENTED	DATE OF COMPLETION OF APPLICATION FORM
ASD004759	CM1127160-553	112716041		826.0 Square Meter	HAUGHTON	St. Elizabeth		Haughton District, St. Elizabeth	Private	- Leonard Hopeton McLeod Farmer of Haughton District, Lacovia P.O. St. Elizabeth Jamaica	Purchase			Absolute				- Agreement for Sale - Receipt	2021-03-25
ASD005090	CM1127160-553	112716042		1253.0 Square Meter	HAUGHTON	St. Elizabeth		Haughton District, St. Elizabeth	Crown	- Commissioner of Lands of 20 North Street Kingston Jamaica	Special Provisions Act			Absolute					2021-08-26
ASD005398	CM1127160-553	112716044		937.0 Square Meter	HAUGHTON	St. Elizabeth		Haughton District, St. Elizabeth	Crown	- Commissioner of Lands of 20 North Street Kingston Jamaica	Special Provisions Act			Absolute					2021-09-17
ASD005399	CM1127160-553	112716045		1149.0 Square Meter	HAUGHTON	St. Elizabeth		Haughton District, St. Elizabeth	Crown	- Commissioner of Lands of 20 North Street Kingston Jamaica	Special Provisions Act			Absolute					2021-09-17
ASD005650	CM1127160-553	112716047		919.0 Square Meter	HAUGHTON	St. Elizabeth		Haughton District, St. Elizabeth	Crown	- Commissioner of Lands of 20 North Street Kingston Jamaica	Special Provisions Act			Absolute					2021-09-22
ASD005097	CM1127160-553	112716048		1125.0 Square Meter	HAUGHTON	St. Elizabeth		Haughton, St. Elizabeth	Crown	- Commissioner of Lands of 20 North Street Kingston Jamaica	Special Provisions Act			Absolute					2021-08-26
ASD005418	CM1127160-553	112716049		1073.0 Square Meter	HAUGHTON	St. Elizabeth		Haughton, St. Elizabeth	Crown	- Commissioner of Lands of 20 North Street Kingston Jamaica	Special Provisions Act			Absolute					2021-09-17
ASD004760	CM1127160-553	112716050		403.0 Square Meter	HAUGHTON	St. Elizabeth		Haughton District, St. Elizabeth	Private	- Carl Adolphus Carnegie Farmer of Haughton District, Lacovia P.O. St. Elizabeth Jamaica	Purchase			Absolute				- Agreement for Sale - Receipt	2021-01-31
ASD005663	CM1127160-553	112716053		1036.0 Square Meter	HAUGHTON	St. Elizabeth		Haughton District, St. Elizabeth	Crown	- Commissioner of Lands of 20 North Street Kingston Jamaica	Special Provisions Act			Absolute					2021-09-22
ASD005654	CM1127160-553	112716054		903.0 Square Meter	HAUGHTON	St. Elizabeth		Haughton District, St. Elizabeth	Crown	- Commissioner of Lands of 20 North Street Kingston Jamaica	Special Provisions Act			Absolute					2021-09-22
ASD005656	CM1127160-553	112716055		1214.0 Square Meter	HAUGHTON	St. Elizabeth		Haughton District, St. Elizabeth	Private	- Olive Rose Marie Kelly Farmer of Nightingale Grove District, New Market P.O. St. Elizabeth Jamaica	Purchase			Absolute				- Survey Plan Examination No. : PE 434329 - Receipt	2021-09-22
ASD004761	CM1127160-553	112716056		1081.0 Square Meter	HAUGHTON	St. Elizabeth		Haughton District, St. Elizabeth	Private	- Shereen Elizabeth Townsend Home Health Aide of Haughton District, Lacovia P.O. St. Elizabeth Jamaica	Possession			Absolute				- Property Tax Receipts	2021-03-11
ASD005284	CM1127160-553	112716057		1011.0 Square Meter	HAUGHTON	St. Elizabeth		Haughton District, St. Elizabeth	Crown	- Commissioner of Lands of 20 North Street Kingston Jamaica	Special Provisions Act			Absolute					2021-09-14
ASD005659	CM1127160-553	112716058		773.0 Square Meter	HAUGHTON	St. Elizabeth		Haughton District, St. Elizabeth	Crown	- Commissioner of Lands of 20 North Street Kingston Jamaica	Special Provisions Act			Absolute					2021-09-22
ASD004762	CM1127160-553	112716059		174.0 Square Meter	HAUGHTON	St. Elizabeth		Haughton District, St. Elizabeth	Private	- Matthew Simon Lewis Farmer of Haughton District, Lacovia P.O. St. Elizabeth Jamaica	Possession			Absolute				- Property Tax Receipts - Last Will and Testament of : Henry Ivan Lewis - Grant of Administration : Henry Ivan Lewis	2021-01-30
ASD004763	CM1127160-553	112716060		1180.0 Square Meter	HAUGHTON	St. Elizabeth		Haughton District, St. Elizabeth	Private	- Sheldon Gregory Lewis Pharmacy Technician of 1643 SW 30th Street, Miramar Florida United States	Possession			Absolute				- Property Tax Receipts - Last Will and Testament of : Henry Ivan Lewis - Grant of Administration : Henry Ivan Lewis	2021-01-30
ASD004804	CM1127160-553	112716062		904.0 Square Meter	HAUGHTON	St. Elizabeth		Haughton District, St. Elizabeth	Private	- Patrick Leroy Lambert Retired Teacher of Haughton District, Lacovia P.O St. Elizabeth Jamaica	Possession			Absolute				- Property Tax Receipts	2021-06-09

<div><div><div>ADJUDICATION RECORD</div><div>PURSUANT TO SECTION 8A (1) (a) and 8A (1) (g) OF THE REGISTRATION OF TITLES CADASTRAL MAPPING AND TENURE CLARIFICATION (SPECIAL PROVISIONS) ACT</div></div></div>																			
SYSTEMATIC ADJUDICATION AREA : PARTS OF HAUGHTON, ST. ELIZABETH																			
APPLICATION NO.	LAND INFORMATION									PERSONAL DETAILS		OCCUPANCY DETAILS							
	CADASTRAL MAP NUMBER	CADASTRAL MAP PARCEL NUMBER	LAND VALUATION NUMBER	AREA	PLACE	PARISH	VOLUME/FOLIO	PROPERTY ADDRESS	NATURE OF PARCEL	OWNER(S) DETAILS	NATURE BY WHICH LAND WAS ACQUIRED	NATURE OF OWNER DISABILITY	NAME, ADDRESS AND OCCUPATION OF GUARDIAN	NATURE OF TITLE	DETAILS OF ENCUMBRANCES	RESTRICTIONS ON POWER TO DEAL WITH LAND	DETAILS OF PERSON ENTITLED TO BENEFIT OF RESTRICTION	DOCUMENTS PRESENTED	DATE OF COMPLETION OF APPLICATION FORM
ASD005402	CM1127160-553	112716067		892.0 Square Meter	HAUGHTON	St. Elizabeth		Haughton District, St. Elizabeth	Private	- Nadia Monique Irving Unemployed of 74 Caroline Avenue, Elmont New York United States	Possession			Absolute					2021-09-17
ASD005274	CM1127160-553	112716068		899.0 Square Meter	HAUGHTON	St. Elizabeth		Haughton District, St. Elizabeth	Private	- Winsome Verona Gooden Retired Teacher of Reading District, Lacovia P.O. St. Elizabeth Jamaica	Possession			Absolute					2021-09-14
ASD005283	CM1127160-553	112716069		856.0 Square Meter	HAUGHTON	St. Elizabeth		Haughton District, St. Elizabeth	Private	- Sharon Anicitia Miller Registered Nurse of Haughton District, Lacovia P.O. St. Elizabeth Jamaica - Cicely Emmane Beckford Computer Scientist of Haughton District, Lacovia P.O. St. Elizabeth Jamaica	Possession			Absolute					2021-09-14
ASD004765	CM1127160-553	112716070		783.0 Square Meter	HAUGHTON	St. Elizabeth		Haughton District, St. Elizabeth	Private	- Lorrett Marcia Vanhorn Farmer of Haughton District, Lacovia P.O. St. Elizabeth Jamaica	Possession			Absolute					2021-03-11
ASD005660	CM1127160-553	112716073		871.0 Square Meter	HAUGHTON	St. Elizabeth		Haughton District, St. Elizabeth	Crown	- Commissioner of Lands of 20 North Street Kingston Jamaica	Special Provisions Act			Absolute					2021-09-22
ASD005096	CM1127160-553	112716074		656.0 Square Meter	HAUGHTON	St. Elizabeth		Haughton, St. Elizabeth	Crown	- Commissioner of Lands of 20 North Street Kingston Jamaica	Special Provisions Act			Absolute					2021-08-26
ASD005454	CM1127160-553	112716077		1270.0 Square Meter	HAUGHTON	St. Elizabeth		Haughton District, St. Elizabeth	Private	- Harriette Davidson Businesswoman of Haughton District, Lacovia P.O. St. Elizabeth Jamaica				Absolute					2021-09-19
ASD005450	CM1127160-553	112716080		620.0 Square Meter	HAUGHTON	St. Elizabeth		Haughton District, St. Elizabeth	Crown	- Commissioner of Lands of 20 North Street Kingston Jamaica	Special Provisions Act			Absolute					2021-09-19
ASD005452	CM1127160-553	112716081		591.0 Square Meter	HAUGHTON	St. Elizabeth		Haughton District, St. Elizabeth	Crown	- Commissioner of Lands of 20 North Street Kingston Jamaica	Special Provisions Act			Absolute					2021-09-19
ASD004767	CM1127161-538	112716102		1071.0 Square Meter	HAUGHTON	St. Elizabeth		Haughton District, St. Elizabeth	Private	- Garfield Nathaniel Williams Alias Pecka Farmer of Haughton District, Lacovia P.O. St. Elizabeth Jamaica	Possession			Absolute					2021-03-20
ASD005176	CM1127161-538	112716104		1050.0 Square Meter	HAUGHTON	St. Elizabeth		Haughton District, St. Elizabeth	Crown	- Commissioner of Lands of 20 North Street Kingston Jamaica	Special Provisions Act			Absolute					2021-09-07
ASD005315	CM1127161-538	112716106		1196.0 Square Meter	HAUGHTON	St. Elizabeth		Haughton District, St. Elizabeth	Crown	- Commissioner of Lands of 20 North Street Kingston Jamaica	Special Provisions Act			Absolute					2021-09-15
ASD004769	CM1127161-538	112716107		1071.0 Square Meter	HAUGHTON	St. Elizabeth		Haughton District, St. Elizabeth	Private	Iva Condetta Wallace Retired of 29 Dequincey House, Lupus Street, Pinlico London, United Kingdom	Purchase			Absolute					2021-04-22
ASD004770	CM1127161-538	112716109		1024.0 Square Meter	HAUGHTON	St. Elizabeth		Haughton District, St. Elizabeth	Private	- Paul Smith Social Worker of Haughton District Lacovia P.O. St. Elizabeth Jamaica	Purchase			Absolute				- Agreement for Sale	2021-06-10
ASD005669	CM1127161-538	112716110		1485.0 Square Meter	HAUGHTON	St. Elizabeth		Haughton District, St. Elizabeth	Private	- Clinton Richard Clarke Farmer of Haughton District, Lacovia P.O. St. Elizabeth Jamaica	Possession			Qualified				- Property Tax Receipts	2021-09-22
ASD005652	CM1127161-538	112716111		441.0 Square Meter	HAUGHTON	St. Elizabeth		Haughton District, St. Elizabeth	Private	- Marva Seaton Carer of Haughton District Lacovia P.O. St. Elizabeth Jamaica	Purchase			Absolute				- Property Tax Receipts - Receipt	2021-09-22
ASD004773	CM1127161-538	112716112		331.0 Square Meter	HAUGHTON	St. Elizabeth		Haughton District, St. Elizabeth	Private	- Dorrett Thyndel Care giver of Haughton District Lacovia P.O. St. Elizabeth Jamaica	Possession			Qualified				- Survey Plan Examination No. : Quitclaim Deed, Parish Council Development Order	2021-06-10
ASD004775	CM1127161-538	112716113		936.0 Square Meter	HAUGHTON	St. Elizabeth		Haughton District, St. Elizabeth	Private	- Richard Wright Farmer of Haughton District Lacovia P.O. St. Elizabeth Jamaica	Possession			Absolute	Right of Way				2021-06-10
ASD005641	CM1127161-538	112716114		1030.0 Square Meter	HAUGHTON	St. Elizabeth		Haughton District, St. Elizabeth	Private	- Hubert Wright Farmer of Haughton District, Lacovia P.O. St. Elizabeth Jamaica	Purchase			Absolute				- Receipt	2021-09-22

<div><div><div>ADJUDICATION RECORD</div><div>PURSUANT TO SECTION 8A (1) (a) and 8A (1) (g) OF THE REGISTRATION OF TITLES CADASTRAL MAPPING AND TENURE CLARIFICATION (SPECIAL PROVISIONS) ACT</div></div></div>																			
SYSTEMATIC ADJUDICATION AREA : PARTS OF HAUGHTON, ST. ELIZABETH																			
APPLICATION NO.	LAND INFORMATION									PERSONAL DETAILS		OCCUPANCY DETAILS							
	CADASTRAL MAP NUMBER	CADASTRAL MAP PARCEL NUMBER	LAND VALUATION NUMBER	AREA	PLACE	PARISH	VOLUME/FOLIO	PROPERTY ADDRESS	NATURE OF PARCEL	OWNER(S) DETAILS	NATURE BY WHICH LAND WAS ACQUIRED	NATURE OF OWNER DISABILITY	NAME, ADDRESS AND OCCUPATION OF GUARDIAN	NATURE OF TITLE	DETAILS OF ENCUMBRANCES	RESTRICTIONS ON POWER TO DEAL WITH LAND	DETAILS OF PERSON ENTITLED TO BENEFIT OF RESTRICTION	DOCUMENTS PRESENTED	DATE OF COMPLETION OF APPLICATION FORM
ASD004777	CM1127161-538	112716115		810.0 Square Meter	HAUGHTON	St. Elizabeth		Haughton District, St. Elizabeth	Private	- Granville Palmer Farmer of Haughton District Lacovia P.O. St. Elizabeth Jamaica - Delores Palmer Farmer of Haughton District Lacovia P.O. St. Elizabeth Jamaica	Possession			Absolute					2021-06-10
ASD004805	CM1127161-538	112716116		1237.0 Square Meter	HAUGHTON	St. Elizabeth		Haughton District, St. Elizabeth	Private	- Sharon Eurina Thomas Household Helper of Thornton District Thornton P.A. St. Elizabeth Jamaica	Gift			Absolute	Right of Way				2021-06-10
ASD004778	CM1127161-538	112716117		1297.0 Square Meter	HAUGHTON	St. Elizabeth		Haughton District, St. Elizabeth	Private	- Burnett Williams Farmer of Haughton District, Lacovia P.O. St. Elizabeth Jamaica	Possession			Absolute				- Surveyors Identification Report	2021-02-02
ASD004780	CM1127161-538	112716118		1076.0 Square Meter	HAUGHTON	St. Elizabeth		Haughton District, St. Elizabeth	Private	- Ervin Foster Farmer of Haughton District Lacovia P.O. St. Elizabeth Jamaica - Sandra Maureen Watson-Foster Farmer of Cuffies Pen District Lacovia P.O. St. Elizabeth Jamaica	Possession			Absolute					2021-06-10
ASD004781	CM1127161-538	112716119		964.0 Square Meter	HAUGHTON	St. Elizabeth		Haughton District, St. Elizabeth	Private	- Ted Richard Morris Farmer of Haughton District Lacovia P.O. St. Elizabeth Jamaica	Possession			Absolute				- Property Tax Receipts	2021-02-10
ASD004782	CM1127161-538	112716120		1038.0 Square Meter	HAUGHTON	St. Elizabeth		Haughton District, St. Elizabeth	Private	- Burnett Williams Farmer of Haughton District, Lacovia P.O. St. Elizabeth Jamaica	Possession			Absolute				- Surveyors Identification Report	2021-02-02
ASD004784	CM1127161-538	112716121		1023.0 Square Meter	HAUGHTON	St. Elizabeth		Haughton District, St. Elizabeth	Private	- Nigel Powell Farmer of Haughton District, Lacovia P.O. St. Elizabeth Jamaica	Possession			Absolute				- Survey Plan Examination No. : property tax receipts	2021-06-10
ASD005668	CM1127161-538	112716122		650.0 Square Meter	HAUGHTON	St. Elizabeth		Haughton District, St. Elizabeth	Private	- Elvis Wright Farmer of Haughton District, Lacovia P.O. St. Elizabeth Jamaica	Inheritance			Absolute				- Survey Plan Examination No. : 343175 - Property Tax Receipts	2021-09-22
ASD004786	CM1127161-538	112716124		1066.0 Square Meter	HAUGHTON	St. Elizabeth		Haughton District, St. Elizabeth	Private	- Jennifer Eldoris Gayle Businesswoman of Haughton District Lacovia P.O. St. Elizabeth Jamaica - Dwayne Gayle Unemployed of 17 Newton Avenue Bridgeport Bridgeport PO St. Catherine Jamaica - Jason Gayle Farmer of Haughton District Lacovia P.O. St. Elizabeth Jamaica - Shane Gayle Taxi Driver of Haughton District, Lacovia P.O. St. Elizabeth Jamaica	Possession			Absolute				- Surveyors Identification Report	2021-06-10
ASD004787	CM1127161-538	112716125		4909.0 Square Meter	HAUGHTON	St. Elizabeth		Haughton District, St. Elizabeth	Private	- Burnett Williams Farmer of Haughton District, Lacovia P.O. St. Elizabeth Jamaica	Possession			Absolute				- Surveyors Identification Report	2021-02-02
ASD005316	CM1127161-538	112716127		531.0 Square Meter	HAUGHTON	St. Elizabeth		Haughton District, St. Elizabeth	Crown	- Commissioner of Lands of 20 North Street Kingston Jamaica	Special Provisions Act			Absolute					2021-09-15
ASD004790	CM1127161-538	112716128		809.0 Square Meter	HAUGHTON	St. Elizabeth		Haughton District, St.Elizabeth	Private	- Sophia StacyAnn Lindsay Household Technician of Haughton District Lacovia P.O. St. Elizabeth Jamaica	Possession			Absolute					2021-06-10
ASD004792	CM1127161-538	112716129		353.0 Square Meter	HAUGHTON	St. Elizabeth		Haughton District, St. Elizabeth	Private	- Gloria Loveta Dixon Retired Cook of Haughton District Lacovia P.O. St. Elizabeth Jamaica	Possession			Absolute					2021-06-10
ASD004793	CM1127161-538	112716130		2029.0 Square Meter	HAUGHTON	St. Elizabeth		Haughton District, St. Elizabeth	Private	- John Orily Muirhead Farmer of Thornton District Thornton P.A. St. Elizabeth Jamaica - Joy Elaine . Farmer of Haughton District, Lacovia P.O. St. Elizabeth Jamaica	Possession			Absolute				- Agreement for Sale	2021-03-20



ADJUDICATION RECORD

PURSUANT TO SECTION 8A (1) (a) and 8A (1) (g) OF THE
REGISTRATION OF TITLES CADASTRAL MAPPING AND TENURE CLARIFICATION (SPECIAL PROVISIONS) ACT

SYSTEMATIC ADJUDICATION AREA : PARTS OF HAUGHTON, ST. ELIZABETH

APPLICATION NO.	CADASTRAL MAP NUMBER	CADASTRAL MAP PARCEL NUMBER	LAND INFORMATION						PERSONAL DETAILS		OCCUPANCY DETAILS									
			LAND VALUATION NUMBER	AREA	PLACE	PARISH	VOLUME/FOLIO	PROPERTY ADDRESS	NATURE OF PARCEL	OWNER(S) DETAILS	NATURE BY WHICH LAND WAS ACQUIRED	NATURE OF OWNER DISBAILITY	NAME, ADDRESS AND OCCUPATION OF GUARDIAN	NATURE OF TITLE	DETAILS OF ENCUMBRANCES	RESTRICTIONS ON POWER TO DEAL WITH LAND	DETAILS OF PERSON ENTITLED TO BENEFIT OF RESTRICTION	DOCUMENTS PRESENTED	DATE OF COMPLETION OF APPLICATION FORM	
ASD004801	CM1127161-538	112716131		951.0 Square Meter	HAUGHTON	St. Elizabeth		Haughton District, St. Elizabeth	Private	- Egbert Jeremiah Anderson Retired Information Officer of Haughton District Lacovia P.O. St. Elizabeth Jamaica	Possession				Absolute				2021-03-04	
ASD005666	CM1127161-538	112716132		4.0896 Hectare	HAUGHTON	St. Elizabeth		Haughton District, St. Elizabeth	Private	- Marcia Greene Medical Secretary/ Assistant Manager of 33 Frampton Road, Potters Bar Hertfordshire United Kingdom - Brian Greene Work Islington Council Grounds Maintenance of 236 Craven Park Road, Tottenham London United Kingdom - Jane Adair Project Manager of The School House, Battle Street, Clayhidon, Cullompton, Devon United Kingdom - Jason Shaun Greene Carpenter of 1-3 Ashbourne Parade London United Kingdom	Possession				Qualified					2021-09-22
ASD005634	CM1127161-538	112716133		132.0 Square Meter	HAUGHTON	St. Elizabeth		Haughton District, St. Elizabeth	Private	- Kaye Morris Housekeeper of Prospect District, Prospect P.A St. Elizabeth Jamaica	Purchase				Absolute			- Receipt	2021-09-22	
ASD005638	CM1127161-538	112716134		2012.0 Square Meter	HAUGHTON	St. Elizabeth		Haughton District, St. Elizabeth	Private	- John Muirhead Farmer of Thornton District, Thornton P.A St. Elizabeth Jamaica	Purchase				Absolute				2021-09-22	

This Adjudication Record is comprised of an Adjudication Register of claims to ownership rights and interests in parcels of land and a Cadastral Map. Some parcels have been excluded from the Adjudication Record as a result of requests for further subdivision of parcels, encroachments, parcels already registered etc.

The Adjudication Record was displayed in the Systematic Adjudication Area on **October 1, 2021** and shall remain on display for a period of THIRTY (30) days.

During this period, the Senior Director, Adjudication Services may amend any minor error or omission not materially affecting the interest of any person. Therefore, any Applicant who considers the Adjudication Record to be contain minor inaccuracies or omissions, may within THIRTY (30) days of the date of display of the Adjudication Record, submit the details of such inaccuracies or omissions in the prescribed Form and manner.

Any person who objects to an Applicant's claim to ownership rights and interests in a parcel of land on the Adjudication Record, may within THIRTY (30) days of the date of display of the said Record submit the grounds for objection in the prescribed Form and manner.

The prescribed Forms (Amendment of the Adjudication Record or Objection to the Adjudication Record) are available at any National Land Agency office or via the Agencies website at: www.nla.gov.jm

All Requests for Amendment of the Adjudication Record or Objection to the Adjudication Record must be submitted using the prescribed Form to the Senior Director, Adjudication Services at:

National Land Agency
8 Ardenne Road
Kingston 10
Saint Andrew

Display Date: **October 1, 2021**



Senior Director, Adjudication Services:

HAUGHTON ADJUDICATION RECORD

Scale 1:1000 Cadastral Map

JAMAICA

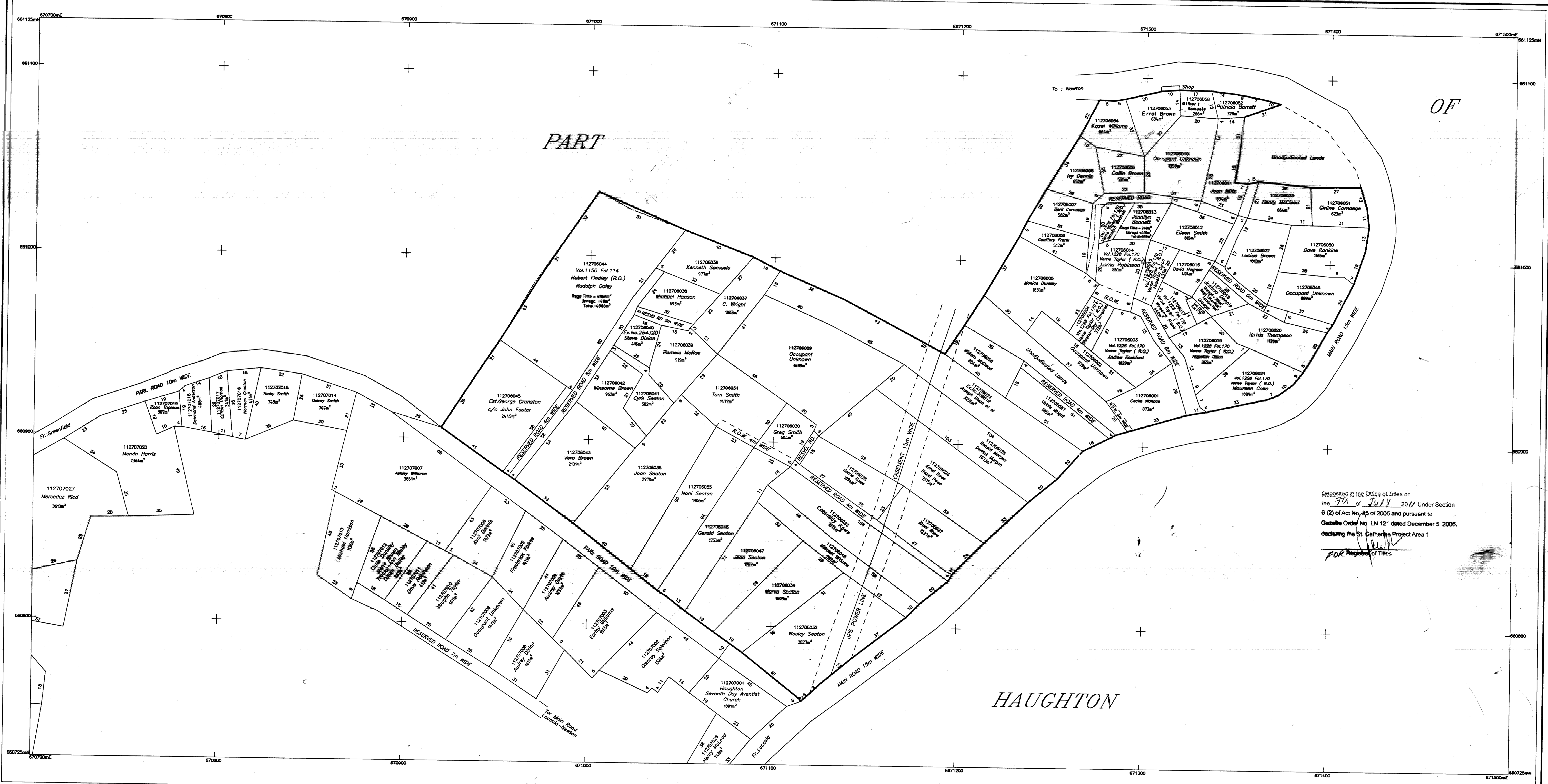
LAMP BLOCK 27 - SHEET 60



Deposited in the Office of Titles on the 7th of July 2011 Under Section 6 (2) of Act No. 25 of 2005 and pursuant to Gazette Order No. LN 121 dated December 5, 2008, declaring the St. Catherine Project Area 1.

FOR Register of Titles

LEGEND

Volume and Folio
Property Boundary
Deposited Plan Boundary
Culley Drain/River
Registered Boundary

SURVEY DATUM : JAD2001

Projection: Lambert Conical Orthographic with one Standard Parallel
Spheroid: WGS 84
Unit of Measurement: Meters
Origin: 77 00 W of Greenwich
False Co-ordinates of Origin: 18 00 N of the Equator
Scale Factor at Origin: 1.000

Certified that the area delineated on this map form part of LAMP St. Elizabeth Project Area 1
Gazetted at Order No. LN 121 dated July 20, 2009
Dated the 14th of March 2011

Signature
Surveyor

SCALE : 1cm To 10m R.F. 1/1000
GRID INTERVAL 100m

CADAstral MAP
PART OF
HAUGHTON
ST. ELIZABETH



Compiled by GEOLAND Ltd.
from Plans annexed to Registered Titles, Plans by the Survey Department, Cadastral Records certified by the Survey Department and Field observation of Property boundaries.
Compilation Date: November 2010
Users noting errors or omissions are asked to return maps to the Survey and Mapping Division and it will be replaced.

JADMAP
CHECKED
Date 2011/03/14

Parcel Count Table	
No. of Characteristics Parcels	2
No. of Registered Parcels	55
Total no. of Parcels	57

Example of Parcel Numbering	
Parish	11
Block	27
Sheet	060
Parcel	41
Parcel #	112606041

SURVEYORS: *Signature*
PATRICK HENDRICKS
COMMISSIONED LAND SURVEYOR
GEOLAND TITLE LIMITED

DATE : 2011/03/14

PREPARED BY
GEOLAND TITLE LIMITED
2 BELMONT ROAD
KINGSTON 5
TEL. 876 908-0192

GEOLAND
TITLE LIMITED

L 11 27 060 CM 1703219

1127070-476

476

Scale 1:1000 Cadastral Map

JAMAICA

LAMP BLOCK 27 - SHEET 70

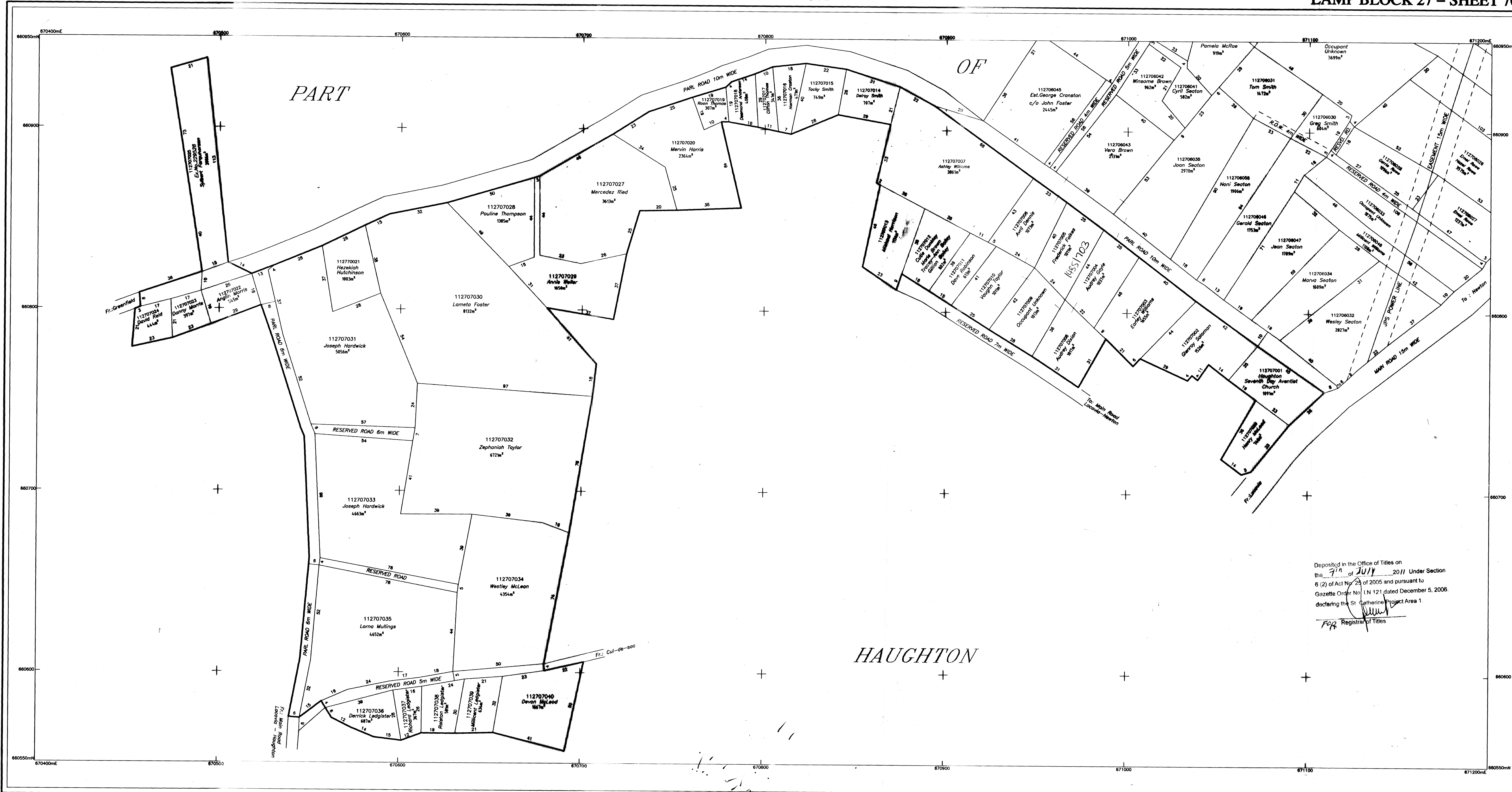

Deposited in the Office of Titles on the 21st of July 2011 Under Section 8 (2) of Act No. 22 of 2005 and pursuant to Gazette Order No. LN 121 dated December 5, 2006 declaring the St. Catherine Project Area 1.

FOR Registrar of Titles

Certified that the area delineated on this map form part of LAMP St. Elizabeth Project Area 1
Gazetted at Order No. LN 121 dated July 20, 2009
Dated the 14th of March 2011

Director of Survey

metres 10 0 10 20 30 40 50 60 70 80 90 100 110 metres

SCALE: 1cm To 10m R.F. 1/1000
GRID INTERVAL 100m

CADAstral MAP
PART OF
HAUGHTON
ST. ELIZABETH

GN



Compiled by GEOLAND Ltd.
from Plans annexed to Registered Titles, Plans
by the Survey Department, Cadastral Records
certified of the Survey Department and Field
observation of Property boundaries.

Compilation Date: November 2010

Users noting errors or omissions are asked
to return map to the Survey and Mapping
Division and it will be replaced.

CHECKED
For Director of Survey
Date: 20/11/2011

Parcel Count Table	
No. of Classification Parcels	0
No. of Registration Parcels	40
Total no. of Parcels	40

Example of Parcel Numbering

Parish	11		
Block	27		
Sheet		070	
Parcel			41
Parcel #	112707041		

SURVEYORS: *Patrick Hendricks*
PATRICK HENDRICKS
COMMISSIONED LAND SURVEYOR
GEOLAND TITLE LIMITED

DATE: 20/11/2011

PREPARED BY
GEOLAND TITLE LIMITED
2 BELMONT ROAD
KINGSTON 5
TEL. 876 908-0182

GEOLAND
TITLE LIMITED

LEGEND
Volume and Folio ----- 1084/747
Property Boundary -----
Deposited Plan Boundary -----
Gully/Drain/River -----
Registered Boundary -----

SURVEY DATUM: JAD2001

Projection: Lambert Conformal Orthomorphic with
one Standard Parallel WGS 84
Spheroid: Unit of Measurement: Metres
Origin: 77 00 W of Greenwich
18 00 N of the Equator
False Co-ordinates of Origin: 750 000m Easting
850 000m Northing
Scale Factor at Origin: 1.000

1127160-553

Scale 1:1000 Cadastral Map

JAMAICA

LAMP BLOCK 27 - SHEET 160

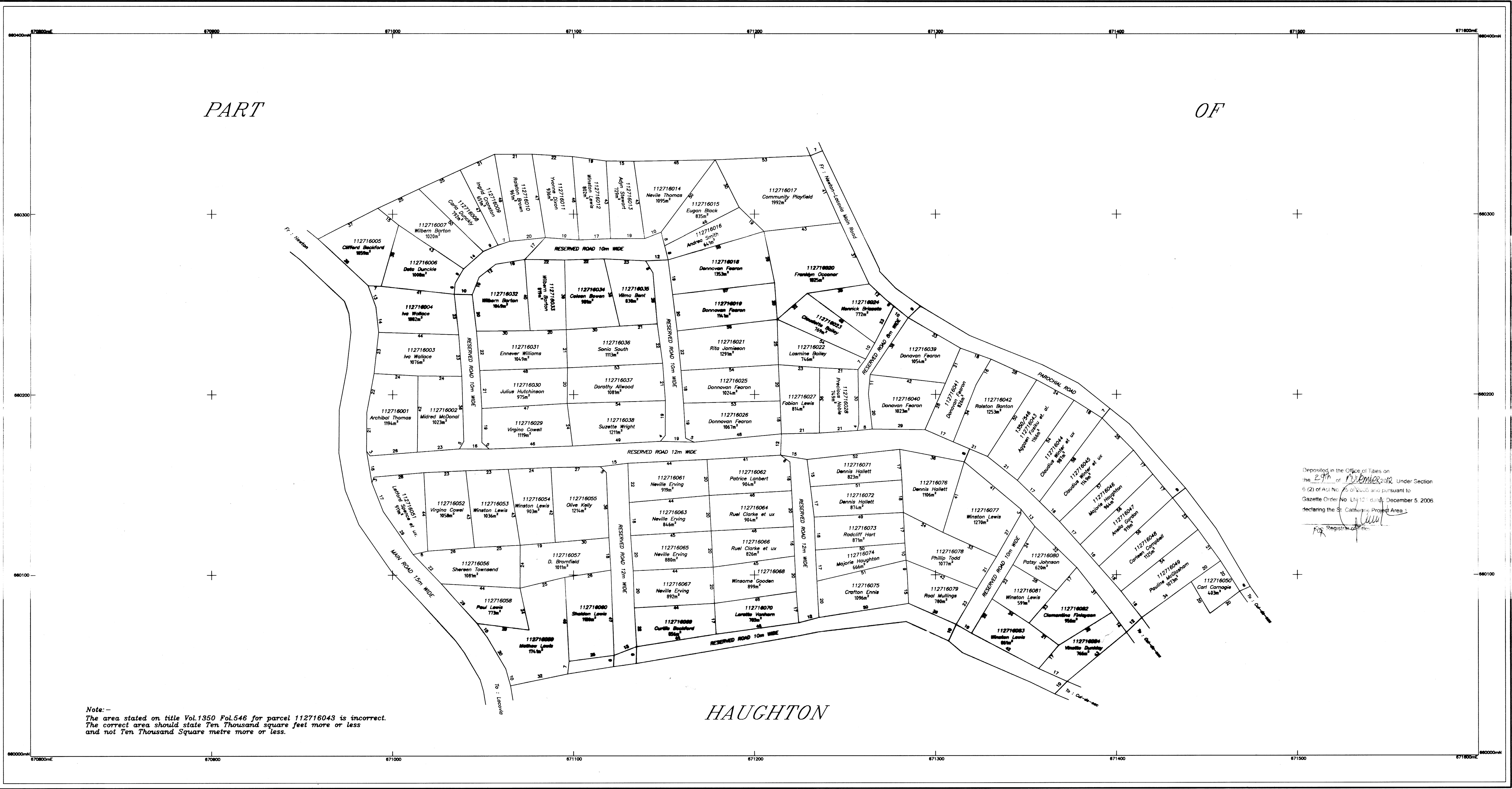

CMI 1794760

L 11 27 160

LEGEND
Volume and Folio
Property Boundary
Deposited Plan Boundary
Gully/Drain/River
Registered Boundary

SURVEY DATUM : JAD2001
Projection: Lambert Conformal Orthomorphic with one Standard Parallel
Spheroid: WGS 84
Unit of Measurement: Metres
Origin: 77 00 W of Greenwich
18 00 N of the Equator
False Co-ordinates of Origin: 750 000m Easting
650 000m Northing
Scale Factor at Origin: 1.000

Certified that the area delineated on this map form part of LAMP St Elizabeth Project Area 1
Gazetted at Order No. dated July 20, 2009
Dated the 16th day of January 2012
Director of Survey

CADASTRAL MAP
PART OF
HAUGHTON
ST. ELIZABETH

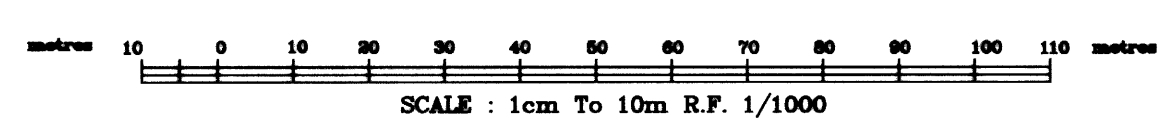

Compiled by GEOLAND Ltd. from Plans annexed to Registered Titles, Plans by the Survey Department, Cadastral Records certified of the Survey Department and Field observation of Property boundaries.
Compilation Date: January 2011
Users noting errors or omissions are asked to return map to the Survey and Mapping Division and it will be replaced.

NLA CADMAP CHECKED
For Director of Survey
Date: 2012/01/16

No. of Certification Parcels	1
No. of Registration Parcels	83
Total no. of Parcels	84

Example of Parcel Numbering			
Parish	11		
Block	27		
Sheet		160	
Parcel			41
Parcel #	112716041		

SURVEYORS : Patrick Hendricks
PATRICK HENDRICKS
COMMISSIONED LAND SURVEYOR
GEOLAND TITLE LIMITED
DATE: 2011/12/05

PREPARED BY
GEOLAND TITLE LIMITED
2 BELMONT ROAD
KINGSTON 5
TEL. 876 908-0192



CM 1127161-538

Scale 1:1,500 Cadastral Map

JAMAICA

LAMP BLOCK 27 - SHEET 161

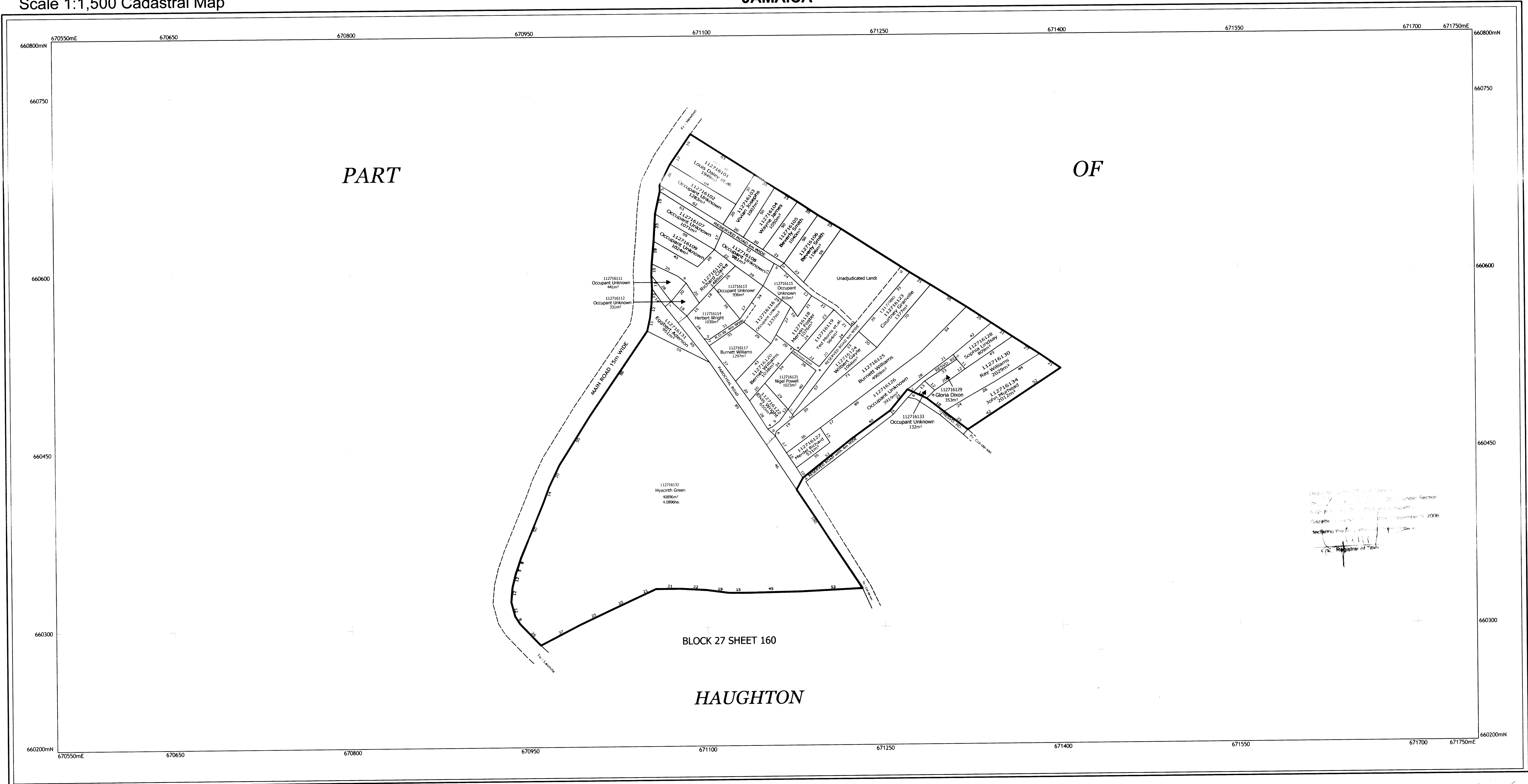

Deposited in the Office of the Surveyor General, Jamaica, on the 20th day of April 2012, and pursuant to the provisions of the Survey Act, Chapter 2:01, of the Laws of Jamaica, 1999, and the provisions of the Survey Regulations, 2006, the Surveyor General has caused this map to be registered in the Office of the Surveyor General, Jamaica, on the 20th day of April 2012.

1127161

LEGEND

Volume and Folio 1234/567
Property Boundary
Deposited Plan Boundary
Gully/Drain/River
Registered Boundary

SURVEY DATUM : JAD2001

Projection: Lambert Conformal Conic with one Standard Parallel (18°E)
Spheroid: WGS84 (JAD2001 National Grid System)
Unit of Measurement: Metre
Origin: 77°E 00' 00" W of Greenwich
False Co-ordinates of Origin: 18°E 00' 00" N of the Equator
Scale Factor at Origin: 750,000m Easting
650,000m Northing
1.000

Certified true and correct copy of the original map as deposited in the Office of the Surveyor General, Jamaica, on the 20th day of April 2012, and pursuant to the provisions of the Survey Act, Chapter 2:01, of the Laws of Jamaica, 1999, and the provisions of the Survey Regulations, 2006, the Surveyor General has caused this map to be registered in the Office of the Surveyor General, Jamaica, on the 20th day of April 2012.

CADAstral MAP
PART OF
HAUGHTON
St. Elizabeth

metres 30 15 0 30 60 90 120 150 metres
SCALE : 1cm To 15m R.F. 1/1500
GRID INTERVAL 150m



Compiled by GEOLAND Ltd. from Plans annexed to Registered Titles. Plans by the Survey Department, Cadastral Records certified of the Survey Department and Field observation of Property boundaries.
Compilation Date: 25 March, 2011
Users noting errors or omissions are asked to Return map to the Surveys and Mapping Division and it will be replaced.

NLA CADMAP
CHECKED

For Director of Surveys
Date 2012/04/30

Parcel Count Table	
No. of Clarification Parcels	2
No. of Regularisation Parcels	32
Total no. of Parcels	34

Example of Parcel Numbering

Parish	11
Block	27
Sheet	161
Parcel	35
Parcel #	112716135

PREPARED BY
GEOLAND TITLE LIMITED
52-60 GRENADA CRESCENT
KINGSTON 5
St. Andrew, Jamaica, W.I.
TEL. 876 908-0192



SURVEYOR
PATRICK HENDRICKS
COMMISSIONED LAND SURVEYOR
GEOLAND TITLE LIMITED
DATE: _____