



<div><div></div><div>ADJUDICATION RECORD PURSUANT TO SECTION 8A (1) (e) and 8A (1) (g) OF THE REGISTRATION OF TITLES CADASTRAL MAPPING AND TENURE CLARIFICATION (SPECIAL PROVISIONS) ACT</div></div>																			
SYSTEMATIC ADJUDICATION AREA : PARTS OF CARLISLE AND RED BANK PART I (PART 10)																			
	LAND INFORMATION									PERSONAL DETAILS	OCCUPANCY DETAILS								
APPLICATION NO.	CADASTRAL MAP NUMBER	CADASTRAL MAP PARCEL NUMBER	LAND VALUATION NUMBER	AREA	PLACE	PARISH	VOLUME/FOLIO	PROPERTY ADDRESS	NATURE OF PARCEL	OWNER(S) DETAILS	NATURE BY WHICH LAND WAS ACQUIRED	NATURE OF OWNER DISABILITY	NAME, ADDRESS AND OCCUPATION OF GUARDIAN	NATURE OF TITLE	DETAILS OF ENCUMBRANCES	RESTRICTIONS ON POWER TO DEAL WITH LAND	DETAILS OF PERSON ENTITLED TO BENEFIT OF RESTRICTION	DOCUMENTS PRESENTED	DATE OF COMPLETION OF APPLICATION FORM
ASD009464	CM1133006-814	113300608		5234.288 Square Meter	RED BANK	St. Elizabeth		Red Bank District, St. Elizabeth	Crown	- Commissioner of Lands of 20 North Street Kingston Jamaica	Special Provisions Act			Absolute					2022-01-19
ASD009263	CM1133006-814	113300609		1813.491 Square Meter	RED BANK	St. Elizabeth		Red Bank District, St. Elizabeth	Private	- Denvil Evans Farmer of Red Bank District, Red Bank P.A. St. Elizabeth Jamaica	Possession			Absolute					2022-01-19
ASD009232	CM1133006-814	113300610		1433.174 Square Meter	RED BANK	St. Elizabeth		Red Bank District, St. Elizabeth	Private	- Carl Brooks Farmer of Red Bank District, Red Bank P.A. St. Elizabeth Jamaica	Possession			Absolute					2022-01-19
ASD009295	CM1133006-814	113300611		7608.289 Square Meter	RED BANK	St. Elizabeth		Red Bank District, St. Elizabeth	Private	- Ettle Brooks Farmer of Red Bank District, Red Bank P.A. St. Elizabeth Jamaica - Coral Sailsman Dressmaker of Red Bank District, Red Bank P.A. St. Elizabeth Jamaica	Possession			Absolute					2022-01-19
ASD009294	CM1133006-814	113300612		4834.8 Square Meter	RED BANK	St. Elizabeth		Red Bank District, St. Elizabeth	Private	- Garrick Witter Farmer of Red Bank District, Red Bank P.O. St. Elizabeth Jamaica	Possession			Absolute					2022-01-19
ASD009383	CM1133006-814	113300613		1930.337 Square Meter	RED BANK	St. Elizabeth		Red Bank District, St. Elizabeth	Private	- Junior Roy Bent Taxi Operator of Greenvale District, Mandeville P.O. Manchester Jamaica - Latoya Bent Farmer of Red Bank District, Red Bank P.A. St. Elizabeth Jamaica - Tishann Bent-Morgan Accounting Clerk of Comma Pen District, Comma Pen P.A. St. Elizabeth Jamaica	Possession			Absolute					2022-01-19
ASD009227	CM1133006-814	113300614		861.011 Square Meter	RED BANK	St. Elizabeth		Red Bank District, St. Elizabeth	Private	- Eric Swaby Farmer of Red Bank District, Red Bank P.A St. Elizabeth Jamaica	Possession			Absolute					2022-01-19
ASD009192	CM1133006-814	113300615		1387.696 Square Meter	RED BANK	St. Elizabeth		Red Bank District, St. Elizabeth	Private	- Carol Sailsman Dressmaker of Red Bank District, Red Bank P.A. St. Elizabeth Jamaica	Possession			Absolute	FALSE				2022-01-19
ASD009313	CM1133006-814	113300616		1017.61 Square Meter	RED BANK	St. Elizabeth		Red Bank District, St. Elizabeth	Private	- Brenton Delroy Brooks Plumber of Melsham District, Red Bank P.A St. Elizabeth Jamaica	Possession			Absolute	Right of Way				2022-01-19
ASD009191	CM1133006-814	113300617		812.104 Square Meter	RED BANK	St. Elizabeth		Red Bank District, St. Elizabeth	Private	- Albert Erskin Faulknor Farmer of Red Bank District, Red Bank P.A. St. Elizabeth Jamaica	Possession			Absolute					2022-01-19
ASD009234	CM1133006-814	113300618		1541.567 Square Meter	RED BANK	St. Elizabeth		Red Bank District, St. Elizabeth	Private	- Ilene May-Adassa Faulknor Retired Domestic Helper of Red Bank District, Red Bank P.A St. Elizabeth Jamaica	Possession			Absolute	Right of Way				2022-01-19
ASD009377	CM1133006-814	113300619		947.616 Square Meter	RED BANK	St. Elizabeth		Red Bank District, St. Elizabeth	Private	- Valrie Ann-Marie Brooks Farmer of Red Bank District, Red Bank P.A St. Elizabeth Jamaica	Possession			Absolute	Right of Way				2022-01-19
ASD009382	CM1133006-814	113300620		593.954 Square Meter	RED BANK	St. Elizabeth		Red Bank District, St. Elizabeth	Private	- Eric Brooks Contractor of Red Bank District, Red Bank P.A St. Elizabeth Jamaica	Possession			Absolute					2022-01-19
ASD009242	CM1133006-814	113300621		305.887 Square Meter	RED BANK	St. Elizabeth		Red Bank District, St. Elizabeth	Private	- Olyn Decordova Brooks Farmer of Red Bank District, Red Bank P.A St. Elizabeth Jamaica	Possession			Absolute					2022-01-19
ASD009240	CM1133006-814	113300622		768.086 Square Meter	RED BANK	St. Elizabeth		Red Bank District, St. Elizabeth	Private	- Olyn Decordova Brooks Farmer of Red Bank District, Red Bank P.A St. Elizabeth Jamaica	Possession			Absolute					2022-01-19



ADJUDICATION RECORD

PURSUANT TO SECTION 8A (1) (e) and 8A (1) (g) OF THE

REGISTRATION OF TITLES CADASTRAL MAPPING AND TENURE CLARIFICATION (SPECIAL PROVISIONS) ACT

SYSTEMATIC ADJUDICATION AREA : PARTS OF CARLISLE AND RED BANK PART I (PART 10)

LAND INFORMATION										PERSONAL DETAILS	OCCUPANCY DETAILS								
APPLICATION NO.	CADASTRAL MAP NUMBER	CADASTRAL MAP PARCEL NUMBER	LAND VALUATION NUMBER	AREA	PLACE	PARISH	VOLUME/FOLIO	PROPERTY ADDRESS	NATURE OF PARCEL	OWNER(S) DETAILS	NATURE BY WHICH LAND WAS ACQUIRED	NATURE OF OWNER DISABILITY	NAME, ADDRESS AND OCCUPATION OF GUARDIAN	NATURE OF TITLE	DETAILS OF ENCUMBRANCES	RESTRICTIONS ON POWER TO DEAL WITH LAND	DETAILS OF PERSON ENTITLED TO BENEFIT OF RESTRICTION	DOCUMENTS PRESENTED	DATE OF COMPLETION OF APPLICATION FORM
ASD009225	CM1133006-814	113300623		4379.032 Square Meter	RED BANK	St. Elizabeth		Red Bank District, St. Elizabeth	Private	- Dinsdale Lindsay Mullings Farmer of Red Bank District, Red Bank P.O. St. Elizabeth Jamaica	Possession			Absolute					2022-01-19
ASD009111	CM1133006-814	113300624		8831.487 Square Meter	RED BANK	St. Elizabeth		Red Bank District, St. Elizabeth	Private	- Asbert Williams Farmer of Red Bank District, Red Bank P.A. St. Elizabeth Jamaica	Possession			Absolute					2021-11-27
ASD009376	CM1133006-814	113300625		918.169 Square Meter	RED BANK	St. Elizabeth		Red Bank District, St. Elizabeth	Private	- Denroy Evans Businessman of Red Bank District, Red Bank P.A. St. Elizabeth Jamaica	Possession			Absolute					2022-01-19
ASD009224	CM1133006-814	113300627		6683.442 Square Meter	RED BANK	St. Elizabeth		Red Bank District, St. Elizabeth	Private	- Birto Adolphus Powell Farmer of Red Bank District, Red Bank P.A. St. Elizabeth Jamaica	Possession			Absolute					2022-01-19

The Adjudication Record was displayed in the Systematic Adjudication Area on August 30, 2022 and shall remain on display for a period of THIRTY (30) days.

During this period, the Senior Director, Adjudication Services may amend any minor error or omission not materially affecting the interest of any person. Therefore, any Applicant who considers the Adjudication Record to be contain minor inaccuracies or omissions, may within THIRTY (30) days of the date of display of the Adjudication Record, submit the details of such inaccuracies or omissions in the prescribed Form and manner.

Any person who objects to an Applicant's claim to ownership rights and interests in a parcel of land on the Adjudication Record, may within THIRTY (30) days of the date of display of the said Record submit the grounds for objection in the prescribed Form and manner.

The prescribed Forms (Amendment of the Adjudication Record or Objection to the Adjudication Record) are available at any National Land Agency office or via the Agencies website at: [www.nla.gov.jm](http://www.nla.gov.jm)

All Requests for Amendment of the Adjudication Record or Objection to the Adjudication Record must be submitted using the prescribed Form to the Senior Director, Adjudication Services at:

National Land Agency  
8 Ardenne Road  
Kingston 10  
Saint Andrew

This Record comprises applications for lands located within Carlisle & Red Bank, St. Elizabeth and more particularly, being Cadastral Map Number CM1133006-814

Display Date: August 30, 2022

  
Senior Director, Adjudication Services

Carlisle and Red Bank Adjudication Record Part I (Part 10)



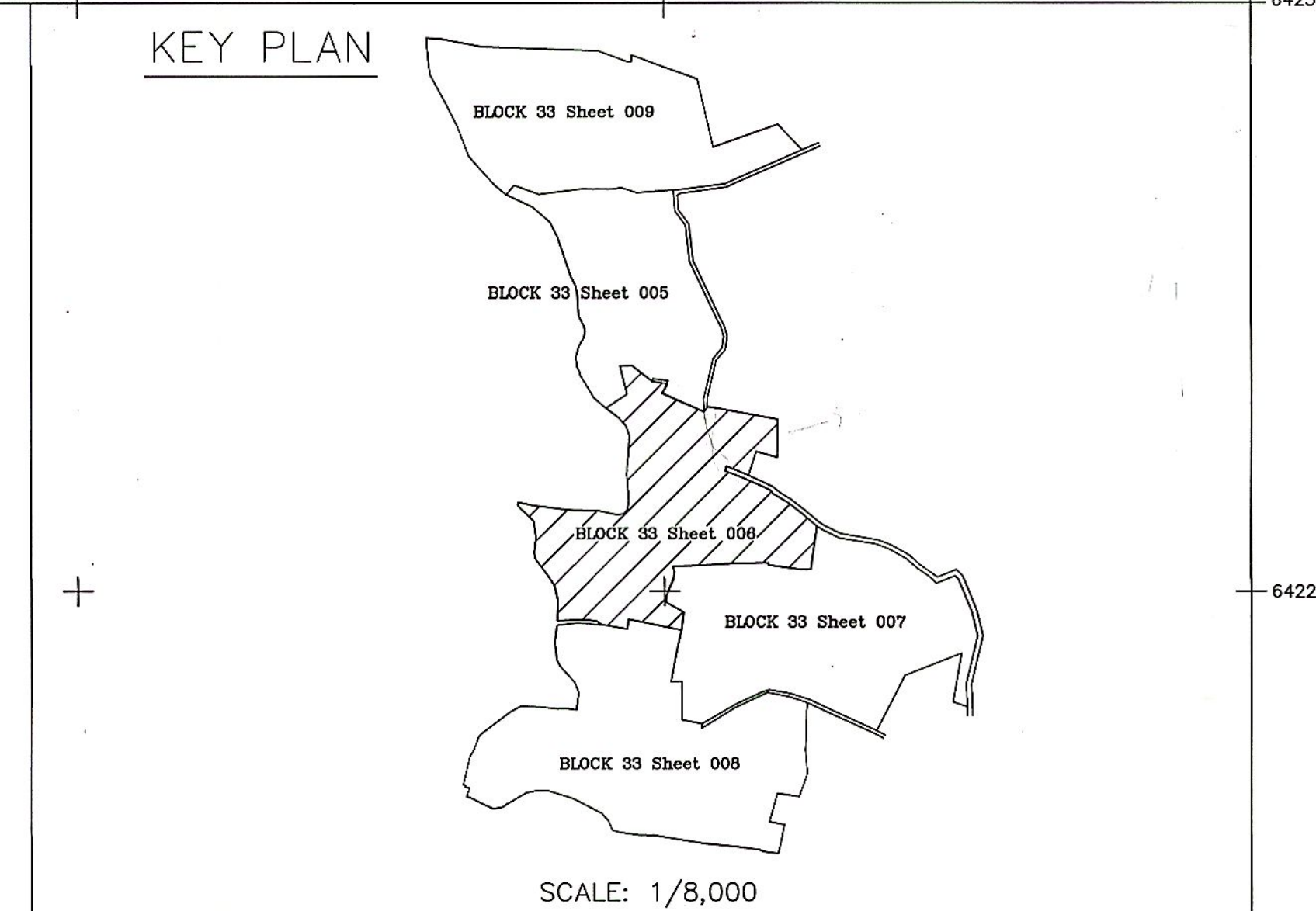

K1133006-814

SURVEYOR: Patrick Hendricks  
PATRICK HENDRICKS  
COMMISSIONED LAND SURVEYOR  
GEOLAND TITLE LIMITED  
DATE: March 14, 2022

Example of parcel numbering

Parish	11				
Block		33			
Sheet			006		
Parcel (Lot)				28	
Parcel #	11.33.006.28				

Users noting errors or omissions are asked to return map to the Survey Department and it will be replaced.

THOSE SERVED WITH NOTICES	Notices were served on all adjoining owners and can be produced if needed.
THOSE WHO APPEARED	No one
GROUND OF OBJECTIONS	None
INSTRUMENT USED	NIKON DTM 322 SN D069168
GPS USED	GPS LEICA GS14 SN 2805976
DATE OF INST. CHECK	2021/01/29