



ADJUDICATION RECORD
PURSUANT TO SECTION 8A (1) (e) and 8A (1) (g) OF THE
REGISTRATION OF TITLES CADASTRAL MAPPING AND TENURE CLARIFICATION (SPECIAL PROVISIONS) ACT

SYSTEMATIC ADJUDICATION AREA : PARTS OF CARLISLE AND RED BANK PART I (PART 9), ST. ELIZABETH

APPLICATION NO.	LAND INFORMATION								PERSONAL DETAILS			OCCUPANCY DETAILS							
	CADASTRAL MAP NUMBER	CADASTRAL MAP PARCEL NUMBER	LAND VALUATION NUMBER	AREA	PLACE	PARISH	VOLUME/FOLIO	PROPERTY ADDRESS	NATURE OF PARCEL	OWNER(S) DETAILS	NATURE BY WHICH LAND WAS ACQUIRED	NATURE OF OWNER DISBAILITY	NAME, ADDRESS AND OCCUPATION OF GUARDIAN	NATURE OF TITLE	DETAILS OF ENCUMBRANCES	RESTRICTIONS ON POWER TO DEAL WITH LAND	DETAILS OF PERSON ENTITLED TO BENEFIT OF RESTRICTION	DOCUMENTS PRESENTED	DATE OF COMPLETION OF APPLICATION FORM
ASD009588	CM1133011-878	113301101		1.3117 Hectare	RED BANK	St. Elizabeth		Red Bank District, St. Elizabeth	Crown	- Commissioner of Lands of 20 North Street Kingston Jamaica	Special Provisions Act			Absolute					2022-03-23
ASD009590	CM1133011-878	113301103		1.6556 Hectare	RED BANK	St. Elizabeth		Red Bank District, St. Elizabeth	Private	- Junie Elmay Powell Evans Retired Practical Nurse of 16 Rocky Park, Waltham, Mandeville P.O Manchester Jamaica - Dotlyn Adiana McLean Retired Housekeeper of Scott Town, Grenville District, Mandeville P.O. Manchester Jamaica	Purchase			Absolute					2022-03-23
ASD009492	CM1133011-878	113301104		6418.188 Square Meter	RED BANK	St. Elizabeth		Carlisle District, St. Elizabeth	Private	- Gloria Ruth Robinson Housewife of Hampstead District, Rose Hall P.O St. Elizabeth Jamaica - Cremlen Lenworth Robinson Farmer of Hampstead District, Rose Hall P.O St. Elizabeth Jamaica	Possession			Absolute					2022-01-19
ASD009491	CM1133011-878	113301105		8647.381 Square Meter	RED BANK	St. Elizabeth		Red Bank District, St. Elizabeth	Private	- Lackart Stanley Miller Farmer of Carlisle District, Red Bank P.A St. Elizabeth Jamaica - Excell Powell Higgle of Red Bank District, Red Bank P.A. St. Elizabeth Jamaica	Possession			Absolute					2022-01-19
ASD009576	CM1133011-878	113301106		2259.483 Square Meter	RED BANK	St. Elizabeth		Red Bank District, St. Elizabeth	Private	- Minnet May Bent Farmer of Carlisle District, Rose Hall P.O. St. Elizabeth Jamaica	Possession			Absolute					2022-03-23
ASD011191	CM1133011-878	113301107		1758.404 Square Meter	RED BANK	St. Elizabeth		Red Bank District, St. Elizabeth	Crown	- Commissioner of Lands of 20 North Street Kingston Jamaica	Special Provisions Act			Absolute					2022-07-14
ASD011192	CM1133011-878	113301108		1596.58 Square Meter	RED BANK	St. Elizabeth		Red Bank District, St. Elizabeth	Crown	- Commissioner of Lands of 20 North Street Kingston Jamaica	Special Provisions Act			Absolute					2022-07-14
ASD011187	CM1133011-878	113301109		1235.21 Square Meter	RED BANK	St. Elizabeth		Red Bank District, St. Elizabeth	Private	- Eustace Powell Mason of Gazeland District, Red Bank P.A St. Elizabeth Jamaica	Possession			Absolute					2022-07-14
ASD011182	CM1133011-878	113301110		1755.687 Square Meter	RED BANK	St. Elizabeth		Red Bank District, St. Elizabeth	Private	- Leonie Powell-Bent Farmer of Carlisle District, Red Bank P.A St. Elizabeth Jamaica	Possession			Absolute					2022-07-14
ASD011186	CM1133011-878	113301111		807.43 Square Meter	RED BANK	St. Elizabeth		Red Bank District, St. Elizabeth	Private	- Delrene Ulanda Powell Simpson Farmer of Rose Hall District, Rose Hall P.O. St. Elizabeth Jamaica	Possession			Absolute					2022-07-14
ASD011188	CM1133011-878	113301112		1272.03 Square Meter	RED BANK	St. Elizabeth		Red Bank District, St. Elizabeth	Private	- Reuben Powell Farmer of Carlisle District, Red Bank P.A St. Elizabeth Jamaica	Possession			Absolute					2022-07-14

The Adjudication Record was displayed in the Systematic Adjudication Area on August 3, 2022 and shall remain on display for a period of THIRTY (30) days.

During this period, the Senior Director, Adjudication Services may amend any minor error or omission not materially affecting the interest of any person. Therefore, any Applicant who considers the Adjudication Record to contain minor inaccuracies or omissions, may within THIRTY (30) days of the date of display of the Adjudication Record, submit the details of such inaccuracies or omissions in the prescribed Form and manner.

Any person who objects to an Applicant's claim to ownership rights and interests in a parcel of land on the Adjudication Record, may within THIRTY (30) days of the date of display of the said Record submit the grounds for objection in the prescribed Form and manner.

The prescribed Forms (Amendment of the Adjudication Record or Objection to the Adjudication Record) are available at any National Land Agency office or via the Agency's website at: www.nla.gov.jm

All Requests for Amendment of the Adjudication Record or Objection to the Adjudication Record must be submitted using the prescribed Form to the Senior Director, Adjudication Services at:

National Land Agency
8 Ardenne Road
Kingston 10
Saint Andrew

This Record comprises applications for lands located within Carlisle and Red Bank Part I, St. Elizabeth and more particularly, being Cadastral Map Number CM1133011-878

Senior Director,
Adjudication Services

Display Date: August 3, 2022

SCALE 1: 1000 Cadastral Map

JAMAICA

LAMP BLOCK 33 Sheet 011

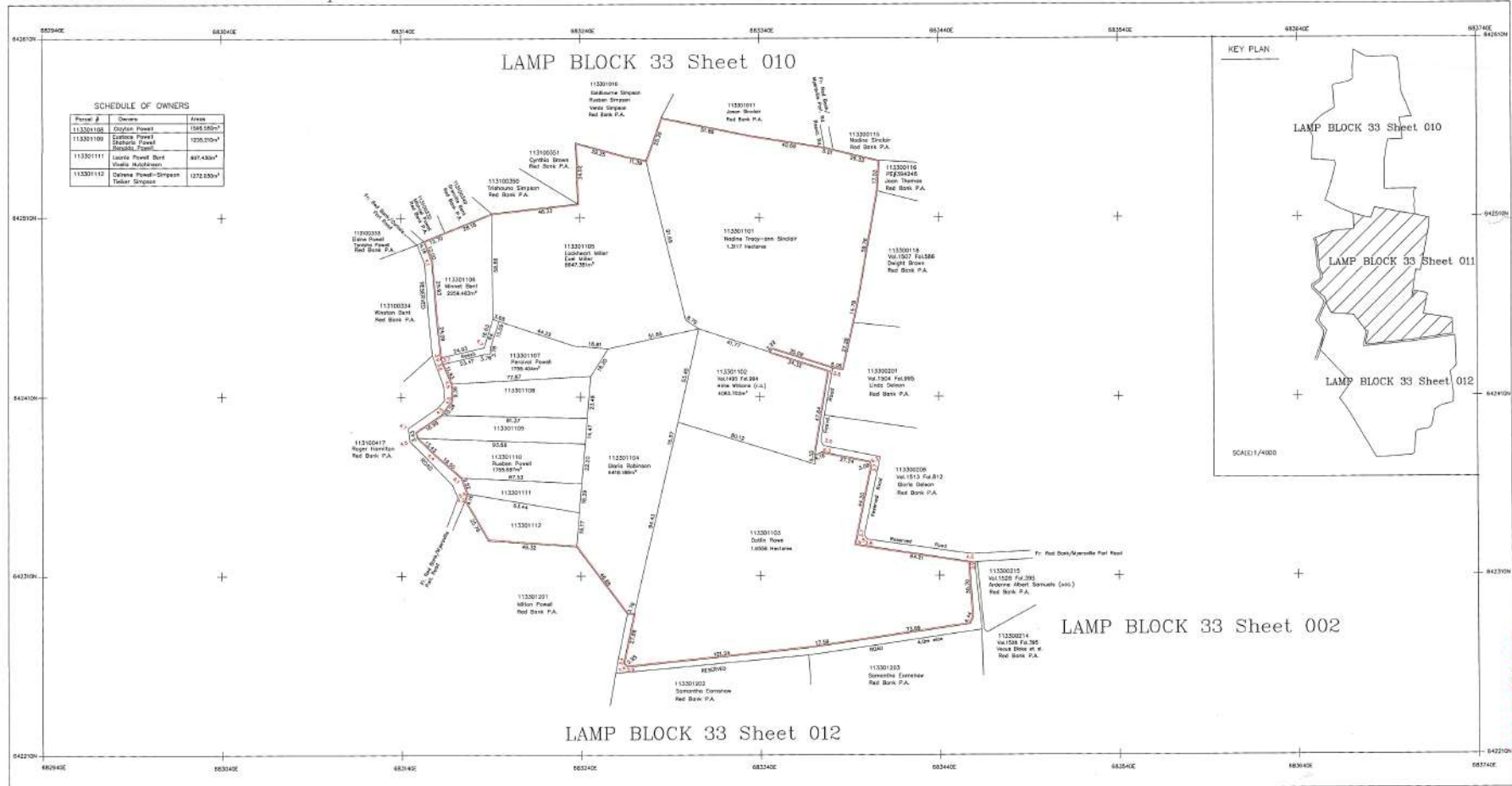

SCHEDULE OF OWNERS

Parcel #	Owner	Area
113301108	Clayton Powell	1588.580m ²
113301109	Carlotta Powell Elizabeth Powell Dorothy Powell	1230.270m ²
113301111	Lucie Powell Bert Lillian Middleton	847.430m ²
113301112	Clayton Powell-Simpson Tucker Simpson	1272.250m ²

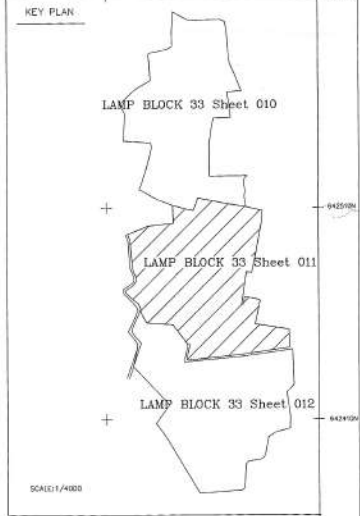

LEGEND

Volume and Folio	Vol. 1010 Fol. 20
Property Boundary	—
Deputed Plot Boundary	—
Daily/Drive/Road	—
Registered Boundary	—

Declared that the area delineated on this map forms part of Survey No. 1133 of Red Bank P.A.

Declared by the Assessable Parties

Patrick Hendricks

Patrick Hendricks

For the Director, Surveys and Mapping Division

SURVEY DATUM JAD2001

Projection: Lambert Conformal Conic Projection with one Standard Parallel and One Standard Meridian

Origin: 77° 00' 00" W of Greenwich

False Coordinates of Origin: 750,000m Easting, 650,000m Northing

Scale Factor at Origin: 1.000



SCALE 1 : 1000

1cm to 10m

GND INTERVAL 100 m

CADASTRAL MAP OF PART OF

RED BANK

partly regd. at Vol. 1010 Fol. 20 and partly unregd.

ST. ELIZABETH

Date of survey: November 10-17, 2021

Parcel Count Table

No. of Certification Parcels	1
No. of Registration Parcels	11
Total no. of Parcels	12

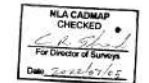

SURVEYOR: *Patrick Hendricks*

PATRICK HENDRICKS
COMMISSIONED LAND SURVEYOR
GEOGRAPHIC TITLE LIMITED
DATE: 27 June 2022

Notes were served on all adjoining owners and can be produced if necessary

There were no objections to the survey

REGISTRATION UNDER SECTION 212 OF THE CONVEYANCE ACT

DATE OF NEXT CHECK: 08/07/2024

Compiled by GEOLAND LIMITED

Plans annexed to Registered Sites, Plans certified by the Survey Department, Surveyors' Records of the Survey Department and Field Observation of Property boundaries.

Compilation date:

Owners making errors or omissions are asked to return maps to the Survey Department and it will be replaced.

Example of parcel numbering

Parish	11		
Block	33		
Sheet		011	
Parcel			01
(Lot)			
Parcel #	113301130		

PREPARED BY
GEOGRAPHIC TITLE LIMITED
Suite 1.1, 1/2 Allport Crescent
Kingston 5
St. Andrew Jamaica, W.I.
TEL: (876)908-0192

1133011