



**ADJUDICATION RECORD**  
**PURSUANT TO SECTION 8A (1) (a) and 8A (1) (g) OF THE**  
**REGISTRATION OF TITLES CADASTRAL MAPPING AND TENURE CLARIFICATION (SPECIAL PROVISIONS) ACT**

SYSTEMATIC ADJUDICATION AREA : PARTS OF BULL SAVANNAH PART I / BULL SAVANNAH PART III, SAINT ELIZABETH (Part 1)

LAND INFORMATION											PERSONAL DETAILS	OCCUPANCY DETAILS							
APPLICATION NO.	CADASTRAL MAP NUMBER	CADASTRAL MAP PARCEL NUMBER	LAND VALUATION NUMBER	AREA	PLACE	PARISH	VOLUME/FOLD	PROPERTY ADDRESS	NATURE OF PARCEL	OWNER(S) DETAILS	NATURE BY WHICH LAND WAS ACQUIRED	NATURE OF OWNER RESIDUALITY	NAME, ADDRESS AND OCCUPATION OF GUARANTOR	NATURE OF TITLE	DETAILS OF ENCUMBRANCES	INSTRUCTIONS ON POWER TO DEAL WITH LAND	DETAILS OF PERSON ENTITLED TO BENEFIT OF INSTRUCTION	DOCUMENTS PRESENTED	DATE OF COMPLETION OF APPLICATION FORM
ASD007821	CM1132008-841	113200814		1171.462 Square Meter	BULL SAVANNAH	St. Elizabeth		Bull Savannah District, St. Elizabeth	Private	- Michelle Anders Kerr Hairdresser of Flat C, 1A Manor Avenue, London SE41PE United Kingdom	Purchase			Absolute					2022-01-05

The Adjudication Record was displayed in the Systematic Adjudication Area on August 30, 2022 and shall remain on display for a period of THIRTY (30) days.

During this period, the Senior Director, Adjudication Services may amend any minor error or omission not materially affecting the interest of any person. Therefore, any Applicant who considers the Adjudication Record to be contain minor inaccuracies or omissions, may within THIRTY (30) days of the date of display of the Adjudication Record, submit the details of such inaccuracies or omissions in the prescribed Form and manner.

Any person who objects to an Applicant's claim to ownership rights and interests in a parcel of land on the Adjudication Record, may within THIRTY (30) days of the date of display of the said Record submit the grounds for objection in the prescribed Form and manner.

The prescribed Forms (Amendment of the Adjudication Record or Objection to the Adjudication Record) are available at any National Land Agency office or via the Agency's website at: [www.nla.gov.jm](http://www.nla.gov.jm)

All Requests for Amendment of the Adjudication Record or Objection to the Adjudication Record must be submitted using the prescribed Form to the Senior Director, Adjudication Services at:

National Land Agency  
8 Ardenne Road  
Kingston 10  
Saint Andrew

This Record comprises applications for lands located within Bull Savannah, St. Elizabeth and more particularly, being Cadastral Map Number 1132008-841, being more specifically Parcel Number 113200814

Display Date: August 30, 2022

Senior Director,  
Adjudication  
Services



ADJUDICATION RECORD

PURSUANT TO SECTION 8A (1) (e) and 8A (1) (g) OF THE  
REGISTRATION OF TITLES CADASTRAL MAPPING AND TENURE CLARIFICATION (SPECIAL PROVISIONS) ACT

SYSTEMATIC ADJUDICATION AREA : PARTS OF BULL SAVANNAH, SAINT ELIZABETH (Part 2)

	LAND INFORMATION									PERSONAL DETAILS	OCCUPANCY DETAILS								
APPLICATION NO.	CADASTRAL MAP NUMBER	CADASTRAL MAP PARCEL NUMBER	LAND VALUATION NUMBER	AREA	PLACE	PARISH	VOLUME/FOLIO	PROPERTY ADDRESS	NATURE OF PARCEL	OWNER(S) DETAILS	NATURE BY WHICH LAND WAS ACQUIRED	NATURE OF OWNER DISABILITY	NAME, ADDRESS AND OCCUPATION OF GUARDIAN	NATURE OF TITLE	DETAILS OF ENCUMBRANCES	RESTRICTIONS ON POWER TO DEAL WITH LAND	DETAILS OF PERSON ENTITLED TO BENEFIT OF RESTRICTION	DOCUMENTS PRESENTED	DATE OF COMPLETION OF APPLICATION FORM
ASD008608	CM1132008-841	113200812		320.55 Square Meter	BULL SAVANNAH	St. Elizabeth		Bull Savannah District, St. Elizabeth	Private	- Fayne Holness Retired Nurse of Bull Savannah District Bull Savannah P.O. St. Elizabeth Jamaica	Possession				Absolute	One Holding		- Property Tax Receipts	2022-01-11
ASD007984	CM1132008-841	113200813		789.13 Square Meter	BULL SAVANNAH	St. Elizabeth		Bull Savannah District, St. Elizabeth	Private	- Fayne Holness Retired Nurse of Bull Savannah District Bull Savannah P.O. St. Elizabeth Jamaica	Possession				Absolute	One Holding		- Property Tax Receipts	2022-01-11
ASD009928	CM1132008-841	113200816		938.248 Square Meter	BULL SAVANNAH	St. Elizabeth		Bull Savannah District, St. Elizabeth	Private	- Ruben Elliott Retired Steel Bender of Forest Hill, 83. Cranston Road London SE 23 EZ United Kingdom	Purchase				Absolute				2022-04-22

The Adjudication Record was displayed in the Systematic Adjudication Area on August 30, 2022 and shall remain on display for a period of THIRTY (30) days.

During this period, the Senior Director, Adjudication Services may amend any minor error or omission not materially affecting the interest of any person. Therefore, any Applicant who considers the Adjudication Record to be contain minor inaccuracies or omissions, may within THIRTY (30) days of the date of display of the Adjudication Record, submit the details of such inaccuracies or omissions in the prescribed Form and manner.

Any person who objects to an Applicant's claim to ownership rights and interests in a parcel of land on the Adjudication Record, may within THIRTY (30) days of the date of display of the said Record submit the grounds for objection in the prescribed Form and manner.

The prescribed Forms (Amendment of the Adjudication Record or Objection to the Adjudication Record) are available at any National Land Agency office or via the Agency's website at: [www.nla.gov.jm](http://www.nla.gov.jm)

All Requests for Amendment of the Adjudication Record or Objection to the Adjudication Record must be submitted using the prescribed Form to the Senior Director, Adjudication Services at:

National Land Agency  
8 Ardenne Road  
Kingston 10  
Saint Andrew

This Record comprises applications for lands located within Bull Savannah, St. Elizabeth and more particularly, being Cadastral Map Number 1132008-841, being more specifically Parcel Numbers 113200812, 113200813 and 113200816.

Display Date: August 30, 2022

  
Senior Director,  
Adjudication Services



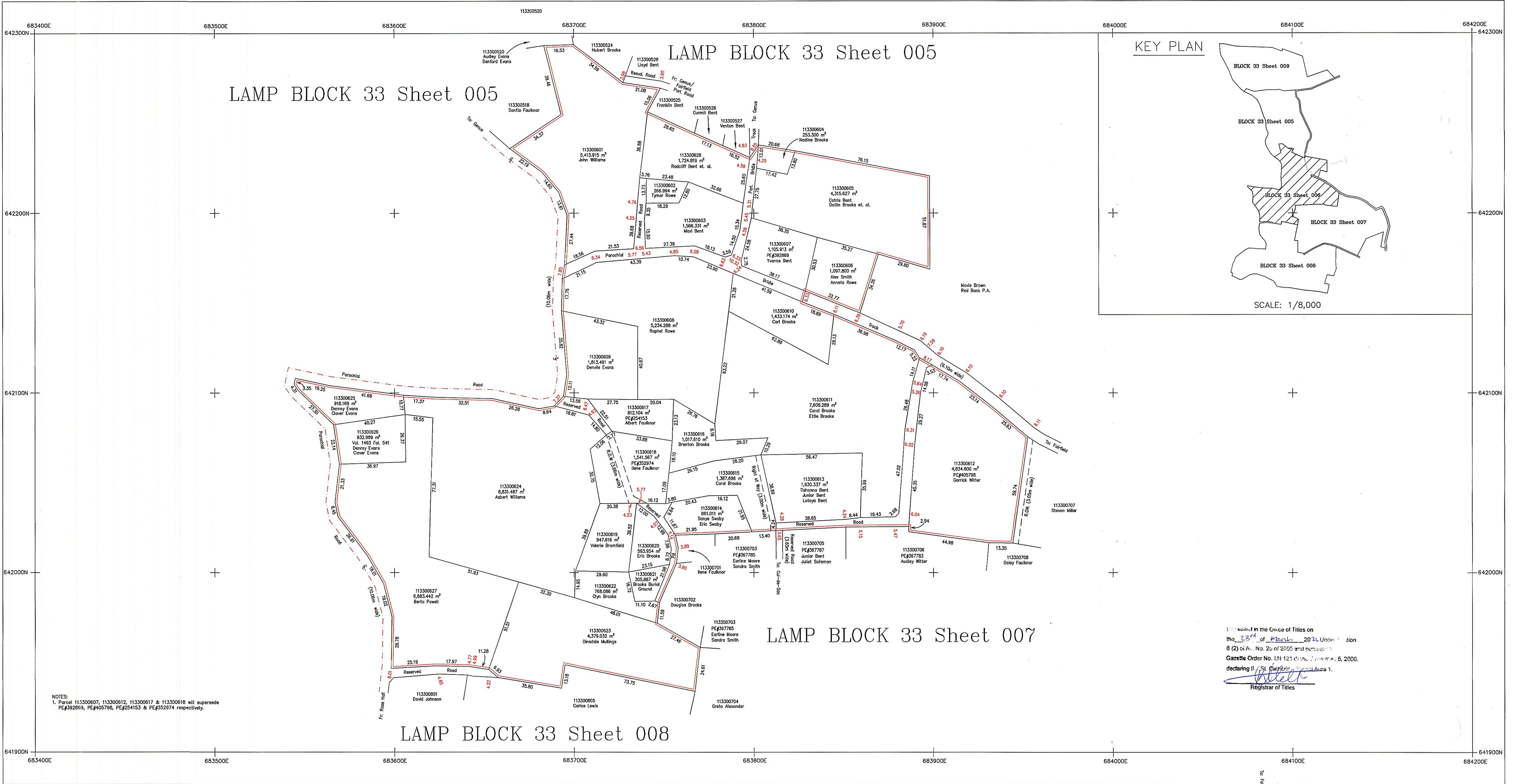

LEGEND

Volume and Folio

Property Boundary

Deposited Plot Boundary

Gully/Drain/River

Registered Boundary

Vol.1010 Fol.20

MEMORANDUM

THOSE SERVED WITH NOTICES	Notices were served on all adjoining owners and can be produced if needed.
THOSE WHO APPEARED	No one
REASONS OF OBJECTIONS	None
INSTRUMENT USED	NIKON DTM 322 SN D069168
GPS USED	GPS LEICA GS14 SN 2805976
DATE OF INST. CHECK	2021/01/29

NLA CADMAP CHECKED

C. R. Evans

For Director of Surveys

Date 2022/03/18

SURVEY DATUM JAD2001

Projection: Lambert Conical Orthomorphic with one Standard Parallel

Spheroid: Unit of Measurement: One Standard Parallel

Origin: 77° 00' 00"W of Greenwich

False Coordinates of Origin: 750,000m Easting 650,000m Northing

Scale Factor at Origin: 1,000

CADASTRAL MAP OF PART OF RED BANK ST. ELIZABETH

partly regd. at Vol. 1493 Fol. 541 and partly unregistered

Date of survey: December 1–December 28, 2021

SCALE 1 : 1000

1cm to 10m

GRID INTERVAL 100 m

Parcel Count Table

No. of Clarification Parcels	1
No. of Regularisation Parcels	27
Total no. of Parcels	28

Example of parcel numbering

Parish	11			
Block	33			
Sheet		006		
Parcel (Lot)			28	
Parcel #	113300628			

Per Sr. Director, Surveys and Mapping Division

Prepared by GEOLAND TITLE LIMITED

SUITE 1, 1 1/2 ALTAMONT CRESCENT KINGSTON 5

St. Andrew Jamaica, W.I.

TEL. (876)–908–0192

718 M

1133006-814