



<div></div> <div>ADJUDICATION RECORD</div> <div>PURSUANT TO SECTION 8A (1) (e) and 8A (1) (g) OF THE</div> <div>REGISTRATION OF TITLES CADASTRAL MAPPING AND TENURE CLARIFICATION (SPECIAL PROVISIONS) ACT</div>																			
SYSTEMATIC ADJUDICATION AREA : BLOCK 7 PART II PARTS OF CHURCH PEN, GORDON WOOD, MOORES PEN/CROSS ROADS, OLD HARBOUR AND OLD HARBOUR BAY, ST. CATHERINE																			
	LAND INFORMATION									PERSONAL DETAILS			OCCUPANCY DETAILS						
APPLICATION NO.	CADASTRAL MAP NUMBER	CADASTRAL MAP PARCEL NUMBER	LAND VALUATION NUMBER	AREA	PLACE	PARISH	VOLUME/POLJO	PROPERTY ADDRESS	NATURE OF PARCEL	OWNER(S) DETAILS	NATURE BY WHICH LAND WAS ACQUIRED	NATURE OF OWNER DISABILITY	NAME, ADDRESS AND OCCUPATION OF GUARDIAN	NATURE OF TITLE	DETAILS OF ENCUMBRANCES	RESTRICTIONS ON POWER TO DEAL WITH LAND	DETAILS OF PERSON ENTITLED TO BENEFIT OF RESTRICTION	DOCUMENTS PRESENTED	DATE OF COMPLETION OF APPLICATION FORM
ASD011075	CM1407032-658	140703203		483.51 Square Meter	WILLIS PARK, CHURCH PEN AND OLD HARBOUR	St. Catherine		Old Harbour District, St. Catherine	Crown	- Commissioner of Lands of 20 North Street Kingston Jamaica	Special Provisions Act			Absolute					2022-07-08
ASD011632	CM1407032-658	140703206		824.49 Square Meter	WILLIS PARK, CHURCH PEN AND OLD HARBOUR	St. Catherine		Old Harbour District, St. Catherine	Crown	- Commissioner of Lands of 20 North Street Kingston Jamaica	Special Provisions Act			Absolute					2022-08-09
ASD011413	CM1407032-658	140703208		521.35 Square Meter	WILLIS PARK, CHURCH PEN AND OLD HARBOUR	St. Catherine		Old Harbour District, St. Catherine	Private	- Marjorie Elaine Mayne Pastry Chef of 16 Patrick street, Old Harbour P.O. St. Catherine Jamaica	Possession			Absolute					2022-07-20
ASD011028	CM1407032-658	140703209		448.71 Square Meter	WILLIS PARK, CHURCH PEN AND OLD HARBOUR	St. Catherine		Old Harbour District, St. Catherine	Private	Myrtella Mayne Retiree of Church Pen District, Old Harbour P.O. St. Catherine Jamaica - Janet Leonie Mayne Teacher of Church Pen District, Od Harbour P.O. St. Catherine Jamaica	Possession			Qualified					2022-07-07
ASD011099	CM1407032-658	140703216		547.15 Square Meter	WILLIS PARK, CHURCH PEN AND OLD HARBOUR	St. Catherine		Old Harbour District, St. Catherine	Crown	- Commissioner of Lands of 20 North Street Kingston Jamaica	Special Provisions Act			Absolute					2022-07-10
ASD011139	CM1407032-658	140703218		795.07 Square Meter	WILLIS PARK, CHURCH PEN AND OLD HARBOUR	St. Catherine		Old Harbour District, St. Catherine	Private	- Barver Nembhard Retired Teacher of Willis Park District, Old Harbour P.O. St. Catherine Jamaica	Possession			Qualified					2022-07-12
ASD011102	CM1407032-658	140703219		1289.0 Square Meter	WILLIS PARK, CHURCH PEN AND OLD HARBOUR	St. Catherine		Old Harbour District, St. Catherine	Crown	- Commissioner of Lands of 20 North Street Kingston Jamaica	Special Provisions Act			Absolute					2022-07-10
ASD011103	CM1407032-658	140703220		496.99 Square Meter	WILLIS PARK, CHURCH PEN AND OLD HARBOUR	St. Catherine		Old Harbour District, St. Catherine	Crown	- Commissioner of Lands of 20 North Street Kingston Jamaica	Special Provisions Act			Absolute					2022-07-10
ASD011299	CM1407032-658	140703221		734.46 Square Meter	WILLIS PARK, CHURCH PEN AND OLD HARBOUR	St. Catherine		Old Harbour District, St. Catherine	Crown	- Commissioner of Lands of 20 North Street Kingston Jamaica	Special Provisions Act			Absolute					2022-07-20
ASD011105	CM1407032-658	140703223		632.15 Square Meter	WILLIS PARK, CHURCH PEN AND OLD HARBOUR	St. Catherine		Old Harbour District, St. Catherine	Private	- Macada Dawkins Dressmaker of 22 Patrick Street, Old Harbour P.O. St. Catherine Jamaica	Possession			Absolute					2022-07-10

<div></div> <div>ADJUDICATION RECORD</div> <div>PURSUANT TO SECTION 8A (1) (e) and 8A (1) (g) OF THE</div> <div>REGISTRATION OF TITLES CADASTRAL MAPPING AND TENURE CLARIFICATION (SPECIAL PROVISIONS) ACT</div>																			
SYSTEMATIC ADJUDICATION AREA : BLOCK 7 PART II PARTS OF CHURCH PEN, GORDON WOOD, MOORES PEN/CROSS ROADS, OLD HARBOUR AND OLD HARBOUR BAY, ST. CATHERINE																			
	LAND INFORMATION									PERSONAL DETAILS			OCCUPANCY DETAILS						
APPLICATION NO.	CADASTRAL MAP NUMBER	CADASTRAL MAP PARCEL NUMBER	LAND VALUATION NUMBER	AREA	PLACE	PARISH	VOLUME/FOLIO	PROPERTY ADDRESS	NATURE OF PARCEL	OWNER(S) DETAILS	NATURE BY WHICH LAND WAS ACQUIRED	NATURE OF OWNER DISABILITY	NAME, ADDRESS AND OCCUPATION OF GUARDIAN	NATURE OF TITLE	DETAILS OF ENCUMBRANCES	RESTRICTIONS ON POWER TO DEAL WITH LAND	DETAILS OF PERSON ENTITLED TO BENEFIT OF RESTRICTION	DOCUMENTS PRESENTED	DATE OF COMPLETION OF APPLICATION FORM
ASD011141	CM1407032-658	140703224		473.68 Square Meter	WILLIS PARK, CHURCH PEN AND OLD HARBOUR	St. Catherine		Old Harbour District, St. Catherine	Private	- Calvin Baracca Thomas Pensioner of 22 Patrick Street, Old Harbour P.O. St. Catherine Jamaica	Possession			Absolute					2022-07-12
ASD010932	CM1407032-658	140703228		419.66 Square Meter	WILLIS PARK, CHURCH PEN AND OLD HARBOUR	St. Catherine	280/44	Old Harbour District, St. Catherine	Private	- Garfield Anthony Dawson Kennel Attendant of Patrick Street, Old Harbour P.O. St. Catherine Jamaica	Possession			Absolute				- Survey Plan Examination No. : 429037	2022-07-04
ASD010963	CM1407032-658	140703229	207-03-018-083	428.11 Square Meter	WILLIS PARK, CHURCH PEN AND OLD HARBOUR	St. Catherine	280/44	Old Harbour District, St. Catherine	Private	- Byron O'Connor Businessman of 24A Patrick Street, Old Harbour P.O., St. Catherine Jamaica - Elfreda O'Connor Unemployed of 20 Rhobella Dr Apt A Poughkeepsie New York 12603 United States - Clive Bailey Tailor of 6 Fullerton Ave, Newburgh New York 12550 United States	Possession			Qualified					2022-07-05
ASD011093	CM1407032-658	140703233		1434.95 Square Meter	WILLIS PARK, CHURCH PEN AND OLD HARBOUR	St. Catherine	280/44	Old Harbour District, St. Catherine	Private	- Uriel Paul Powell Businessman of 24 Patrick Street, Old Harbour P.O. St. Catherine Jamaica	Possession			Absolute					2022-07-10
ASD011261	CM1407032-658	140703240		634.06 Square Meter	WILLIS PARK, CHURCH PEN AND OLD HARBOUR	St. Catherine		Old Harbour District, St. Catherine	Private	Icelyn Henry Thomas Farmer of 17A Patrick Street, Old Harbour P.O., St. Catherine Jamaica - Delroy Leroy Thomas Fisherman of 17 Patrick Street, Old Harbour P.O. St. Catherine Jamaica - Tamar Thomas Nurse Aide of 17A Patrick Street, Old Harbour P.O. St. Catherine Jamaica	Possession			Absolute					2022-07-20
ASD011347	CM1407032-658	140703241		723.85 Square Meter	WILLIS PARK, CHURCH PEN AND OLD HARBOUR	St. Catherine		Old Harbour District, St. Catherine	Crown	- Commissioner of Lands of 20 North Street Kingston Jamaica	Special Provisions Act			Absolute					2022-07-20
ASD011342	CM1407032-658	140703243		477.68 Square Meter	WILLIS PARK, CHURCH PEN AND OLD HARBOUR	St. Catherine		Old Harbour District, St. Catherine	Private	Angela Moncrieffe Ryan Caterer of 17D Patrick Street, Old Harbour P.O., St. Catherine Jamaica - Nora Hycinth Moncrieffe Anderson Caterer of 17D Patrick Street, Old Harbour P.O. St. Catherine Jamaica - Racquel Moncrieffe Nation Nanny of 70 Mapes Avenue, Newark New Jersey 07112 United States	Possession			Absolute					2022-07-20

<div></div> <div>ADJUDICATION RECORD</div> <div>PURSUANT TO SECTION 8A (1) (e) and 8A (1) (g) OF THE</div> <div>REGISTRATION OF TITLES CADASTRAL MAPPING AND TENURE CLARIFICATION (SPECIAL PROVISIONS) ACT</div>																			
SYSTEMATIC ADJUDICATION AREA : BLOCK 7 PART II PARTS OF CHURCH PEN, GORDON WOOD, MOORES PEN/CROSS ROADS, OLD HARBOUR AND OLD HARBOUR BAY, ST. CATHERINE																			
	LAND INFORMATION									PERSONAL DETAILS			OCCUPANCY DETAILS						
APPLICATION NO.	CADASTRAL MAP NUMBER	CADASTRAL MAP PARCEL NUMBER	LAND VALUATION NUMBER	AREA	PLACE	PARISH	VOLUME/FOLIO	PROPERTY ADDRESS	NATURE OF PARCEL	OWNER(S) DETAILS	NATURE BY WHICH LAND WAS ACQUIRED	NATURE OF OWNER DISABILITY	NAME, ADDRESS AND OCCUPATION OF GUARDIAN	NATURE OF TITLE	DETAILS OF ENCUMBRANCES	RESTRICTIONS ON POWER TO DEAL WITH LAND	DETAILS OF PERSON ENTITLED TO BENEFIT OF RESTRICTION	DOCUMENTS PRESENTED	DATE OF COMPLETION OF APPLICATION FORM
ASD011412	CM1407032-658	140703244		668.21 Square Meter	WILLIS PARK, CHURCH PEN AND OLD HARBOUR	St. Catherine		Old Harbour District, St. Catherine	Private	Lorna Deloris Daley Fish Vendor of 17 Patrick Street, Old Harbour P.O., St. Catherine Jamaica	Possession			Absolute					2022-07-20
ASD011479	CM1407032-658	140703253		623.18 Square Meter	WILLIS PARK, CHURCH PEN AND OLD HARBOUR	St. Catherine	331/67	Old Harbour District, St. Catherine	Private	- Winston Fredrick Carty Retiree of 30 Patrick Street, Old Harbour P.O. St. Catherine Jamaica	Possession			Absolute					2022-07-20
ASD011562	CM1407032-658	140703254		1094.96 Square Meter	WILLIS PARK, CHURCH PEN AND OLD HARBOUR	St. Catherine	280/44	Old Harbour District, St. Catherine	Private	- Dean Olthia Johnson Retiree of 71 Pamela Avenue, Old Harbour P.O. St. Catherine Jamaica - Naquita Ombretta Granston Soldier of 71 Pamela Avenue, Old Harbour P.O. St. Catherine Jamaica	Gift			Absolute				Deed of Gift	2022-07-27
ASD011576	CM1407032-658	140703255		4087.7 Square Meter	WILLIS PARK, CHURCH PEN AND OLD HARBOUR	St. Catherine	776/24	Old Harbour District, St. Catherine	Private	- Dwight De Antonio Edwards Carpenter of 32 Patrick Street, Old Harbour P.O., St. Catherine Jamaica	Possession			Absolute					2022-08-04
ASD011408	CM1407039-774	140703903		1738.69 Square Meter	OLD HARBOUR BAY CALLED MOORES PEN, KELLY PEN AND NEW ROAD	St. Catherine		Old Harbour District, St. Catherine	Private	- Paul Bogle Davis Farmer of Kelly Pen District, Old Harbour Bay P.O. St. Catherine Jamaica - Shorn Valerena Davis Principal of 2646 Caberet Way, Waterford, Portmore St. Catherine Jamaica	Possession			Absolute					2022-07-20
ASD011112	CM1407039-774	140703911		1491.16 Square Meter	OLD HARBOUR BAY CALLED MOORES PEN, KELLY PEN AND NEW ROAD	St. Catherine	1218/508	Old Harbour District, St. Catherine	Private	- Ashford St Patrick Williams Technician of Moores Pen, Old Harbour Bay P.O. St. Catherine Jamaica	Possession			Absolute	One Holding				2022-07-11
ASD011502	CM1407039-774	140703913		1954.49 Square Meter	OLD HARBOUR BAY CALLED MOORES PEN, KELLY PEN AND NEW ROAD	St. Catherine		Old Harbour District, St. Catherine	Private	- Keith Elcayo Ludford Unemployed of 6371 Phillips Place, Lithonia Georgia United States	Possession			Absolute				- Property Tax Receipts	2022-07-27
ASD011414	CM1407039-774	140703914		1639.17 Square Meter	OLD HARBOUR BAY CALLED MOORES PEN, KELLY PEN AND NEW ROAD	St. Catherine		Old Harbour District, St. Catherine	Private	Dwight Dale Solomon Auto Body Repairman of Moores Pen Lane, Old Harbour Bay, Old Harbour P.O. St. Catherine Jamaica	Possession			Qualified				- Property Tax Receipts	2022-07-20
ASD011417	CM1407039-774	140703915		2610.7 Square Meter	OLD HARBOUR BAY CALLED MOORES PEN, KELLY PEN AND NEW ROAD	St. Catherine		Old Harbour District, St. Catherine	Private	Fredrick Vernon Retired Farmer of Moores Pen Road, Old Harbour Bay P.O. St. Catherine Jamaica	Possession			Absolute					2022-07-20





ADJUDICATION RECORD
PURSUANT TO SECTION 8A (1) (e) and 8A (1) (g) OF THE
REGISTRATION OF TITLES CADASTRAL MAPPING AND TENURE CLARIFICATION (SPECIAL PROVISIONS) ACT

SYSTEMATIC ADJUDICATION AREA : BLOCK 7 PART II
PARTS OF CHURCH PEN, GORDON WOOD, MOORES PEN/CROSS ROADS, OLD HARBOUR AND OLD HARBOUR BAY, ST. CATHERINE

	LAND INFORMATION									PERSONAL DETAILS			OCCUPANCY DETAILS						
APPLICATION NO.	CADASTRAL MAP NUMBER	CADASTRAL MAP PARCEL NUMBER	LAND VALUATION NUMBER	AREA	PLACE	PARISH	VOLUME/FOLIO	PROPERTY ADDRESS	NATURE OF PARCEL	OWNER(S) DETAILS	NATURE BY WHICH LAND WAS ACQUIRED	NATURE OF OWNER DISABILITY	NAME, ADDRESS AND OCCUPATION OF GUARDIAN	NATURE OF TITLE	DETAILS OF ENCUMBRANCES	RESTRICTIONS ON POWER TO DEAL WITH LAND	DETAILS OF PERSON ENTITLED TO BENEFIT OF RESTRICTION	DOCUMENTS PRESENTED	DATE OF COMPLETION OF APPLICATION FORM
ASD011293	CM1407039-774	140703916		1614.55 Square Meter	OLD HARBOUR BAY CALLED MOORES PEN, KELLY PEN AND NEW ROAD	St. Catherine		Old Harbour District, St. Catherine	Private	Nadine Theresa Staple Self-Employed of 19 Moypen Lane Old Harbour Bay P.O., St. Catherine - Leroy Anthony Staple Maintenance Worker of 2215 Newkirk Avenue, Brooklyn New York 11226 United States	Possession			Absolute					2022-07-20
ASD011114	CM1407039-774	140703919		2344.72 Square Meter	OLD HARBOUR BAY CALLED MOORES PEN, KELLY PEN AND NEW ROAD	St. Catherine	1218/508	Old Harbour District, St. Catherine	Private	- Ashford St Patrick Williams Technician of Moores Pen, Old Harbour Bay P.O. St. Catherine Jamaica	Possession			Absolute	One holding				2022-07-11
ASD011021	CM1407039-774	140703931		1352.0 Square Meter	OLD HARBOUR BAY CALLED MOORES PEN, KELLY PEN AND NEW ROAD	St. Catherine		Old Harbour District, St. Catherine	Private	Mable Johnson Retired Day Care Worker of 18A Little Kew Road, Kingston 5 St. Andrew Jamaica	Purchase			Absolute				Indenture	2022-07-07
ASD011033	CM1407039-774	140703932		477.73 Square Meter	OLD HARBOUR BAY CALLED MOORES PEN, KELLY PEN AND NEW ROAD	St. Catherine		Old Harbour District, St. Catherine	Private	- Lottie Adora Robinson Retired Farmer of New Road District, Old Harbour Bay P.O. St. Catherine Jamaica	Possession			Absolute					2022-07-07
ASD011255	CM1407039-774	140703938		1091.43 Square Meter	OLD HARBOUR BAY CALLED MOORES PEN, KELLY PEN AND NEW ROAD	St. Catherine		Old Harbour District, St. Catherine	Private	- Opal Armstrong Nutritionist of 628 Sunway Lane, Winter Haven Florida 33880 United States	Possession			Absolute					2022-07-20
ASD011275	CM1407039-774	140703940		612.65 Square Meter	OLD HARBOUR BAY CALLED MOORES PEN, KELLY PEN AND NEW ROAD	St. Catherine		Old Harbour District, St. Catherine	Private	Eleta Perkins Retired Fish Vendor of Moores Pen Lane, Old Harbour Bay P.O., St. Catherine Jamaica	Possession			Absolute					2022-07-20
ASD011596	CM1407040-773	140704002		600.14 Square Meter	OLD HARBOUR BAY CALLED MOORES PEN AND CROSS ROADS	St. Catherine		Old Harbour District, St. Catherine	Crown	- Commissioner of Lands of 20 North Street Kingston Jamaica	Special Provisions Act			Absolute					2022-08-04
ASD011485	CM1407040-773	140704003		640.27 Square Meter	OLD HARBOUR BAY CALLED MOORES PEN AND CROSS ROADS	St. Catherine		Old Harbour District, St. Catherine	Private	- Clifton Ludford Welding of Kelly Pen Road, Old Harbour Bay P.O. St. Catherine Jamaica	Possession			Qualified	Right of Way				2022-07-27
ASD011620	CM1407040-773	140704004		266.27 Square Meter	OLD HARBOUR BAY CALLED MOORES PEN AND CROSS ROADS	St. Catherine		Old Harbour District, St. Catherine	Crown	- Commissioner of Lands of 20 North Street Kingston Jamaica	Special Provisions Act			Absolute	Right of Way 3m wide				2022-08-09

<div></div> <div>ADJUDICATION RECORD</div> <div>PURSUANT TO SECTION 8A (1) (e) and 8A (1) (g) OF THE</div> <div>REGISTRATION OF TITLES CADASTRAL MAPPING AND TENURE CLARIFICATION (SPECIAL PROVISIONS) ACT</div>																			
SYSTEMATIC ADJUDICATION AREA : BLOCK 7 PART II PARTS OF CHURCH PEN, GORDON WOOD, MOORES PEN/CROSS ROADS, OLD HARBOUR AND OLD HARBOUR BAY, ST. CATHERINE																			
	LAND INFORMATION									PERSONAL DETAILS			OCCUPANCY DETAILS						
APPLICATION NO.	CADASTRAL MAP NUMBER	CADASTRAL MAP PARCEL NUMBER	LAND VALUATION NUMBER	AREA	PLACE	PARISH	VOLUME/FOLIO	PROPERTY ADDRESS	NATURE OF PARCEL	OWNER(S) DETAILS	NATURE BY WHICH LAND WAS ACQUIRED	NATURE OF OWNER DISABILITY	NAME, ADDRESS AND OCCUPATION OF GUARDIAN	NATURE OF TITLE	DETAILS OF ENCUMBRANCES	RESTRICTIONS ON POWER TO DEAL WITH LAND	DETAILS OF PERSON ENTITLED TO BENEFIT OF RESTRICTION	DOCUMENTS PRESENTED	DATE OF COMPLETION OF APPLICATION FORM
ASD011475	CM1407040-773	140704005		607.56 Square Meter	OLD HARBOUR BAY CALLED MOORES PEN AND CROSS ROADS	St. Catherine		Old Harbour District, St. Catherine	Private	- Marcia Sophine Williams Housewife of Kelly's Pen, Old Harbour Bay P.O. St. Catherine Jamaica - Dilip Sowdiside Williams Driver of Kelly's Pen District, Old Harbour Bay St. Catherine Jamaica	Possession			Absolute					2022-07-20
ASD011607	CM1407040-773	140704006		956.29 Square Meter	OLD HARBOUR BAY CALLED MOORES PEN AND CROSS ROADS	St. Catherine		Old Harbour District, St. Catherine	Private	- Violet Maud Bailey Unemployed of 208 Lockwood Road, Brampton Ontario Canada	Possession			Absolute					2022-08-04
ASD011451	CM1407040-773	140704008		1638.57 Square Meter	OLD HARBOUR BAY CALLED MOORES PEN AND CROSS ROADS	St. Catherine		Old Harbour District, St. Catherine	Private	Bridget Maureen Vassell Businesswoman of Moores Pen Road, Old Harbour Bay P.O. St. Catherine Jamaica	Possession			Absolute					2022-07-20
ASD011266	CM1407040-773	140704009		3901.74 Square Meter	OLD HARBOUR BAY CALLED MOORES PEN AND CROSS ROADS	St. Catherine	524/8	Old Harbour District, St. Catherine	Private	Thinker Anthony Williams Alias Champs Businessman of Moores Avenue District, Old Harbour Bay P.O., St. Catherine Jamaica - Leslie Hugh Jordon Welder of Moore Avenue, Old Harbour Bay P.O. St. Catherine Jamaica	Possession			Absolute				- Certificate of Title Registered- Volume: 524 Folio: 8	2022-07-20
ASD011566	CM1407040-773	140704011		801.7 Square Meter	OLD HARBOUR BAY CALLED MOORES PEN AND CROSS ROADS	St. Catherine		Old Harbour District, St. Catherine	Crown	- Commissioner of Lands of 20 North Street Kingston Jamaica	Special Provisions Act			Absolute					2022-07-27
ASD011416	CM1407040-773	140704013		452.33 Square Meter	OLD HARBOUR BAY CALLED MOORES PEN AND CROSS ROADS	St. Catherine		Old Harbour District, St. Catherine	Crown	- Commissioner of Lands of 20 North Street Kingston Jamaica	Special Provisions Act			Absolute					2022-07-20
ASD011098	CM1407040-773	140704022		789.0 Square Meter	OLD HARBOUR BAY CALLED MOORES PEN AND CROSS ROADS	St. Catherine		Old Harbour District, St. Catherine	Crown	- Commissioner of Lands of 20 North Street Kingston Jamaica	Special Provisions Act			Absolute					2022-07-10
ASD011138	CM1407040-773	140704023		1304.39 Square Meter	OLD HARBOUR BAY CALLED MOORES PEN AND CROSS ROADS	St. Catherine		Old Harbour District, St. Catherine	Private	Joan May Mitchell Unemployed of Moores Pen District, Old Harbour Bay P.O. St. Catherine Jamaica - Harold Mitchell Businessman of 20 Anderson Drive, May Pen P.O. St. Catherine Jamaica	Possession			Absolute					2022-07-12
ASD011561	CM1407040-773	140704026		877.38 Square Meter	OLD HARBOUR BAY CALLED MOORES PEN AND CROSS ROADS	St. Catherine		Old Harbour District, St. Catherine	Crown	- Commissioner of Lands of 20 North Street Kingston Jamaica	Special Provisions Act			Absolute					2022-07-27

<div></div> <div>ADJUDICATION RECORD</div> <div>PURSUANT TO SECTION 8A (1) (a) and 8A (1) (g) OF THE REGISTRATION OF TITLES CADASTRAL MAPPING AND TENURE CLARIFICATION (SPECIAL PROVISIONS) ACT</div>																			
SYSTEMATIC ADJUDICATION AREA : BLOCK 7 PART II PARTS OF CHURCH PEN, GORDON WOOD, MOORES PEN/CROSS ROADS, OLD HARBOUR AND OLD HARBOUR BAY, ST. CATHERINE																			
	LAND INFORMATION									PERSONAL DETAILS			OCCUPANCY DETAILS						
APPLICATION NO.	CADASTRAL MAP NUMBER	CADASTRAL MAP PARCEL NUMBER	LAND VALUATION NUMBER	AREA	PLACE	PARISH	VOLUME/FOLIO	PROPERTY ADDRESS	NATURE OF PARCEL	OWNER(S) DETAILS	NATURE BY WHICH LAND WAS ACQUIRED	NATURE OF OWNER DISABILITY	NAME, ADDRESS AND OCCUPATION OF GUARDIAN	NATURE OF TITLE	DETAILS OF ENCUMBRANCES	RESTRICTIONS ON POWER TO DEAL WITH LAND	DETAILS OF PERSON ENTITLED TO BENEFIT OF RESTRICTION	DOCUMENTS PRESENTED	DATE OF COMPLETION OF APPLICATION FORM
ASD011387	CM1407040-773	140704027		579.69 Square Meter	OLD HARBOUR BAY CALLED MOORES PEN AND CROSS ROADS	St. Catherine		Old Harbour District, St. Catherine	Private	- Emanuel George Townsend Mechanical Maintenance Technician of Cross Roads District, Old Harbour Bay P.O St. Catherine Jamaica	Possession			Absolute					2022-07-20
ASD011004	CM1407040-773	140704031		813.09 Square Meter	OLD HARBOUR BAY CALLED MOORES PEN AND CROSS ROADS	St. Catherine		Old Harbour District, St. Catherine	Crown	- Commissioner of Lands of 20 North Street Kingston Jamaica	Special Provisions Act			Absolute					2022-07-06
ASD011331	CM1407040-773	140704035		1504.19 Square Meter	OLD HARBOUR BAY CALLED MOORES PEN AND CROSS ROADS	St. Catherine	524/8	Old Harbour District, St. Catherine	Private	Leslie Hugh Jordon Welder of Moores Pen District, Old Harbour Bay P.O., St. Catherine Jamaica	Special Provisions Act			Absolute					2022-07-20
ASD011426	CM1407040-773	140704036		958.59 Square Meter	OLD HARBOUR BAY CALLED MOORES PEN AND CROSS ROADS	St. Catherine		Old Harbour District, St. Catherine	Crown	- Commissioner of Lands of 20 North Street Kingston Jamaica	Special Provisions Act			Absolute					2022-07-20
ASD011431	CM1407040-773	140704037		1042.66 Square Meter	OLD HARBOUR BAY CALLED MOORES PEN AND CROSS ROADS	St. Catherine		Old Harbour District, St. Catherine	Crown	- Commissioner of Lands of 20 North Street Kingston Jamaica	Special Provisions Act			Absolute					2022-07-20
ASD011367	CM140722-601	14072203		3304.693 Square Meter	GORDON WOOD	St. Catherine		Gordon Wood District, St. Catherine	Crown	- Commissioner of Lands of 20 North Street Kingston Jamaica	Special Provisions Act			Absolute					2022-07-20
ASD011134	CM140722-601	14072204	207-03-016-275	416.369 Square Meter	GORDON WOOD	St. Catherine		Gordon Wood District, St. Catherine	Private	- Cecile Georgia Pearce Businesswoman of Gordonwood District, Old Harbour P.O. St. Catherine Jamaica	Purchase			Absolute	One Holding			- Property Tax Certificate Expiring - Receipt - Birth Certificate	2022-07-12
ASD011133	CM140722-601	14072205	207-03-016-275	536.428 Square Meter	GORDON WOOD	St. Catherine		Gordon Wood District, St. Catherine	Private	- Cecile Georgia Pearce Businesswoman of Gordonwood District, Old Harbour P.O. St. Catherine Jamaica	Purchase			Absolute	One Holding			- Property Tax Certificate Expiring - Receipt - Birth Certificate	2022-07-12
ASD010997	CM140722-601	14072206		817.736 Square Meter	GORDON WOOD	St. Catherine		Gordon Wood District, St. Catherine	Crown	- Commissioner of Lands of 20 North Street Kingston Jamaica	Special Provisions Act			Absolute					2022-07-06

<div></div> <div>ADJUDICATION RECORD</div> <div>PURSUANT TO SECTION 8A (1) (e) and 8A (1) (g) OF THE REGISTRATION OF TITLES CADASTRAL MAPPING AND TENURE CLARIFICATION (SPECIAL PROVISIONS) ACT</div>																			
SYSTEMATIC ADJUDICATION AREA : BLOCK 7 PART II PARTS OF CHURCH PEN, GORDON WOOD, MOORES PEN/CROSS ROADS, OLD HARBOUR AND OLD HARBOUR BAY, ST. CATHERINE																			
	LAND INFORMATION									PERSONAL DETAILS			OCCUPANCY DETAILS						
APPLICATION NO.	CADASTRAL MAP NUMBER	CADASTRAL MAP PARCEL NUMBER	LAND VALUATION NUMBER	AREA	PLACE	PARISH	VOLUME/FOLIO	PROPERTY ADDRESS	NATURE OF PARCEL	OWNER(S) DETAILS	NATURE BY WHICH LAND WAS ACQUIRED	NATURE OF OWNER DISABILITY	NAME, ADDRESS AND OCCUPATION OF GUARDIAN	NATURE OF TITLE	DETAILS OF ENCUMBRANCES	RESTRICTIONS ON POWER TO DEAL WITH LAND	DETAILS OF PERSON ENTITLED TO BENEFIT OF RESTRICTION	DOCUMENTS PRESENTED	DATE OF COMPLETION OF APPLICATION FORM
ASD011598	CM140722-601	14072210		1118.582 Square Meter	GORDON WOOD	St. Catherine		Gordon Wood District, St. Catherine	Private	- Thoepphelus Pitter Unemployed of Gordon Wood District, Bushy Park P.O. St. Catherine Jamaica	Possession			Absolute					2022-08-04
ASD011578	CM140722-601	14072211		391.57 Square Meter	GORDON WOOD	St. Catherine		Gordon Wood District, St. Catherine	Crown	- Commissioner of Lands of 20 North Street Kingston Jamaica	Special Provisions Act			Absolute					2022-08-04
ASD011337	CM140722-601	14072214		237.728 Square Meter	GORDON WOOD	St. Catherine		Gordon Wood District, St. Catherine	Crown	- Commissioner of Lands of 20 North Street Kingston Jamaica	Special Provisions Act			Absolute					2022-07-20
ASD011297	CM140722-601	14072215		392.63 Square Meter	GORDON WOOD	St. Catherine		Gordon Wood District, St. Catherine	Private	- Shanna-Kay Kenisha Robertson Self-Employed of Gordon Wood District, Church Pen, Old Harbour P.O. St. Catherine Jamaica	Possession			Qualified					2022-07-20
ASD011286	CM140722-601	14072216		433.843 Square Meter	GORDON WOOD	St. Catherine		Gordon Wood District, St. Catherine	Private	Orthens Melhado Housewife of Gordon Wood District, Bushy Park P.O., St. Catherine Jamaica - Rayan Melhado Mason of Gordon Wood District, Bushy Park P.O., St. Catherine Jamaica	Purchase			Absolute				- Receipt	2022-07-20
ASD011298	CM140722-601	14072217		419.365 Square Meter	GORDON WOOD	St. Catherine		Gordon Wood District, St. Catherine	Private	Carmen Adassa Shaw Poultry Farmer of Gordon Wood District, Church Pen, Old Harbour P.O. St. Catherine Jamaica	Purchase			Absolute				- Property Tax Receipts - Receipt	2022-07-20
ASD011146	CM140722-601	14072223		368.362 Square Meter	GORDON WOOD	St. Catherine		Gordon Wood District, St. Catherine	Private	Latesha Naomie Bancoy Shopkeeper of Gordon Wood, Church Pen, Old Harbour P.O. St. Catherine Jamaica	Gift			Absolute				Survey Plan Examination No. : 238373 - Property Tax Receipts Deed of Gift	2022-07-12

<div></div> <div>ADJUDICATION RECORD</div> <div>PURSUANT TO SECTION 8A (1) (e) and 8A (1) (g) OF THE</div> <div>REGISTRATION OF TITLES CADASTRAL MAPPING AND TENURE CLARIFICATION (SPECIAL PROVISIONS) ACT</div>																			
SYSTEMATIC ADJUDICATION AREA : BLOCK 7 PART II PARTS OF CHURCH PEN, GORDON WOOD, MOORES PEN/CROSS ROADS, OLD HARBOUR AND OLD HARBOUR BAY, ST. CATHERINE																			
	LAND INFORMATION									PERSONAL DETAILS		OCCUPANCY DETAILS							
APPLICATION NO.	CADASTRAL MAP NUMBER	CADASTRAL MAP PARCEL NUMBER	LAND VALUATION NUMBER	AREA	PLACE	PARISH	VOLUME/FOLIO	PROPERTY ADDRESS	NATURE OF PARCEL	OWNER(S) DETAILS	NATURE BY WHICH LAND WAS ACQUIRED	NATURE OF OWNER DISABILITY	NAME, ADDRESS AND OCCUPATION OF GUARDIAN	NATURE OF TITLE	DETAILS OF INCUMBRANCES	RESTRICTIONS ON POWER TO DEAL WITH LAND	DETAILS OF PERSON ENTITLED TO BENEFIT OF RESTRICTION	DOCUMENTS PRESENTED	DATE OF COMPLETION OF APPLICATION FORM
ASD011164	CM140722-601	14072224		535.138 Square Meter	GORDON WOOD	St. Catherine		Gordon Wood District, St. Catherine	Private	Nadine Angela Edwards-Thompson Businesswoman of Church Pen, Gordon Wood, Old Harbour P.O. St. Catherine Jamaica - Marlon Anthony Thompson Entrepreneur of 42-2 Sparrow Street BT PO Box 1898 Sav Grand Cayman KYI- 1505 Cayman Islands	Purchase			Qualified				- Survey Plan Examination No. : 419961 - Property Tax Receipts - Receipt	2022-07-13
ASD011110	CM140722-601	14072226		470.836 Square Meter	GORDON WOOD	St. Catherine		Gordon Wood District, St. Catherine	Crown	- Commissioner of Lands of 20 North Street Kingston Jamaica	Special Provisions Act			Absolute					2022-07-11
ASD011445	CM140722-601	14072229		680.07 Square Meter	GORDON WOOD	St. Catherine		Gordon Wood District, St. Catherine	Private	- Glenford Oliver Mills Chef of Gordon Wood District, Church Pen, Old Harbour P.O. St. Catherine Jamaica	Possession			Absolute					2022-07-20
ASD011557	CM140722-601	14072230		575.286 Square Meter	GORDON WOOD	St. Catherine		Gordon Wood District, St. Catherine	Crown	- Commissioner of Lands of 20 North Street Kingston Jamaica	Special Provisions Act			Absolute					2022-07-27
ASD011038	CM1407062/1-624	140762001		671.0 Square Meter	GORDON WOOD SITUATE AT CHURCH PEN	St. Catherine		Gordon Wood District, St. Catherine	Private	- Oral Orlando Douglas Chef of 7150 W Highway 98 Unit 12208, Panama City Beach Florida 32407-4933 United States - Christopher Hammond Maintenance Technician of Spring Village, Bushy Park P.O. St. Catherine Jamaica	Purchase			Absolute				- Survey Plan Examination No. : 434517 - Property Tax Receipts - Receipt	2022-07-07
ASD011066	CM1407062/1-624	140762003		400.0 Square Meter	GORDON WOOD SITUATE AT CHURCH PEN	St. Catherine		Gordon Wood District, St. Catherine	Private	- Vecos Walker Farmer of Gordon Wood District, Bushy Park P.O. St. Catherine Jamaica	Possession			Absolute					2022-07-08
ASD010923	CM1407062/1-624	140762004		523.0 Square Meter	GORDON WOOD SITUATE AT CHURCH PEN	St. Catherine		Gordon Wood District, St. Catherine	Private	- Marian Wright Retiree of Gordon Wood District, Bushy Park P.O. St. Catherine Jamaica	Possession			Absolute					2022-07-03



ADJUDICATION RECORD

PURSUANT TO SECTION 8A (1) (e) and 8A (1) (g) OF THE

REGISTRATION OF TITLES CADASTRAL MAPPING AND TENURE CLARIFICATION (SPECIAL PROVISIONS) ACT

SYSTEMATIC ADJUDICATION AREA : BLOCK 7 PART II

PARTS OF CHURCH PEN, GORDON WOOD, MOORES PENCROSS ROADS, OLD HARBOUR AND OLD HARBOUR BAY, ST. CATHERINE

	LAND INFORMATION									PERSONAL DETAILS	OCCUPANCY DETAILS								
APPLICATION NO.	CADASTRAL MAP NUMBER	CADASTRAL MAP PARCEL NUMBER	LAND VALUATION NUMBER	AREA	PLACE	PARISH	VOLUME/FOLIO	PROPERTY ADDRESS	NATURE OF PARCEL	OWNER(S) DETAILS	NATURE BY WHICH LAND WAS ACQUIRED	NATURE OF OWNER DISABILITY	NAME, ADDRESS AND OCCUPATION OF GUARDIAN	NATURE OF TITLE	DETAILS OF ENCUMBRANCES	RESTRICTIONS ON POWER TO DEAL WITH LAND	DETAILS OF PERSON ENTITLED TO BENEFIT OF RESTRICTION	DOCUMENTS PRESENTED	DATE OF COMPLETION OF APPLICATION FORM
ASD011369	CM1407062/1-624	140762005		1636.0 Square Meter	GORDON WOOD SITUATE AT CHURCH PEN	St. Catherine		Gordon Wood District, St. Catherine	Crown	- Commissioner of Lands of 20 North Street Kingston Jamaica	Special Provisions Act			Absolute					2022-07-20
ASD010979	CM1407062/1-624	140762006		4596.0 Square Meter	GORDON WOOD SITUATE AT CHURCH PEN	St. Catherine		Gordon Wood District, St. Catherine	Crown	- Commissioner of Lands of 20 North Street Kingston Jamaica	Special Provisions Act			Absolute					2022-07-06

The Adjudication Record was displayed in the Systematic Adjudication Area on August 23, 2022 and shall remain on display for a period of THIRTY (30) days.

During this period, the Senior Director, Adjudication Services may amend any minor error or omission not materially affecting the interest of any person. Therefore, any Applicant who considers the Adjudication Record to be contain minor inaccuracies or omissions, may within THIRTY (30) days of the date of display of the Adjudication Record, submit the details of such inaccuracies or omissions in the prescribed Form and manner.

Any person who objects to an Applicant's claim to ownership rights and interests in a parcel of land on the Adjudication Record, may within THIRTY (30) days of the date of display of the said Record submit the grounds for objection in the prescribed Form and manner.

The prescribed Forms (Amendment of the Adjudication Record or Objection to the Adjudication Record) are available at any National Land Agency office or via the Agencys website at: www.nla.gov.jm

All Requests for Amendment of the Adjudication Record or Objection to the Adjudication Record must be submitted using the prescribed Form to the Senior Director, Adjudication Services at:

National Land Agency
8 Ardenne Road
Kingston 10
Saint Andrew

This Record comprises applications for lands located within St. Catherine Block 7 Part II and more particularly, being Cadastral Map Numbers:

1. CM1407032-658
2. CM1407039-774
3. CM1407040-773
4. CM140722-601
5. CM1407062/1-624

Display Date: August 23, 2022



Senior Director,
Adjudication Services

2 14 07 22

LAMP BLOCK 7 - SHEET 22

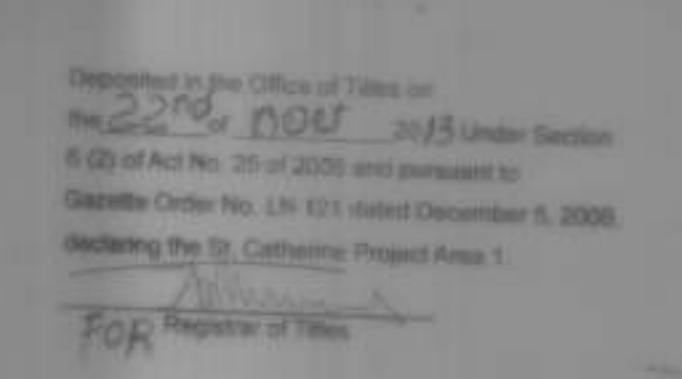

PREPARED BY
LAND MANAGEMENT CONSORTIUM
18 BELMONT ROAD
KINGSTON 2
Tel. 878-625-0888

CM1407062/1-624

Scale 1:500 Cadastral Map

JAMAICA

LAMP BLOCK 7 - SHEET 62

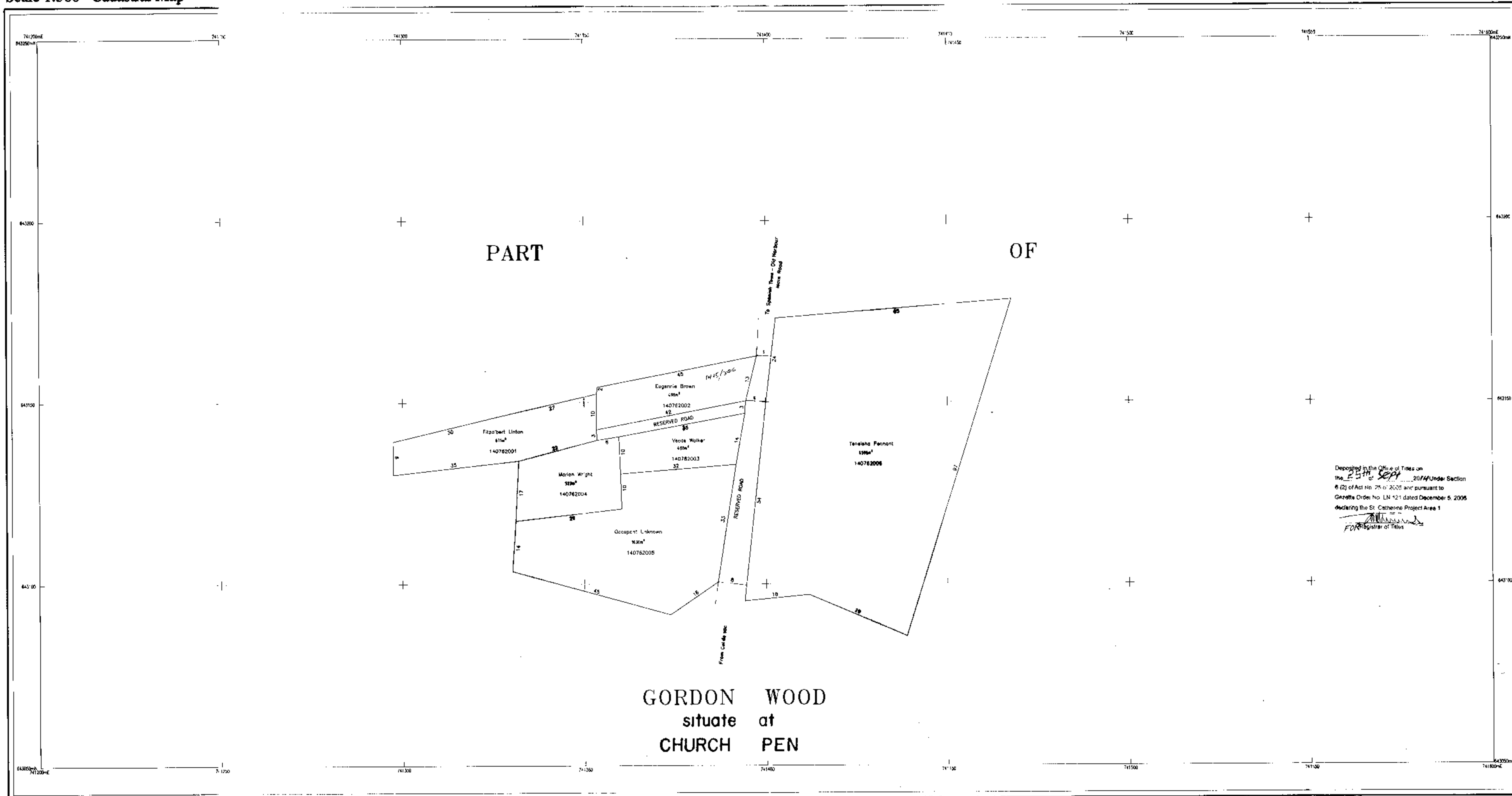

Deposited in the Office of Titles on the 25th SEPT 2014 Under Section 6 (2) of Act No. 25 of 2005 and pursuant to Gazette Order No. LN 121 dated December 5, 2006 declaring the St. Catherine Project Area 1

CM1407062/1

Certified that the area delineated on this map form part of LAMP St. Catherine Project Area 1
Gazetted in Order No. LN 121 dated December 5, 2006
Dated the 22nd of August, 2014

Director of Survey

SURVEY DATUM : JAG2001

Projection: Lambert Conformal Orthomorphic with one Standard Parallel
Spheroid: WGS 84
Unit of Measurement: Metres
Origin: 77° 00' W. of Greenwich
False Co-ordinates of Origin: 10 00 N. of the Equator
Scale Factor at Origin: 750 000; Easting 650 000m; Northing 1 000

Prepared by:

Cadmap Division

Approved by:

Director of Survey

SCALE : 1cm To 5m R.F. 1/500
GRAPHIC SCALE

CADAstral MAP
PART OF
GORDON WOOD
situate at
CHURCH PEN
SAINT CATHERINE

GN



LA CADMAP
CHECKED

For Director of Survey

Date 22/08/2014

Compiled by Land Management Consortium Ltd from Plans annexed to Registered Titles, Plans by the Survey Department, Cadastral Records certified of the Survey Department and Field observation of Property boundaries.

Compilation Date: March 2005

Users noting errors or omissions are asked to return map to the Survey and Mapping Division and it will be replaced.

Example of Parcel Numbering

Parish	14		
Block		07	
Sheet			62
Parcel			001
Parcel #	140762001		

PREPARED BY
LAND MANAGEMENT CONSORTIUM LTD
22 ANNETTE CRESCENT,
KINGSTON 10
Tel: 878-925-0498

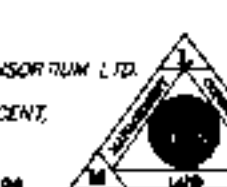

LEGEND
Volume and Folio
Property Boundary
Deposited Plan Boundary
Gully/Drain/River
Registered Boundary

CM 1407040 - 773

Scale 1:1000 Cadastral Map

JAMAICA

LAMP BLOCK 7 - SHEET 40

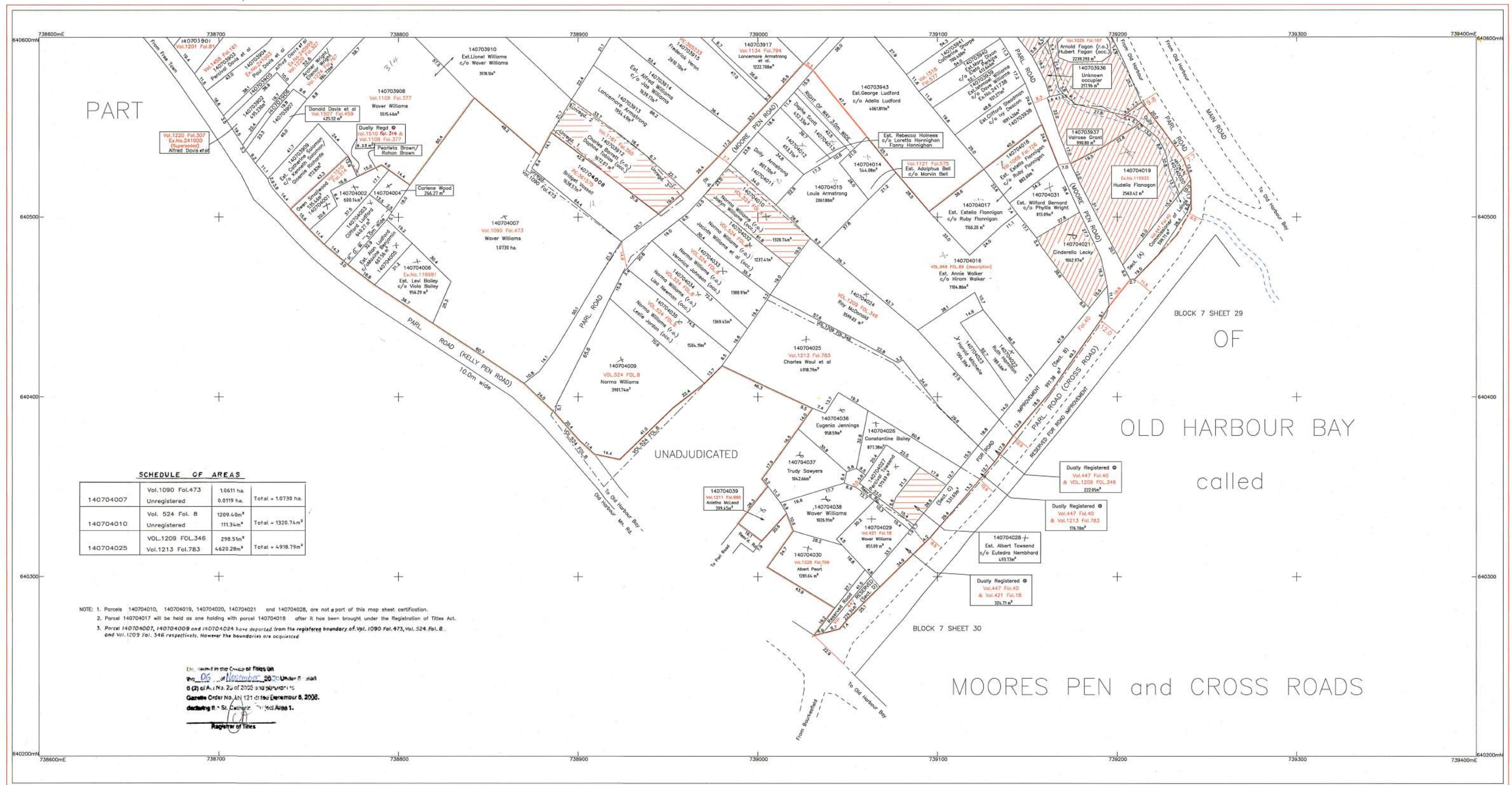

LEGEND

Volume and Folio: 1024/747

Property Boundary: ---

Deposited Plan Boundary: ---

Gully/Drain/River: ---

Registered Boundary: ---

SURVEY DATUM : JAD2001

Projection: Lambert Conformal Orthomorphic with one Standard Parallel

Spheroid: WGS 84

Unit of Measurement: Metre

Origin: 77 00 W of Greenwich
18 00 N of the Equator
750 000m Easting
650 000m Northing

Scale Factor at Origin: 1.000

Scale

10m 0 10 20 30 40 50 60 70 80 90 100 110 metres

SCALE: 1cm to 10m R.F. 1/1000
GRID INTERVAL 100m

CADASTRAL MAP

PART OF

OLD HARBOUR BAY

called

MOORES PEN and CROSS ROADS

ST. CATHERINE

NLA CADMAP CHECKED

C.R. Shab

For Director of Surveys

Date: 2020/06/15

Compiled by Land Management Consortium Ltd. from Plans annexed to Registered Titles, Plans by the Survey Department, Cadastral Records certified by the Survey Department and field observation of Property boundaries.

Completion Date: May 2003 and January to March 2018

Users noting errors or omissions are asked to return map to the Surveys and Mapping Division and it will be replaced.

Approved by: *Benjamin Bloomfield*
Director of Surveys

Parcel Count Table

No. of Clarification Parcels	13
No. of Regularisation Parcels	23
Total no. of Parcels	36

Example of Parcel Numbering

Parish	14
Block	07
Sheet	040
Parcel	01
Parcel #	140704001

Amended by: *Benjamin Bloomfield*
Commissioned Land Surveyor

Date: 15/06/2020
25/08/2020

PREPARED BY:
LAND MANAGEMENT CONSORTIUM LTD.
18 BELMONT ROAD
KINGSTON 5
Tel. 878-925-0699

1407040/1

CM 1407039- 774

CM 1407039- 774

Scale 1:1000 Cadastral Map

JAMAICA

LAMP BLOCK 7 - SHEET 39

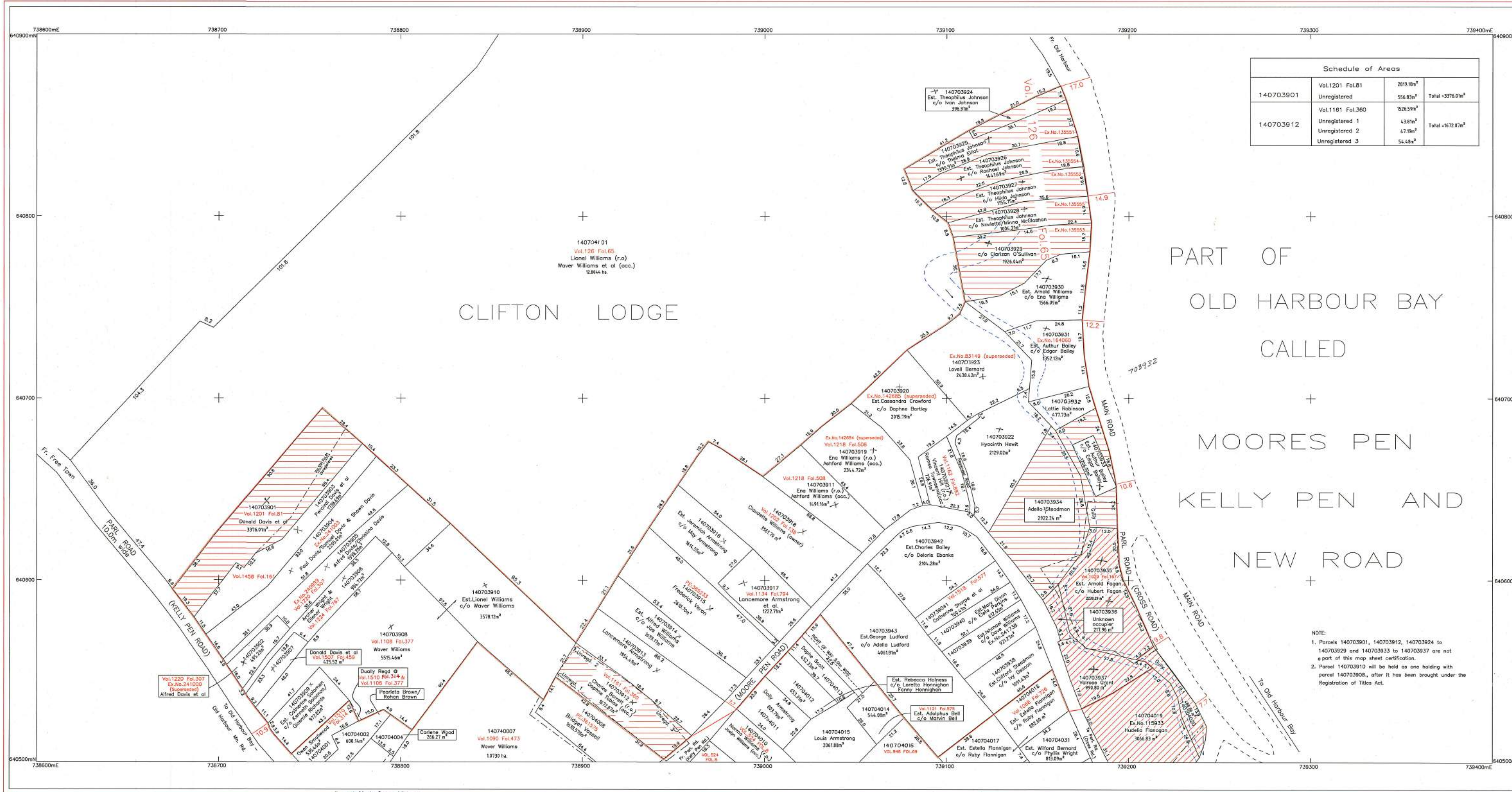

Schedule of Areas			
140703901	Vol.1201 Fol.81	2819.18m ²	Total = 3376.01m ²
	Unregistered	556.83m ²	
140703912	Vol.1161 Fol.360	1526.59m ²	Total = 1672.07m ²
	Unregistered 1	43.81m ²	
	Unregistered 2	47.79m ²	
	Unregistered 3	54.48m ²	

NOTE:
1. Parcels 140703901, 140703912, 140703924 to 140703929 and 140703933 to 140703937 are not a part of this map sheet certification.
2. Parcel 140703910 will be held as one holding with parcel 140703908, after it has been brought under the Registration of Titles Act.

Declared in the Office of Titles on the 16th of November 2020 Under Section 6 (2) of Act No. 25 of 2005 and pursuant to Gazette Order No. LN 121 dated December 5, 2020, declaring the St. Catherine's Project Area 1.

Register of Titles

SURVEY DATUM : JAD2001

LEGEND
Volume and Folio
Property Boundary
Deposited Plan Boundary
Cully/Drain/River
Registered Boundary

Projection: Lambert Conformal Orthomorphic with one Standard Parallel
Spheroid: WGS 84
Unit of Measurement: Metre
Origin: 77 00 W of Greenwich
False Co-ordinates of Origin: 18 00 N of the Equator
Scale Factor at Origin: 1.000

Certified that the area delineated on this map forms part of I.A.M.P. St. Catherine's Project Area 1
Granted at order No. LN 121 dated 2006/12/05
Dated the 15th of June 2020
C.R. Shaul
For Director of Surveys

CADASTRAL MAP
PART OF
OLD HARBOUR BAY
CALLED
MOORES PEN, KELLY PEN
AND NEW ROAD
ST. CATHERINE

metres 10 0 10 20 30 40 50 60 70 80 90 100 110 metres
SCALE : 1cm To 10m R.F. 1/1000
GRID INTERVAL 100m



NLA CADMAP
CHECKED
C.R. Shaul
For Director of Surveys
Date 2020/06/15

Compiled by Land Management Consortium Ltd. from Plans annexed to Registered Titles, Plans by the Survey Department, Cadastral Records certified of the Survey Department and Field observation of Property boundaries.
Compilation Date: May 2003 and January to March 2018
Users noting errors or omissions are asked to return map to the Surveys and Mapping Division and it will be replaced.

Approved by
Director of Surveys

Parcel Count Table	
No. of Clarification Parcels	12
No. of Regularisation Parcels	18
Total no. of Parcels	30

Example of Parcel Numbering	
Parish	14
Block	07
Sheet	039
Parcel	01
Parcel #	140703901

Amended by
Benjamin Bloomfield
Commissioned Land Surveyor
Date 15/06/2020
25/08/2020
PREPARED BY
LAND MANAGEMENT CONSORTIUM LTD.
18 BELMONT ROAD
KINGSTON 5
Tel. 878-925-0599

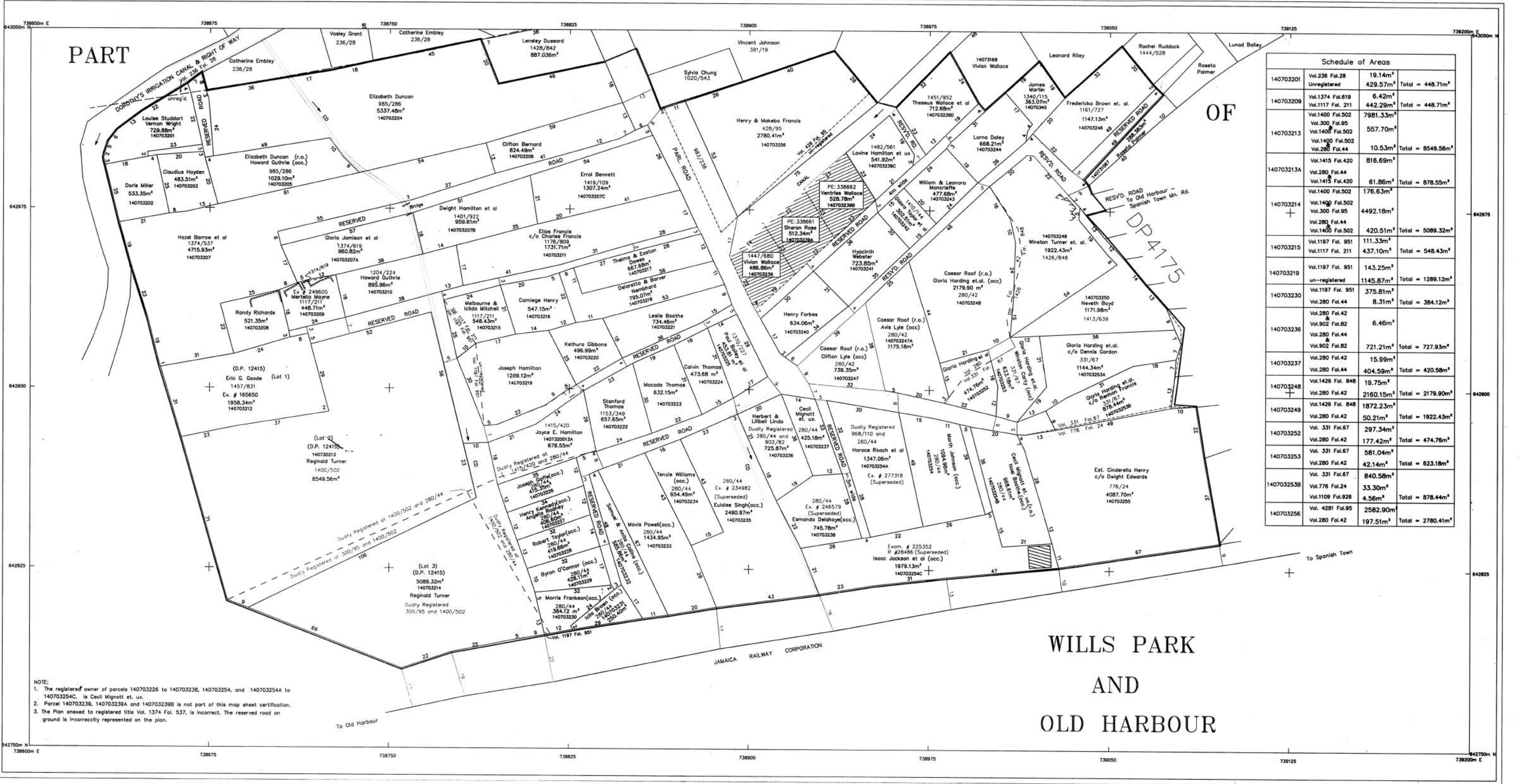

Schedule of Areas			
140703201	Vol.236 Fol.28 Unregistered	19.14m ² 429.57m ²	Total = 448.71m ²
140703209	Vol.1374 Fol.619 Vol.1117 Fol. 211	6.42m ² 442.29m ²	Total = 448.71m ²
140703213	Vol.1400 Fol.502 Vol.300 Fol.95 Vol.1400 Fol.502 Vol.280 Fol.44	7981.33m ² 557.70m ² 10.53m ²	Total = 8549.56m ²
140703213A	Vol.1415 Fol.420 Vol.280 Fol.44 Vol.1415 Fol.420	816.69m ² 61.86m ²	Total = 878.55m ²
140703214	Vol.1400 Fol.502 Vol.300 Fol.95 Vol.280 Fol.44 Vol.1400 Fol.502	176.63m ² 4492.18m ² 420.51m ²	Total = 5089.32m ²
140703215	Vol.1197 Fol. 951 Vol.1117 Fol. 211	111.33m ² 437.10m ²	Total = 548.43m ²
140703219	Vol.1197 Fol. 951 un-registered	143.25m ² 1145.87m ²	Total = 1289.12m ²
140703230	Vol.1197 Fol. 951 Vol.280 Fol.44	375.81m ² 8.31m ²	Total = 384.12m ²
140703236	Vol.280 Fol.42 Vol.902 Fol.82 Vol.280 Fol.44 Vol.902 Fol.82	6.46m ² 721.21m ²	Total = 727.93m ²
140703237	Vol.280 Fol.42 Vol.280 Fol.44	15.99m ² 404.59m ²	Total = 420.58m ²
140703248	Vol.1426 Fol. 848 Vol.280 Fol.42	19.75m ² 2160.15m ²	Total = 2179.90m ²
140703249	Vol.1426 Fol. 848 Vol.280 Fol.42	1872.23m ² 50.21m ²	Total = 1922.43m ²
140703252	Vol. 331 Fol.67 Vol.280 Fol.42	297.34m ² 177.42m ²	Total = 474.76m ²
140703253	Vol. 331 Fol.67 Vol.280 Fol.42	581.04m ² 42.14m ²	Total = 623.18m ²
140703253B	Vol. 331 Fol.67 Vol.776 Fol.24 Vol.1109 Fol.928	840.58m ² 33.30m ² 4.56m ²	Total = 878.44m ²
140703256	Vol. 4281 Fol.95 Vol.280 Fol.42	2582.90m ² 197.51m ²	Total = 2780.41m ²

WILLS PARK
AND
OLD HARBOUR

NOTE:
1. The registered owner of parcels 140703226 to 140703238, 140703254, and 140703254A to 140703254C, is Cecil Mignott et. ux.
2. Parcel 140703239, 140703239A and 140703239B is not part of this map sheet certification.
3. The Plan annexed to registered title Vol. 1374 Fol. 537, is incorrect. The reserved road on ground is incorrectly represented on the plan.

Certified that the area delineated on this map
form part of LAMP St. Catherine Project Area 1
Gazetted at Order No. LN 121 dated December 5, 2008
Dated the 24th of October 2016

C.R. Shaw
Director of Survey

LEGEND

Volume and Folio ----- 1084/767

Property Boundary -----

Deposited Plan Boundary -----

Gully/Drain/River -----

SURVEY DATUM : JAD2001

Projection: Lambert Conical Orthomorphic with one Standard Parallel

Spheroid: WGS 84

Unit of Measurement: Metre

Origin: 77 00 W. of Greenwich
18 00 N. of the Equator

False Co-ordinates of Origin: 750 000m Easting
650 000m Northing

Scale Factor at Origin: 1.000

NLA CADMAP
CHECKED

For Director of Survey

Date 2016/10/24

SCALE : 1cm To 7.5m R.F. 1/750
AND INTERVAL 75m

CADASTRAL MAP

PART OF
WILLIS PARK, CHURCH PEN
AND
OLD HARBOUR
ST. CATHERINE

Compiled by Land Management Consortium Ltd.
from Plans annexed to Registered Titles, Plans
by the Survey Department, Cadastral Records
certified by the Survey Department and Field
observation of Property boundaries.

Compilation Date: May 2003

Users noting errors or omissions are asked
to return map to the Survey and Mapping
Division and it will be replaced.

Amended by: *Nicholas E. Hinds*
Commissioned Land Surveyor
Date 2016/10/24

PREPARED BY
LAND MANAGEMENT CONSORTIUM LTD.
18 BELMONT ROAD
KINGSTON 5
Tel. 876-825-0899

Parcel Count Table

No. of Clarification Parcels	23
No. of Regularisation Parcels	46
Total no. of Parcels	69

Example of Parcel Numbering

Parish	14		
Block	07		
Sheet		032	
Parcel			41
Parcel #	140703241		

L14 07 032