



<div></div> <div>ADJUDICATION RECORD</div> <div>PURSUANT TO SECTION 8A (1) (e) and 8A (1) (g) OF THE</div> <div>REGISTRATION OF TITLES CADASTRAL MAPPING AND TENURE CLARIFICATION (SPECIAL PROVISIONS) ACT</div>																			
SYSTEMATIC ADJUDICATION AREA : PART OF ROSE HALL, SAINT ELIZABETH (Part 4)																			
	LAND INFORMATION									PERSONAL DETAILS	OCCUPANCY DETAILS								
APPLICATION NO.	CADASTRAL MAP NUMBER	CADASTRAL MAP PARCEL NUMBER	LAND VALUATION NUMBER	AREA	PLACE	PARISH	VOLUME/FOLIO	PROPERTY ADDRESS	NATURE OF PARCEL	OWNER(S) DETAILS	NATURE BY WHICH LAND WAS ACQUIRED	NATURE OF OWNER DISABILITY	NAME, ADDRESS AND OCCUPATION OF GUARDIAN	NATURE OF TITLE	DETAILS OF ENCUMBRANCES	RESTRICTIONS ON POWER TO DEAL WITH LAND	DETAILS OF PERSON ENTITLED TO BENEFIT OF RESTRICTION	DOCUMENTS PRESENTED	DATE OF COMPLETION OF APPLICATION FORM
ASD009853	CM1130007-840	113000701		5695.082 Square Meter	ROSE HALL	St. Elizabeth		Rose Hall District, St. Elizabeth	Private	- Melbourne Reonder Sinclair Entrepreneur of Rose Hall District, Rose Hall P.O. St. Elizabeth Jamaica	Possession			Absolute					2022-04-18
ASD009854	CM1130007-840	113000702		7526.363 Square Meter	ROSE HALL	St. Elizabeth		Rose Hall District, St. Elizabeth	Private	- Melbourne Reonder Sinclair Entrepreneur of Rose Hall District, Rose Hall P.O. St. Elizabeth Jamaica	Possession			Absolute					2022-04-18
ASD009855	CM1130007-840	113000703		8631.126 Square Meter	ROSE HALL	St. Elizabeth		Rose Hall District, St. Elizabeth	Private	- Melbourne Reonder Sinclair Entrepreneur of Rose Hall District, Rose Hall P.O. St. Elizabeth Jamaica	Possession			Absolute					2022-04-18
ASD009856	CM1130007-840	113000704		9614.034 Square Meter	ROSE HALL	St. Elizabeth		Rose Hall District, St. Elizabeth	Private	- Melbourne Reonder Sinclair Entrepreneur of Rose Hall District, Rose Hall P.O. St. Elizabeth Jamaica	Possession			Absolute					2022-04-18
ASD009819	CM1130007-840	113000705		4071.86 Square Meter	ROSE HALL	St. Elizabeth		Rose Hall District, St. Elizabeth	Private	- John Antonie Sinclair Poet of Rose Hall District, Rose Hall P.O St. Elizabeth Jamaica	Possession			Absolute					2022-04-16
ASD009776	CM1130007-840	113000706		3925.246 Square Meter	ROSE HALL	St. Elizabeth		Rose Hall District, St. Elizabeth	Private	- Alton George Sinclair Driver of Olympic Court, Bay Farm Road, Kingston 11 Kingston Jamaica	Possession			Absolute					2022-04-12
ASD009905	CM1130007-840	113000707		2340.026 Square Meter	ROSE HALL	St. Elizabeth		Rose Hall District, St. Elizabeth	Private	- Joan Audrey Reid Academic Program Coordinator of 365 Bridge Street, Brooklyn New York United States	Possession			Absolute					2022-04-20
ASD009902	CM1130007-840	113000708		2155.249 Square Meter	ROSE HALL	St. Elizabeth		Rose Hall District, St. Elizabeth	Crown	- Commissioner of Lands of 20 North Street Kingston Jamaica	Special Provisions Act			Absolute					2022-04-20
ASD009779	CM1130007-840	113000709		3742.195 Square Meter	ROSE HALL	St. Elizabeth		Rose Hall District, St. Elizabeth	Private	- Omar St. Aublyn Johnson Construction Worker of Rose Hall District, Rose Hall P.O. St. Elizabeth Jamaica	Possession			Absolute					2022-04-12
ASD009865	CM1130007-840	113000710		1004.541 Square Meter	ROSE HALL	St. Elizabeth		Rose Hall District, St. Elizabeth	Private	- Melbourne Reonder Sinclair Entrepreneur of Rose Hall District, Rose Hall P.O. St. Elizabeth Jamaica - John Antonie Sinclair Poet of Rose Hall District, Rose Hall P.O St. Elizabeth Jamaica	Possession			Absolute					2022-04-16
ASD009871	CM1130007-840	113000711		4412.904 Square Meter	ROSE HALL	St. Elizabeth		Rose Hall District, St. Elizabeth	Private	- Melbourne Reonder Sinclair Entrepreneur of Rose Hall District, Rose Hall P.O. St. Elizabeth Jamaica	Possession			Absolute					2022-04-16
ASD009858	CM1130007-840	113000712		3.1748 Hectare	ROSE HALL	St. Elizabeth		Rose Hall District, St. Elizabeth	Private	- Melbourne Reonder Sinclair Entrepreneur of Rose Hall District, Rose Hall P.O. St. Elizabeth Jamaica	Possession			Absolute					2022-04-18
<p>The Adjudication Record was displayed in the Systematic Adjudication Area on    May 4, 2022    and shall remain on display for a period of THIRTY (30) days.</p> <p>During this period, the Senior Director, Adjudication Services may amend any minor error or omission not materially affecting the interest of any person. Therefore, any Applicant who considers the Adjudication Record to be contain minor inaccuracies or omissions, may within THIRTY (30) days of the date of display of the Adjudication Record, submit the details of such inaccuracies or omissions in the prescribed Form and manner.</p> <p>Any person who objects to an Applicant's claim to ownership rights and interests in a parcel of land on the Adjudication Record, may within THIRTY (30) days of the date of display of the said Record submit the grounds for objection in the prescribed Form and manner.</p> <p>The prescribed Forms (Amendment of the Adjudication Record or Objection to the Adjudication Record) are available at any National Land Agency office or via the Agencies website at: <a href="http://www.nla.gov.jm">www.nla.gov.jm</a></p> <p>All Requests for Amendment of the Adjudication Record or Objection to the Adjudication Record must be submitted using the prescribed Form to the Senior Director, Adjudication Services at:</p> <p>National Land Agency 8 Ardenne Road Kingston 10 Saint Andrew</p> <p>This Record comprises applications for lands located within Rose Hall, St. Elizabeth and more particularly, being Cadastral Map Numbers CM1130007-840</p> <div></div> <p>Senior Director, Adjudication Services</p> <p>Display Date: <u>May 4, 2022</u></p>																			



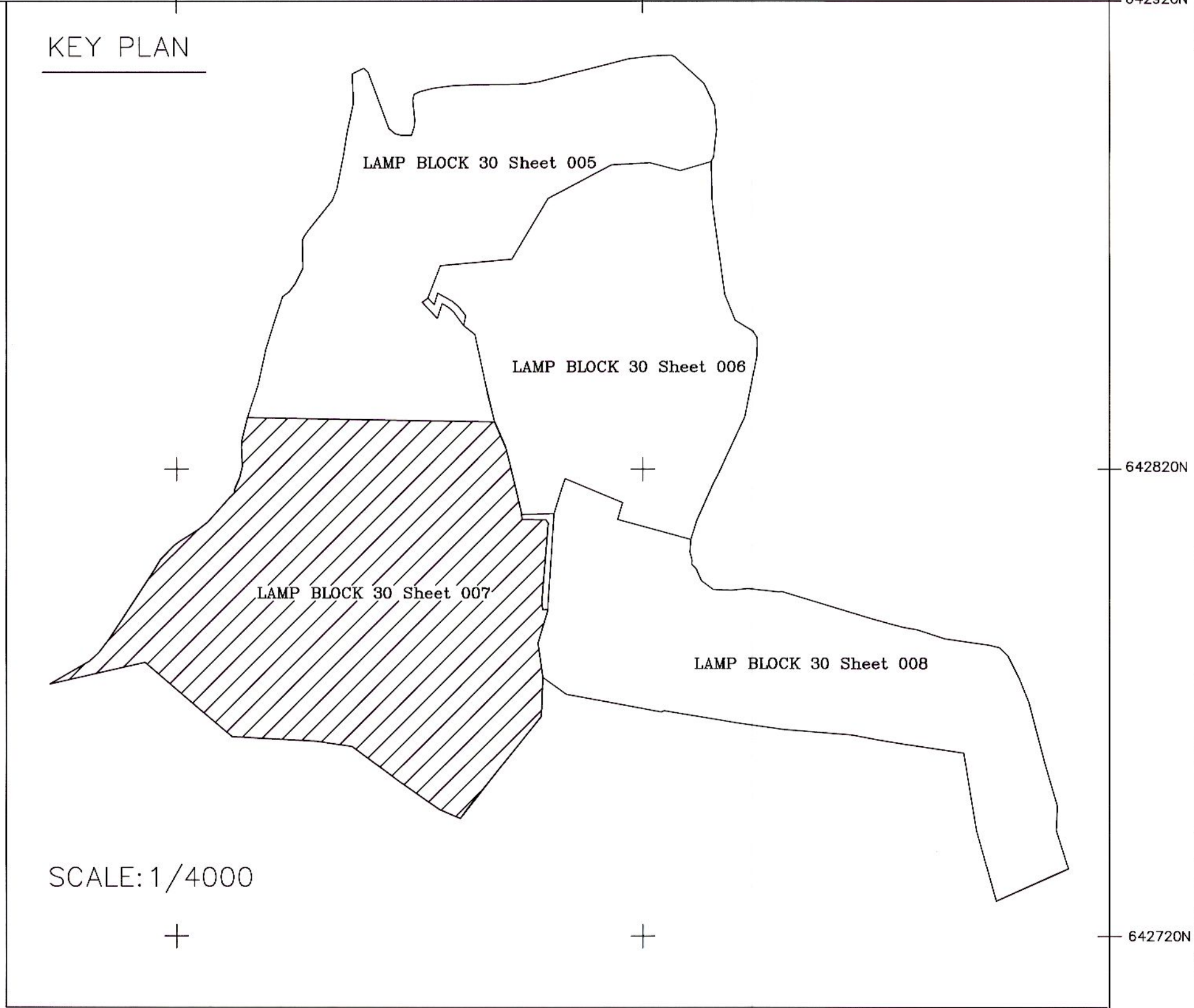
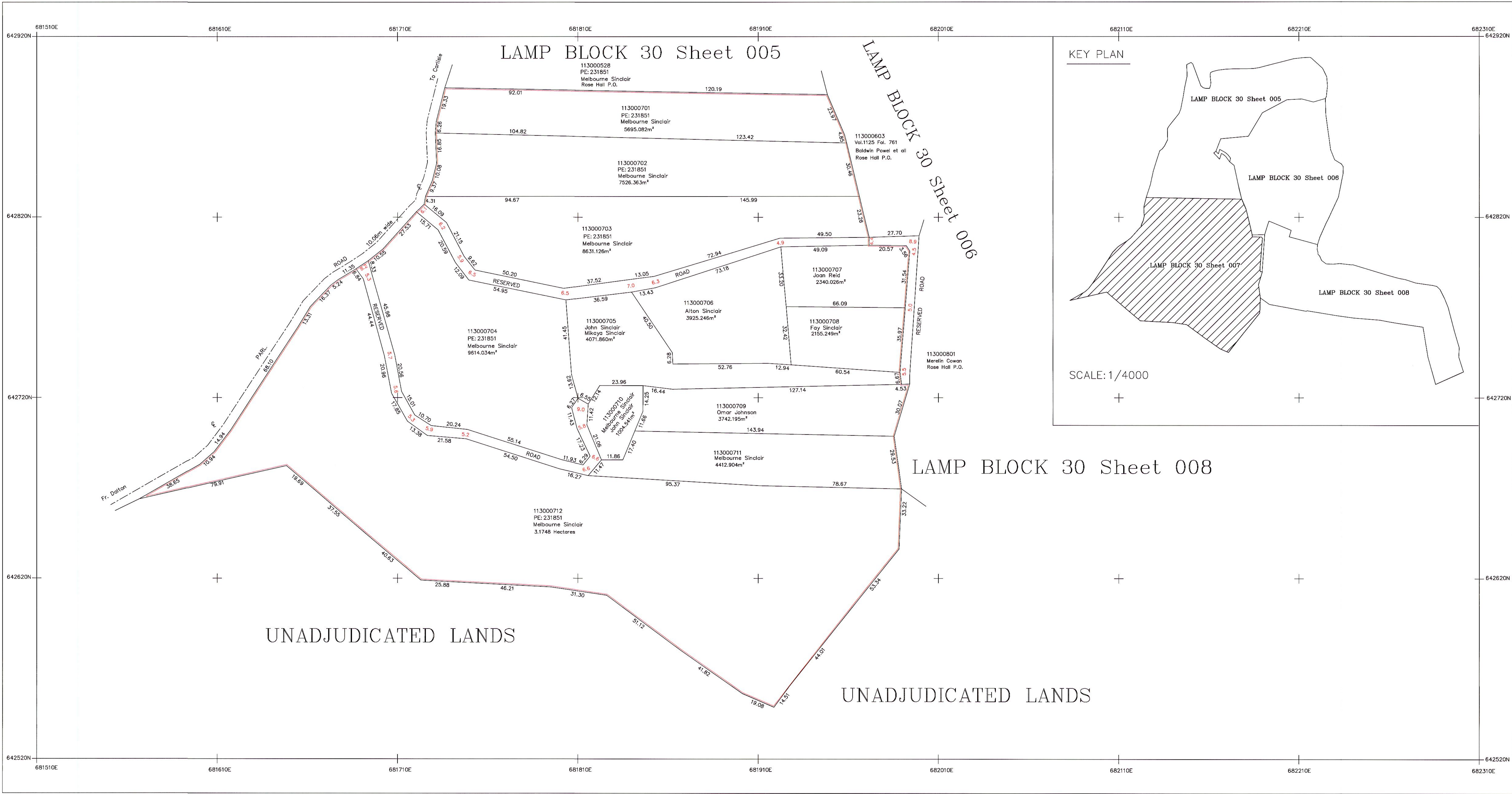

**LEGEND**

Volume and Folio-----	Vol.1010 Fol.20
Property Boundary-----	-----
Deposited Plan Boundary-----	-----
Gully/Drain/River-----	-----
Registered Boundary-----	-----

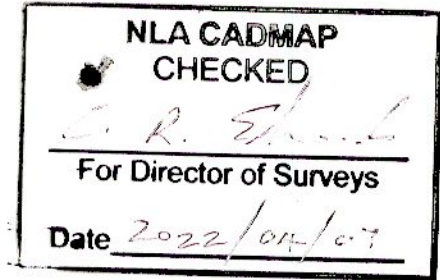

**SURVEY DATUM JAD2001**

Projection: Lambert Conical Orthomorphic with one Standard Parallel  
Unit of Measurement: One Standard Parallel  
Origin: 77° 00' 00"W of Greenwich  
False Coordinates of Origin: 750,000m Easting 650 000m Northing  
Scale Factor at Origin: 1,000

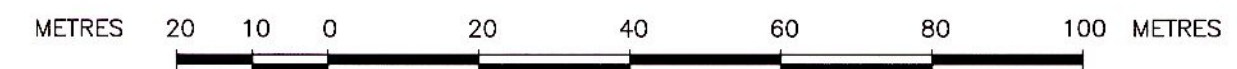

SCALE 1 : 1000  
1cm to 10m  
GRID INTERVAL 100 m

**CADASTRAL MAP OF PART OF ROSE HALL**  
ST. ELIZABETH

Date of survey: February 21–28, 2022

**Parcel Count Table**

No. of Clarification Parcels	0
No. of Regularisation Parcels	12
Total no. of Parcels	12

Certified that the area delineated on this map forms part of Systematic Land Titting  
Project Area Rose Hall, St. Elizabeth  
Declared by the Honourable Minister  
On the 5th of August 2021  
P. Hendricks  
For Sr. Director, Surveys and Mapping Division

SURVEYOR: P. Hendricks  
PATRICK HENDRICKS  
COMMISSIONED LAND SURVEYOR  
GEOLAND TITLE LIMITED  
DATE: April 4, 2022

**Example of parcel numbering**

Parish	11				
Block		30			
Sheet			007		
Parcel (Lot)				30	
Parcel #	113000730				

PREPARED BY  
GEOLAND TITLE LIMITED  
Suite 1 1 1/2 Altamont Crescent  
Kingston 5  
St. Andrew Jamaica, W.I.  
TEL. (876)908-0192

Notices were served on all adjoining owners and can be produced if necessary  
There were no objections to the survey  
INSTRUMENT USED NIKON DTM 322 SN D069168  
GPS USED GPS LEICA GS14 SN 2805976  
DATE OF INST. CHECK 2021/01/29

Compiled by GEOLAND LIMITED from Plans annexed to Registered Titles, Plans certified by the Survey Department, Cadastral Records of the Survey Department and Field observation of Property boundaries.  
Compilation date:  
Users noting errors or omissions are asked to return map to the Survey Department and it will be replaced.

L1130007