



ADJUDICATION RECORD
PURSUANT TO SECTION 8A (1) (e) and 8A (1) (g) OF THE
REGISTRATION OF TITLES CADASTRAL MAPPING AND TENURE CLARIFICATION (SPECIAL PROVISIONS) ACT

SYSTEMATIC ADJUDICATION AREA : PART OF FLAGAMAN, PART II SAINT ELIZABETH (Part 2)

APPLICATION NO.	LAND INFORMATION									PERSONAL DETAILS	OCCUPANCY DETAILS								
	CADASTRAL MAP NUMBER	CADASTRAL MAP PARCEL NUMBER	LAND VALUATION NUMBER	AREA	PLACE	PARISH	VOLUME/FOLIO	PROPERTY ADDRESS	NATURE OF PARCEL	OWNER(S) DETAILS	NATURE BY WHICH LAND WAS ACQUIRED	NATURE OF OWNER DISABILITY	NAME, ADDRESS AND OCCUPATION OF GUARDIAN	NATURE OF TITLE	DETAILS OF ENCUMBRANCES	RESTRICTIONS ON POWER TO DEAL WITH LAND	DETAILS OF PERSON ENTITLED TO BENEFIT OF RESTRICTION	DOCUMENTS PRESENTED	DATE OF COMPLETION OF APPLICATION FORM
ASD008362	CM1157171-853	115717101		3016.66 Square Meter	FLAGAMAN	St. Elizabeth	Partially registered at Volume 1295 Folio 734 (19.09 square metres) and unregistered (2997.57 square metres)	Flagaman District, St. Elizabeth	Private	- Anneth Stewart Retired Nurse of Flagaman District, Treasure Beach P.O. St. Elizabeth Jamaica - Bim Albert Ebanks Farmer of Flagaman District, Treasure Beach P.O. St. Elizabeth Jamaica - Diana Clarke Retiree of Flagaman District, Treasure Beach P.O. St. Elizabeth Jamaica - Euphame Ebanks Personal Support Worker of Flagaman District, Treasure Beach P.O. St. Elizabeth Jamaica	Possession			Qualified					2022-01-19
ASD008329	CM1157171-853	115717103		6162.51 Square Meter	FLAGAMAN	St. Elizabeth		Flagaman District, St. Elizabeth	Private	- Grace Ebanks Housewife of Flagaman District, Treasure Beach P.O. St. Elizabeth Jamaica	Possession			Absolute					2022-01-19
ASD008297	CM1157171-853	115717104		1837.19 Square Meter	FLAGAMAN	St. Elizabeth		Flagaman District, St. Elizabeth	Private	- John St. Helma Clarke Farmer of Flagaman District, Treasure Beach P.O. St. Elizabeth Jamaica	Possession			Absolute					2022-01-19
ASD008397	CM1157171-853	115717106		3774.48 Square Meter	FLAGAMAN	St. Elizabeth		Flagaman District, St. Elizabeth	Private	- Damon Blackwood Bus Driver of Flagaman District, Treasure Beach P.O. St. Elizabeth Jamaica	Possession			Absolute					2022-01-19
ASD008366	CM1157171-853	115717107		1432.36 Square Meter	FLAGAMAN	St. Elizabeth		Flagaman District, St. Elizabeth	Crown	- Commissioner of Lands of 20 North Street Kingston Jamaica	Special Provisions Act			Absolute	Right of Way				2022-01-19
ASD008358	CM1157171-853	115717108		2415.36 Square Meter	FLAGAMAN	St. Elizabeth		Flagaman District, St. Elizabeth	Private	- Weeville McArthur Powell Farmer of Flagaman District, Treasure Beach P.O. St. Elizabeth Jamaica - Blossom Powell Farmer of Flagaman District, Flagaman P.A. St. Elizabeth Jamaica	Possession			Absolute					2022-01-19
ASD008365	CM1157171-853	115717110		2557.97 Square Meter	FLAGAMAN	St. Elizabeth		Flagaman District, St. Elizabeth	Crown	- Commissioner of Lands of 20 North Street Kingston Jamaica	Special Provisions Act			Absolute	Right of Way				2022-01-19
ASD008368	CM1157171-853	115717113		1940.37 Square Meter	FLAGAMAN	St. Elizabeth		Flagaman District, St. Elizabeth	Private	- Joy Dawn Curtin Accountant of 1054 March Drive, Valley Stream New York 11580 United States	Possession			Absolute					2022-01-19
ASD008359	CM1157171-853	115717114		556.97 Square Meter	FLAGAMAN	St. Elizabeth		Flagaman District, St. Elizabeth	Private	- Jacqueline Desrene Stough Hairdresser of Flagaman District, Treasure Beach P.O. St. Elizabeth Jamaica	Gift			Absolute					2022-01-19
ASD008437	CM1157171-853	115717115		758.83 Square Meter	FLAGAMAN	St. Elizabeth		Flagaman District, St. Elizabeth	Private	- Ricardo Carlinton James Truck Driver of 24 Cedar Hill Crescent, Kitchener Ontario N2E2H4 Canada	Gift			Absolute					2022-01-19
ASD008215	CM1157171-853	115717116		433.47 Square Meter	FLAGAMAN	St. Elizabeth		Flagaman District, St. Elizabeth	Private	- Sefton Ebanks Farmer of Flagaman District, Treasure Beach P.O. St. Elizabeth Jamaica	Possession			Absolute				- Affidavits/ Statutory Declaration(s)	2022-01-17
ASD008300	CM1157171-853	115717117		402.41 Square Meter	FLAGAMAN	St. Elizabeth		Flagaman District, St. Elizabeth	Private	- Berel Honeyghan Farmer of Flagaman District, Pedro Plains P.O. St. Elizabeth Jamaica	Possession			Absolute					2022-01-19
ASD008212	CM1157171-853	115717118		688.82 Square Meter	FLAGAMAN	St. Elizabeth		Flagaman District, St. Elizabeth	Private	- Josephine Ebanks Retired Farmer of Flagaman District, Treasure Beach P.O. St. Elizabeth Jamaica	Purchase			Absolute				- Property Tax Receipts - Affidavits/ Statutory Declaration(s)	2022-01-17
ASD008776	CM1157171-853	115717121		1.2 Hectare	FLAGAMAN	St. Elizabeth		Flagaman District, St. Elizabeth	Private	- Kingsley Adolphus Ebanks Retiree of 4428 Elm Ave, Brookfield Illinois 60513 United States	Possession			Qualified					2022-01-19
ASD008295	CM1157171-853	115717124		652.46 Square Meter	FLAGAMAN	St. Elizabeth		Flagaman District, St. Elizabeth	Private	- Ryan Junior Bent Dietician of Flagaman District, Flagaman P.A. St. Elizabeth Jamaica	Possession			Absolute	Right Of Way				2022-01-19
ASD008298	CM1157171-853	115717125		1215.98 Square Meter	FLAGAMAN	St. Elizabeth		Flagaman District, St. Elizabeth	Private	- Raphael Bent Retired Machine Operator of Flagaman District, Flagaman P.A. St. Elizabeth Jamaica	Possession			Absolute					2022-01-19



ADJUDICATION RECORD
PURSUANT TO SECTION 8A (1) (e) and 8A (1) (g) OF THE
REGISTRATION OF TITLES CADASTRAL MAPPING AND TENURE CLARIFICATION (SPECIAL PROVISIONS) ACT

SYSTEMATIC ADJUDICATION AREA : PART OF FLAGAMAN, PART II SAINT ELIZABETH (Part 2)

APPLICATION NO.	LAND INFORMATION									PERSONAL DETAILS	OCCUPANCY DETAILS								
	CADASTRAL MAP NUMBER	CADASTRAL MAP PARCEL NUMBER	LAND VALUATION NUMBER	AREA	PLACE	PARISH	VOLUME/FOLIO	PROPERTY ADDRESS	NATURE OF PARCEL	OWNER(S) DETAILS	NATURE BY WHICH LAND WAS ACQUIRED	NATURE OF OWNER DISABILITY	NAME, ADDRESS AND OCCUPATION OF GUARDIAN	NATURE OF TITLE	DETAILS OF ENCUMBRANCES	RESTRICTIONS ON POWER TO DEAL WITH LAND	DETAILS OF PERSON ENTITLED TO BENEFIT OF RESTRICTION	DOCUMENTS PRESENTED	DATE OF COMPLETION OF APPLICATION FORM
ASD008327	CM1157171-853	115717126		509.44 Square Meter	FLAGAMAN	St. Elizabeth		Flagaman District, St. Elizabeth	Private	- Aston Vernon Allen Retiree of Flagaman District, Flagaman P.A. St. Elizabeth Jamaica	Possession			Absolute					2022-01-19
ASD008292	CM1157171-853	115717127		981.72 Square Meter	FLAGAMAN	St. Elizabeth		Flagaman District, St. Elizabeth	Private	- Julie Ann Bent Personal Support Worker of Flagaman District, Flagaman P.A. St. Elizabeth Jamaica	Possession			Absolute	Right Of Way				2022-01-19
ASD008341	CM1157171-853	115717128		432.02 Square Meter	FLAGAMAN	St. Elizabeth		Flagaman District, St. Elizabeth	Private	- Cecil Roy Pessoa Farm Store Operator of 5a Fustic Road, Montego Bay St. James Jamaica	Possession			Absolute					2022-01-19
ASD008363	CM1157171-853	115717129		3179.53 Square Meter	FLAGAMAN	St. Elizabeth		Flagaman District, St. Elizabeth	Crown	- Commissioner of Lands of 20 North Street Kingston Jamaica	Special Provisions Act			Absolute					2022-01-19
ASD010739	CM1157171-853	115717130		3859.67 Square Meter	FLAGAMAN	St. Elizabeth		Flagaman District, St. Elizabeth	Crown	- Commissioner of Lands of 20 North Street Kingston Jamaica	Special Provisions Act			Absolute					2022-06-06
ASD008355	CM1157171-853	115717131		1861.67 Square Meter	FLAGAMAN	St. Elizabeth		Flagaman District, St. Elizabeth	Private	- Joyce Legister Retired Manager of 1495 Oakburn ST, Pickering Ontario L1V 6N7 Canada	Possession			Absolute					2022-01-19
ASD008356	CM1157171-853	115717132		1606.86 Square Meter	FLAGAMAN	St. Elizabeth		Flagaman District, St. Elizabeth	Private	- Monica Ileen Ebanks Retired Health Care Worker of Billy's Bay District, Treasure Beach, Calabash P.A. St. Elizabeth Jamaica	Possession			Absolute					2022-01-19
ASD008360	CM1157171-853	115717133		1458.98 Square Meter	FLAGAMAN	St. Elizabeth		Flagaman District, St. Elizabeth	Private	- Douane Joseph Ebanks Alias Ted Auditor of 9455 209 St NW Edmonton Alberta T5T 7J5 Canada	Possession			Absolute					2022-01-19
ASD008441	CM1157171-853	115717134		790.63 Square Meter	FLAGAMAN	St. Elizabeth		Flagaman District, St. Elizabeth	Private	- Bernice Ware Retired Nurse of 176 Luke Cove, Hampton Georgia United States	Possession			Absolute					2022-01-19
ASD008361	CM1157171-853	115717135		451.35 Square Meter	FLAGAMAN	St. Elizabeth		Flagaman District, St. Elizabeth	Private	- Muriel Eunice Ebanks Retired Housewife of Flagaman District, Treasure Beach P.O. St. Elizabeth Jamaica	Possession			Absolute					2022-01-19

The Adjudication Record was displayed in the Systematic Adjudication Area on June 21, 2022 and shall remain on display for a period of THIRTY (30) days.

During this period, the Senior Director, Adjudication Services may amend any minor error or omission not materially affecting the interest of any person. Therefore, any Applicant who considers the Adjudication Record to contain minor inaccuracies or omissions, may within THIRTY (30) days of the date of display of the Adjudication Record, submit the details of such inaccuracies or omissions in the prescribed Form and manner.

Any person who objects to an Applicant's claim to ownership rights and interests in a parcel of land on the Adjudication Record, may within THIRTY (30) days of the date of display of the said Record submit the grounds for objection in the prescribed Form and manner.

The prescribed Forms (Amendment of the Adjudication Record or Objection to the Adjudication Record) are available at any National Land Agency office or via the Agency's website at: www.nla.gov.jm

All Requests for Amendment of the Adjudication Record or Objection to the Adjudication Record must be submitted using the prescribed Form to the Senior Director, Adjudication Services at:

National Land Agency
 8 Ardenne Road
 Kingston 10
 Saint Andrew

This Record comprises applications for lands located within Flagaman Part II, St. Elizabeth and more particularly, being Cadastral Map Number CM1157171-853.

Display Date: June 21, 2022

Senior Director,
 Adjudication
 Services

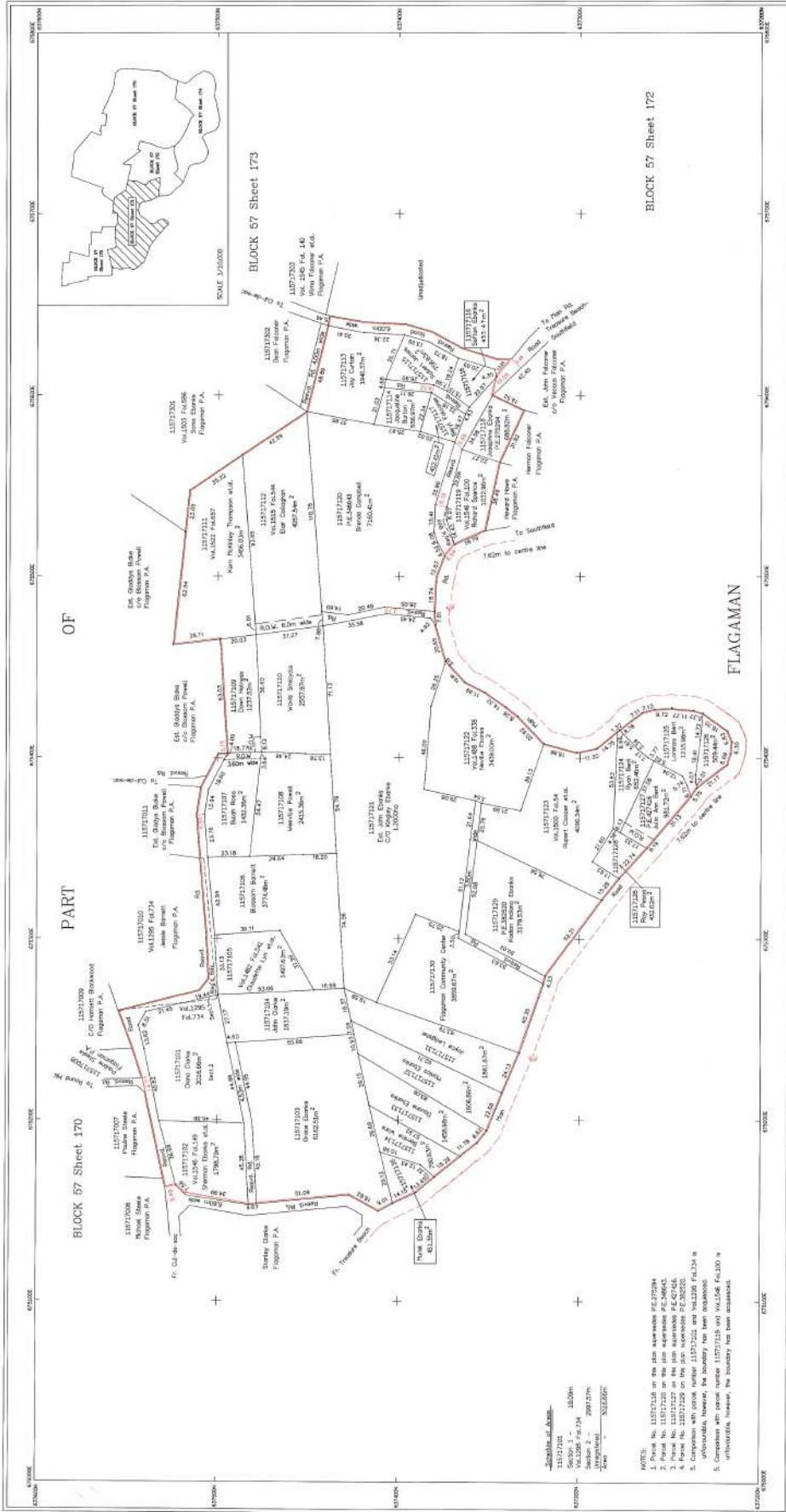

Parcel	Color	Block	Color
01	Blue	01	Blue
02	Green	02	Green
03	Yellow	03	Yellow
04	Red	04	Red
05	Purple	05	Purple
06	Orange	06	Orange
07	Brown	07	Brown

LEGEND

Water and Foliage: Blue line

Property Boundary: Red line

Registered Boundary: Dashed line

City/Over/Under: Dotted line

Date of survey: October 12, 2021 - November 12, 2021

There was no objection to the survey.

Access was secured on all adjoining owners and on available open spaces.

Owners/occupiers of land forming the subject of survey were also notified.

Date of work: 12/12/2021

Scale of work: 1:1000

Date of this edition: 10/12/2021

SURVEY DATUM JAD2001

Projection: Universal Transverse Mercator with Spheroid

Date of Measurement: 2021

Scale: 1:1000

Horizontal Accuracy: ± 10mm

Vertical Accuracy: ± 20mm

FLAGAMAN

ST. CLAREMONT

Vol. 1482 Fol. 051, Vol. 1322 Fol. 057, Vol. 1315 Fol. 544, Vol. 1546 Fol. 000

Vol. 1488 Fol. 336, Vol. 1500 Fol. 54, Vol. 1505 Fol. 734 and Unregistered Lands

SCALE 1: 1000

1cm to 10m

GRID INTERVAL 100 m

Completed by GEQAND LIMITED
 Surveyed by the Survey Department in accordance with the provisions of the Survey Act, Chapter 1:01, and the Regulations thereunder.

Surveyed by: DAMAN MACRANE
 COMMISSIONED LAND SURVEYOR
 GEORGE TOWN, JAMAICA

GEQAND

REGARDED BY
 GEORGE TOWN LIMITED
 52-60 DREYFUS CRESCENT
 S.W. 15th Avenue, Jamaica, W.I.
 TEL. 878908-0132

NOTES:

- Parcel No. 115771218 on the plan superseded P.E. 27294
- Parcel No. 115771220 on the plan superseded P.E. 306643
- Parcel No. 115771222 on the plan superseded P.E. 306643
- Parcel No. 115771228 on the plan superseded P.E. 306643
- Companion with parcel number 115771252 and Vol. 1250 Fol. 224 is unobtainable, however, the boundary has been established.
- Companion with parcel number 115771210 and Vol. 1508 Fol. 200 is unobtainable, however, the boundary has been established.

Schedule of Lots:

115771202	350m ²
115771203	350m ²
115771204	350m ²
115771205	350m ²

Parcel Count Table:

Parcel Count Table	No. of Classification Parcels	No. of Registration Parcels	Total no. of Parcels
Parcel 11	8	27	35
Parcel 171	1	171	172
Parcel 172	1	171	172
Parcel 173	1	171	172
Parcel 174	1	171	172
Parcel 175	1	171	172
Parcel 176	1	171	172
Parcel 177	1	171	172
Parcel 178	1	171	172
Parcel 179	1	171	172
Parcel 180	1	171	172
Parcel 181	1	171	172
Parcel 182	1	171	172
Parcel 183	1	171	172
Parcel 184	1	171	172
Parcel 185	1	171	172
Parcel 186	1	171	172
Parcel 187	1	171	172
Parcel 188	1	171	172
Parcel 189	1	171	172
Parcel 190	1	171	172
Parcel 191	1	171	172
Parcel 192	1	171	172
Parcel 193	1	171	172
Parcel 194	1	171	172
Parcel 195	1	171	172
Parcel 196	1	171	172
Parcel 197	1	171	172
Parcel 198	1	171	172
Parcel 199	1	171	172
Parcel 200	1	171	172